

**SURVEY &
REMONUMENTATION**

[FILED]

APR 28 1995

COMMISSION

**LAND CORNER RECORDATION CERTIFICATE
Filing Requirement of Act 74, Mich. P.A. 1970**

Nov 16 2 06 PM '94

For corners in
Livingston
(County)

Located In: Corner Code \neq

**NANCY HAVILAND
REGISTER OF DEEDS
LIVINGSTON COUNTY, MI
48843**

- | | | |
|------------------------------------|-------------------------|------------|
| 1. Public Land Survey | T <u>2N</u> R <u>5E</u> | <u>M-9</u> |
| | T _____ R _____ | _____ |
| | T _____ R _____ | _____ |
| | T _____ R _____ | _____ |
| 2. Property Controlling In Section | S _____ T _____ R _____ | _____ |
| | S _____ T _____ R _____ | _____ |
| 3. Miscellaneous Property in Sec. | S _____ T _____ R _____ | _____ |
| | S _____ T _____ R _____ | _____ |

L.S.C.#369m

Register of Deeds Stamp & File Number

4. Lot No. _____, Recorded Plat _____
5. Private Claims _____

I, Bryan Boss, in a field survey on 10-27, 19 94, do hereby certify that under requirements of P.A. 74, Michigan P.A. of 1970, the corner points mentioned in lines 1 and 2 above were in conformance with regulations and rules therefore as required in the current manual of survey instructions of the United States Department of the Interior, Bureau of Land Management or by a decree of a Court of Law and/or that the corner points mentioned in lines 3, 4 and 5 above were in conformance with the rules of the Michigan Board of Land Surveyors or by a Decree of a Court of Law; established, re-established, monumented, re-monumented, recovered, found as expressed below:

	A	B	C	D	E	F	G	H	I	J	K	L
2	6	5	4	3	2	1						
3												
4	7	8	9	10	11	12						
5												
6	16	17	18	15	14	13						
7												
8	19	20	21	22	23	24						
9												
10	30	29	28	27	26	25						
11												
12	31	32	33	34	35	36						
13												

NOTE: Not more than 4 corners, all in the same town and range, may be recorded on this certificate.

A. Description of original monument and accessories and/or subsequent restoration:

White Oak 8" N 2 W 3.50 Links
Black Oak 11" S 81 1/2 E 99 Links
No more timber, all barren

Additional data on back.

B. Description of corner evidence found and/or method applied in restoring or reestablishing corner:

Found 1/2" inch iron rod 33.00 feet South of Northwest corner of Section 30, Brighton Township. Centerline of Challis Road is 16.0 feet North of Northeast corner of Section 25.

C. Description of monument for corner and accessories established to perpetuate locating the position of the corner:

Set 1 1/4" x 30" iron pipe raised with 1 1/4" x 6" iron pipe with a brass cap marked Livingston County Monument Corner.

- S30°E 22.94' N&T SW/S 10" Elm
- S80°W 89.42' Punchmark top center of Fire Hydrant
- N20°W 56.33' N&T Top Center Cut-off power pole
- N65°W 138.49' N&T S/S Twin 12" Cottonwood
- North 1.80' South edge of Challis Road.

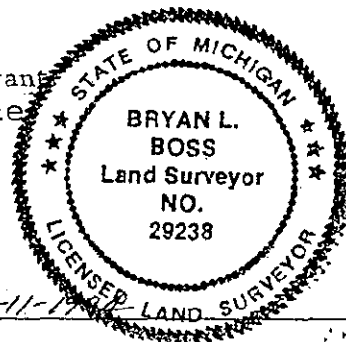

Signed by Bryan L. Boss

Date 11-11-94

Surveyor's Michigan License No. 29238

700-1071

page 1

BOSS ENGINEERING

ENGINEERS & SURVEYORS

SUMMARY M-9

NORTHEAST CORNER SECTION 25, T2N-R5E, GENOA TOWNSHIP LIVINGSTON COUNTY MICHIGAN.

Found 1/2" inch Iron Rod 33.00' feet South of Northwest Corner of Section 30, T2N-R6E, Brighton Township Centerline of Challis Road (26' feet asphalt) is 16.0 feet North of N.E. Corner Section 25.

Township Line originally Surveyed December 16, 1815. Sections were Surveyed in 1823 by S. Sibley. Township jog North to Northwest Corner of Section 30, T2N-R6E, Brighton Township recorded in field notes-Grant Dunning-page 11, this Dossier.

Measured to Witnesses found. Found 1 of 4 Munsell & Garlock Witnesses and it checked, pages 15 and 13 this Dossier. Found 3 of 5 Garlock Witnesses pages 18 and 15, they checked. Found 4 of 4 Herbert Munzel Witnesses page 20, and they checked. Found 3 of 4 Brad Thompson Witnesses and they checked.

Distance from the Northeast Corner of Section 25 to the North 1/4 Corner is 2684.21' feet Munsell & Garlock Field Notes page 12 this Dossier; 2684.47' feet Lyle W. Munsell Survey page 14; 2684.10' feet Munsell & Garlock Survey, page 18 this Dossier; 2684.72' feet page 21 and 2684.10' feet page 22, Boss Engineering Surveys.

Distance from the Northeast Corner of said Section 25 to the East 1/4 Corner of Section 24 is 2601.55' feet M.D.O.T. Right of Way Map page 23 of this Dossier; 2600.14' feet Brad Thompson Survey page 25 this Dossier.

Water retention area North of Challis Road created by commercial development in Northeast Quadrant. Sanitary sewer lift station construction destroyed majority of old Witnesses in Southwest Quadrant.

We predict that road widening and further construction in road Right of Way will destroy all evidence of both Section Corners.

Conclusion: Recommend additional Witnesses outside construction area and reset Both Corners after construction has been completed.

Area is open for G.P.S..

file:summl1

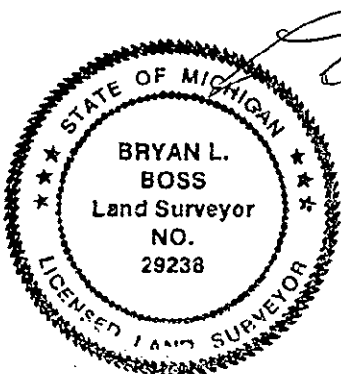

Boss Engineering Company • 3121 East Grand River • Howell Michigan 48843
Phone (517) 546-4836 • Brighton (313) 229-4773 • Fax (517) 548-1670