

DEC 29 11 24 AM '93

LAND CORNER RECORDATION CERTIFICATE
Filing Requirement of Act 74, Mich. P.A. 1970

NANCY HAVILAND
REGISTER OF DEEDS
LIVINGSTON COUNTY, MI
48843

For corners in

Livingston
(County)

Located In

Corner Code #/

1. Public Land Survey	T	2N	R	5E	M-12
	T		R		
	T		R		
	T		R		
2. Property Controlling in Section	S		T	R	
	S		T	R	
3. Miscellaneous Property in Sec.	S		T	R	
	S		T	R	

L.S.C. #164m

Register of Deeds Stamp & File Number

4. Lot No. _____ Recorded Plat _____
5. Private Claims _____

	A	B	C	D	E	F	G	H	I	J	K	L	M
2	6		5		4		3		2				
3													
4	7		8		9		10		11		12		
5													
6	18		17		16		15		14		13		
7													
8	19		20		21		22		23		24		
9													
10	30		29		28		27		26		25		
11													
12	31		32		33		34		35		36		
13													

Bryan Boss in a field survey on December 22, 1993

do hereby certify that under requirements of P.A. 74, Michigan P.A. of 1970, the corner points mentioned in lines 1 and 2 above were in conformance with regulations and rules therefore as required in the current manual of survey instructions of the United States Department of the Interior, Bureau of Land Management or by a decree of a Court of Law and/or that the corner points mentioned in lines 3, 4 and 5 above were in conformance with the rules of the Michigan Board of Land Surveyors or by a Decree of a Court of Law established, re-established, monumented, re-monumented, recovered, found as expressed below:

NOTE: Not more than 4 corners, all in the same town and range, may be recorded on this certificate.

A. Description of original monument and accessories and/or subsequent restoration:

- E. Oak 15 in. Dia. S3E 29 Lks.
- W. Oak 18 in. Dia. N23E 48 Lks.

SUBJECT
RECORD
1993
COMMISSION

B. Description of corner evidence found and/or method applied in restoring or reestablishing corner:

Found 4" x 36" Concrete Monument in N & S Fence

C. Description of monument for corner and accessories established to perpetuate locating the position of the corner:

Set 1 1/4" x 36" Iron Pipe with Brass Cap
(Livingston Co. Monument Corner)

- South 5.18' Spike E/Side 12" Oak
- N67°E 29.41' Spike SE/Side 36" Oak
- N38°E 30.22' Spike E/Side 18" Oak
- S2°W 7.96' 1" Steel Pin in 1.5 x 1.5 Concrete Pad. (W 1/4 Cbr. Sec. 31-T2N-R6E)

Approved by Livingston Co. Monumentation Peer Group on November 6, 1993

Signed by _____
Surveyor's Michigan License No. 29238

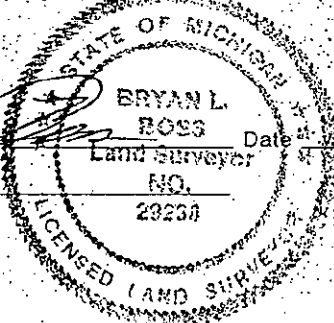

December 28, 1993

BOSS ENGINEERING ENGINEERS & SURVEYORS

November 5, 1993

SUMMARY

M-12 East Corner, Section 36, Genoa Township,
Livingston County, Michigan

Found 4" Diameter x 36" Concrete monument set by Arvin Butterfield LS 21561 on 8/28/86. This corner was set at the midpoint distance between N.E. and S.E. corners of Section 36 and on a line extended between S.E. corner of Section 36 and the West 1/4 corner of Section 31, Brighton Township. Also found 1" diameter pin in 1 1/2 foot square concrete similar to S.E. corner of Section 36, Genoa Township. Measured Southerly 7.96 evidence to West 1/4 corner Section 31, Brighton Township.

Boss surveys 90441A & 90449-B 1991.

1991 surveys found same corners and witnesses checked.

Clay Gordons "Howells Brighton Beach" Plat recorded in 1927 checked within 0.13 (see L.S.C. #1355).

file: M-12

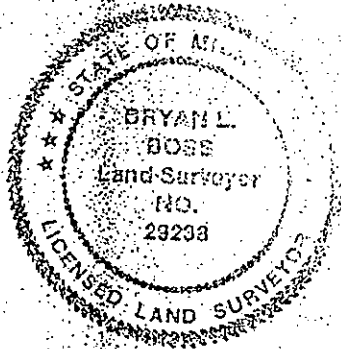

Bryan L. Boss