

DEC 29 11 24 AM '93

LAND CORNER RECORDATION CERTIFICATE
Filing Requirement of Act 74, Mich. P.A. 1970

NANCY HAVILAND
REGISTER OF DEEDS
LIVINGSTON COUNTY, MI
48843

For corners in

Livingston (County) Located In: Corner Code # M-13

1. Public Land Survey T 2N R 5E _____
 T _____ R _____
 T _____ R _____
 T _____ R _____

2. Property Controlling S _____ T _____ R _____
 in Section S _____ T _____ R _____

3. Miscellaneous S _____ T _____ R _____
 Property in Sec. S _____ T _____ R _____

L.S.C. #163m
Register of Deeds Stamp & File Number

4. Lot No. _____, Recorded Plat _____
5. Private Claims _____

I, Bryan Boss, in a field survey on December 22, 19 93,
 do hereby certify that under requirements of P.A. 74, Michigan P.A. of 1970, the corner points mentioned
 in lines 1 and 2 above were in conformance with regulations and rules therefore as required in the
 current manual of survey instructions of the United States Department of the Interior, Bureau of Land
 Management or by a decree of a Court of Law and/or that the corner points mentioned in lines 3, 4 and 5
 above were in conformance with the rules of the Michigan Board of Land Surveyors or by a Decree of a
 Court of Law; established, re-established, monumented, re-monumented, recovered, found as
 expressed below:

NOTE: Not more than 4 corners, all in the same town and range, may be recorded on this certificate.

A. Description of original monument and accessories and/or subsequent restoration:

- B. Oak 8 in. Dia. S27W 25 Lks.
- B. Oak 8 in. Dia. N12E 19 Lks.

	A	B	C	D	E	F	G	H	I	J	K	L	M
2	6		5		4		3		2		1		
3													
4	7		8		9		10		11		12		
5													
6	18		17		16		15		14		13		
7													
8	19		20		21		22		23		24		
9													
10	30		29		28		27		26		25		
11													
12	31		32		33		34		35		36		
13													

SURVEY &
 MONUMENTATION
 1993
 COMMISSION

B. Description of corner evidence found and/or method applied in restoring or reestablishing corner:

Found 1" Pipe in 24" Square Concrete Pad
 This is a Common Corner for 4 Townships

C. Description of monument for corner and accessories established to perpetuate locating the position of the corner:

Set Brass Cap Marked: Livingston Co.
 Mon. Corner in Existing Pipe Encased in
 2' Square Concrete

- N5°W 34.70' Spike E/Side 16" Oak
- West 5.54' Spike S/Side 16" Oak
- East 2.92' Spike S/Side 10" Oak
- East 26.37' Spike S/Side 18" Oak

Approved by Livingston Co.
 Monumentation Peer Group
 on November 6, 1993

Signed by [Signature] Date December 28, 1993
 Surveyor's Michigan License No. 29238

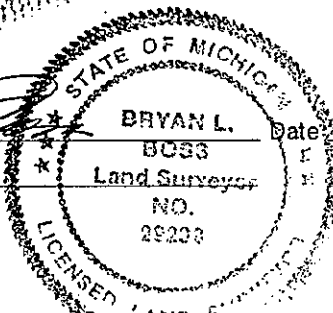

BOSS ENGINEERING
ENGINEERS & SURVEYORS

November 5, 1993

SUMMARY

M-13 SE Corner, Section 36, Genoa Township,
Livingston County, Michigan

Found 1" Diameter capped pipe in 24" square concrete

1928 Survey by R.E. Long in Section 6, Green Oak Township
used same 24" square cement base

1973 George Young used for A-13.

1973 Richard Miller used for A-13.

1986 Arvin Butterfield noted this is a common corner for 4
townships.

1929 Plat of "Howell's Brighton Beach Subdivision No. 1"
shows common corner.

file: M-13

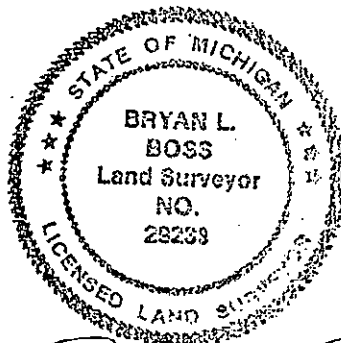

Bryan L. Boss