

**SURVEY & REMONUMENTATION**

FEB 24 1998

9-

**SECTION**

**LAND CORNER RECORDATION CERTIFICATE**  
Filing Requirement of Act 74, Mich. P.A. 1970

**FILED**

For corners in

<u>LIVINGSTON</u> <small>(County)</small>	Located In: BRIGHTON TWP.	Corner Code $\neq$ # B-13
1. Public Land Survey	T <u>2N</u> R <u>6E</u>	_____
	T _____ R _____	_____
	T _____ R _____	_____
	T _____ R _____	_____
2. Property Controlling in Section	S _____ T _____ R _____	_____
	S _____ T _____ R _____	_____
3. Miscellaneous Property in Sec.	S _____ T _____ R _____	_____
	S _____ T _____ R _____	_____
4. Lot No. _____, Recorded Plat _____		
5. Private Claims _____		

1997 NOV 25 A 11: 12

NANCY HAVILAND  
REGISTER OF DEEDS  
LIVINGSTON COUNTY, MI.  
48843

L.S.C. #827m  
Register of Deeds Stamp & File Number

I, BRYAN L. BOSS, in a field survey on SEPTEMBER 19, 19 97, do hereby certify that under requirements of P.A. 74, Michigan P.A. of 1970, the corner points mentioned in lines 1 and 2 above were in conformance with regulations and rules therefore as required in the current manual of survey instructions of the United States Department of the Interior, Bureau of Land Management or by a decree of a Court of Law and/or that the corner points mentioned in lines 3, 4 and 5 above were in conformance with the rules of the Michigan Board of Land Surveyors or by a Decree of a Court of Law; established, re-established, monumented, re-monumented, recovered, found as expressed below:

NOTE: Not more than 4 corners, all in the same town and range, may be recorded on this certificate.

	A	B	C	D	E	F	G	H	I	J	K	L	M
2	6		5		4		3		2		1		
3													
4	7		8		9		10		11		12		
5													
6	18		17		16		15		14		13		
7													
8	19		20		21		22		23		24		
9													
10	30		29		28		27		26		25		
11													
12	31		32		33		34		35		36		
13													

A. Description of original monument and accessories and/or subsequent restoration:

BLACK OAK 9" N 82 E 75 LINKS  
BLACK OAK 6" N 07 E 58 LINKS

B. Description of corner evidence found and/or method applied in restoring or reestablishing corner:

FOUND ATWELL-HICKS CAPPED 3/4" INCH PIPE.  
NO DISK SET AS PER L.S.C. #1583A DATED 9-29-92.

Description of monument for corner and accessories established to perpetuate locating the position of the corner:

SET 1 1/4" X 36" IRON PIPE WITH BRASS CAP STAMPED  
"LIVINGSTON COUNTY MONUMENTATION CORNER".  
N 10 W 105.98' MONUMENT (BENT) NORTHWEST CORNER LOT 82  
N 10 E 5.73' 1/2" IRON ROD LOT CORNER 203-204  
S 75 W 31.68' SOUTHEAST CORNER HOUSE NO. 397  
EAST 103.71' CAPPED IRON LOT CORNER 83-84  
S 50 W 86.53' MONUMENT (BENT) NORTHEAST CORNER LOT# 204

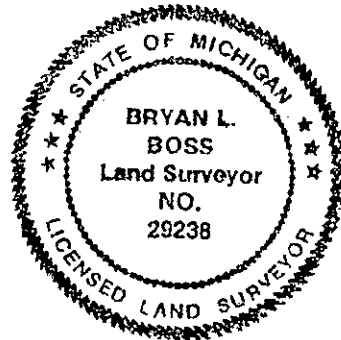

igned by Bryan L. Boss Date Sept. 26, 1997  
urveyor's Michigan License No. 29238

FORM APPROVED BY MICHIGAN STATE BOARD OF LAND SURVEYORS, JAN. 28, 1971  
REVISED MAY 14, 1975  
REVISED JAN., 1983

P.A. 345 1980, APPROVED BY LIVINGSTON COUNTY  
PEER GROUP ON 8-20-97, CO. REP JED

**SUMMARY  
B-13**

South 1/4 Corner, Section 31, Brighton Township.

This corner was originally set by Alex Holmes in 1816.

Boss Engineering found a 3/4" pipe with disk 5.7 feet Southerly of South back of sidewalk, South side of Woodlake Drive. On 9-28-1938, Clay Gordon survey recorded distances East-West & North of South 1/4 Corner. This survey was utilized by Robert G. Macomber of Atwell-Hicks to set the South 1/4 Corner. Land Survey Certificate #1583, recorded by Lawrence O'Donnell was resubmitted 8 days later on 9-29-92 as Land Survey Certificate #1583A.

It is obvious that the former Act 74 Witnessed the found North 1/4 Corner of Section 6 Green Oak Township. Instead of the set South 1/4 Corner.

On 11-12-93, & 1-31-96, Boss Engineering and Desine Inc. Engineers respectively found and accepted corner set by Atwell-Hicks. This Corner is open for G.P.S.

We recommend acceptance of 3/4" Inch pipe as found to be the South 1/4 Corner, Section 31.

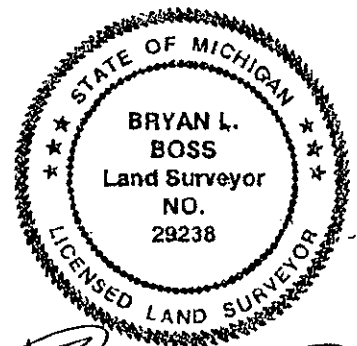

sumb-13

A handwritten signature in cursive script, appearing to read "Bryan L. Boss", written below the professional seal.

N87°37' W 115.26' N 1/4 SEC. 6 GREEN OAK TWP.

(JED)