

9-

FILED

LAND CORNER RECORDATION CERTIFICATE
Filing Requirement of Act 74, Mich. P.A. 1970

For Corners in BRIGHTON TWP.

1996 DEC -3 P 3:00K

NANCY HAVILAND
REGISTER OF DEEDS
LIVINGSTON COUNTY, MI.
48843

L.S.C.#630m

REGISTER OF DEEDS STAMP & FILE NUMBER

<u>LIVINGSTON</u> (COUNTY)	Located In	Corner Code #
1. Public Land Survey	T <u>2</u> N R <u>6</u> E	<u>C-11</u>
	T___ R___	_____
	T___ R___	_____
	T___ R___	_____
2. Property Controlling in Section	S___ T___ R___	_____
	S___ T___ R___	_____
3. Miscellaneous Property in Sec.	S___ T___ R___	_____
	S___ T___ R___	_____
4. Lot No. _____, Recorded Plat _____		
5. Private Claims _____		

	A	B	C	D	E	F	G	H	I	J	K	L	M
2	6	5	4	3	2	1							
3													
4	7	8	9	10	11	12							
5													
6	18	17	16	15	14	13							
7													
8	19	20	21	22	23	24							
9													
10	30	29	28	27	26	25							
11													
12	31	32	33	34	35	36							
13													

I, BRYAN L. BOSS in a field survey on NOVEMBER 1, 1996, do hereby certify that under requirements of P.A. 74, Michigan P.A. of 1970, the corner points mentioned in lines 1 and 2 above were in conformance with regulations and rules therefore as required in the current manual of survey instructions of the United States Department of the Interior, bureau of Land Management or by a decree of a Court of Law and/or that the corner points mentioned in lines 3, 4 and 5 above were in conformance with the rules of the Michigan Board of Land Surveyors or by a Decree of a Court of Law, established, re-established, monumented, re-monumented, recovered, found as expressed below:

NOTE: Not more than 4 corners, all in the same town and range, may be recorded on this certificate.

A. Description of original monument and accessories and/or subsequent restoration:
CORNER OF SECTIONS 29, 30, 31, 32, IN THE NORTH END OF POND.
NO POST OR BEARING TREES.

- WHITE OAK 24" N 50° W 1.40 - 1882 BULLOCK
- YELLOW OAK 24" N 85° W 235 LINKS - 1890 TELLER
- YELLOW OAK 24" N 26° E 202 LINKS - 1890 TELLER

B. Description of corner evidence found and/or applied in restoring or reestablishing corner:

FOUND 3/4" IRON PIPE AT THE NORTH EDGE OF POND.

C. Description of monument for corner and accessories established to perpetuate location the position of the corner:

SET 1 1/4 X 36" PIPE WITH BRASS CAP STAMPED "LIVINGSTON COUNTY MONUMENT CORNER"

- N 60° E NAIL & TAG NORTH SIDE 30" MAPLE 77.05'
- SOUTH 3/4" INCH IRON PIPE 33.00
- WEST NAIL & TAG NORTH SIDE 8" BOXELDER 13.14'
- N 30° W NAIL & TAG EAST SIDE UTILITY POLE 28.29'

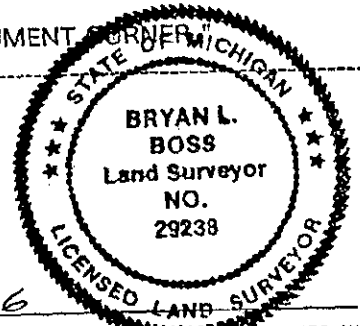

Signed by Bryan L. Boss
Surveyor's Michigan License No. 29238

Date 11-21-1996

FORM APPROVED BY MICHIGAN STATE BOARD OF LAND SURVEYORS, JAN. 28, 1975
REVISED MAY 14, 1975
REVISED JAN., 1983

P.A. 345 1990, APPROVED BY LIVINGSTON COUNTY
PEER GROUP ON 8.28.96 CO. REP JED

SUMMARY

C-11

Northwest Corner, Section 32, T2N-R6E, Brighton Township, Livingston County, Michigan.

Found 3/4" iron pipe at ground surface at the north edge of pond/swamp. No occupation or evidence of other corners present. Over hanging tree limbs will make this corner difficult for G.P.S.

Original sections measured by Sylvester Sibley in May 1823. On Sibley's field notes page 8 this dossier, this surveyor found a pond of about 40 Acres at 51.50 chains. At 80 chains, Sibley's corner is in the North end of pond, no post or bearing tree. Than in 1882, Miles Bullock witnessed Southeast corner of Section 30. This was followed by M.D.O.T. witnesses in 1952. Washtenaw Engineering survey 1972 (page 17-18) has one common witness to M.D.O.T. and subsequent surveys .

Plat of "Brighton CC" 1927 shows this Corner and a distance of 2574 (C-11 to C-12) and a distance of 2682.5 (C-11 to D-11). "Brighton CC Annex" 1948 show same distances and a point set 33 feet South. M.D.O.T. survey (page 13B this dossier) prepared approx. 1959 shows distance C-11 to C-12 as 2574.68 feet.

On October 17, 1961, Lyle Munsell denotes Northeast corner Section 31, with a found iron 33 feet South. Boss Survey 1973 (page 19), found 3/4" pipe at C-11 with a 3/4 " Pipe 33 feet South and the platted distance of 2403.49 from C-11 south to Grand River was measured as 2402.05 feet . Atwell-Hicks 1994 survey (page 20-21) measure within 2' of platted distance C-11 to C-12 and matches survey by Boss 1973. Washtenaw Engineering.

On April 5, 1996, Paul Kurtz of Boss Engineering witnesses Northeast corner and also finds 3/4" iron pipe South 32.97 feet.

We therefore conclude that all surveys to North, South, East, and West, refer to the same location as monumented. We recommend approval of corner as found.

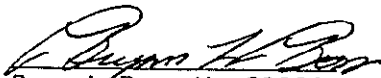
Bryan L. Boss No. 29238

