

MAR 17 2000

FILED

SECTION

LAND CORNER RECORDATION CERTIFICATE

Filing Requirement of Act 74, Mich. P.A. 1970 1999 NOV 22 A 11:08

For corners in LIVINGSTON (County)

Located in: BRIGHTON Corner Code #

9

NANCY HAVILAND REGISTER OF DEEDS LIVINGSTON COUNTY, MI. 48843

Table with 4 columns: Item, Town/Range, Section, and Corner Code #. Row 1: Public Land Survey, T 2N R 6E, D-9. Row 2: Property Controlling in Section, S T R. Row 3: Miscellaneous Property in Sec., S T R.

LSC# 1109m Register of Deeds Stamp and File Number

- 4. Lot No. , Recorded Plat
5. Private Claims

I, Bryan L. Boss, in a field survey on 10-19-99 do hereby certify that under requirements of P.A. 74, Michigan P.A. of 1970, the corner points mentioned in lines 1 and 2 above were in conformance with regulations and rules therefor as required in the current manual of survey instructions of the United States Department of the Interior, Bureau of Land Management or by a decree of a Court of Law and/or that the corner points mentioned in lines 3,4 and 5 above were in conformance with the rules of the Michigan Board of Land Surveyors or by a Decree of a Court of Law; established, re-established, monumented, re-monumented, recovered, found as expressed below.

NOTE: Not more than 4 corners, all in the same town and range, may be recorded on this certificate.

Grid table with columns A-M and rows 2-13. Cell (9, D) contains a black dot representing a corner point.

A. Description of original monument and accessories and/or subsequent restoration:

SET POST
W.OAK 14" S 84 1/2" W 1.50 CHAINS
B.OAK 6" S 23" W 3.11 CHAINS

B. Description of corner evidence found and/or method applied in restoring or reestablishing corner:

FOUND CONCRETE MONUMENT WITH 1/2" PIPE

C. Description of monument for corner and accessories established to perpetuate locating the position of the corner:

SET BRASS CAP STAMPED "LIVINGSTON COUNTY REMONUMENTATION CORNER" ON TOP OF EXISTING CONCRETE MONUMENT
S 40° W 105.27' REMON NAIL & TAG SE/S 12" MAPLE
S 80° W 63.69' REMON NAIL & TAG N/S 15" CHERRY
N 80° W 53.77' REMON NAIL & TAG N/S TWIN 12" MAPLE
N 45° W 35.26' REMON NAIL & TAG S/S TWIN 12" MAPLE

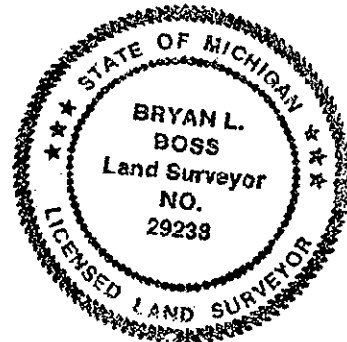

P.A. 345 1990, APPROVED BY LIVINGSTON COUNTY

GROUP ON 7-21-99, CO. REP JED

Signed by [Signature]

Date NOV. 9, 1999

Surveyor's Michigan License No. 29238