

9-

FILED

LAND CORNER RECORDATION CERTIFICATE
Filing Requirement of Act 74, Mich. P.A. 1970

For Corners In BRIGHTON TWP.

1996 DEC -3 P 3:00 R

NANCY HAVILAND
REGISTER OF DEEDS
LIVINGSTON COUNTY, MI.
48843

L.S.C.#626m

REGISTER OF DEEDS STAMP & FILE NUMBER

LIVINGSTON
(COUNTY)

Located In

Corner Code #

1. Public Land Survey

T2N R6E

E-12

T___ R___

T___ R___

T___ R___

2. Property Controlling
in Section

S___ T___ R___

S___ T___ R___

3. Miscellaneous
Property in Sec.

S___ T___ R___

S___ T___ R___

4. Lot No. _____, Recorded Plat _____

5. Private Claims _____

	A	B	C	D	E	F	G	H	I	J	K	L	M
2	6	5	4	3	2	1							
3													
4	7	8	9	10	11	12							
5													
6	18	17	16	15	14	13							
7													
8	19	20	21	22	23	24							
9													
10	30	29	28	27	26	25							
11													
12	31	32	33	34	35	36							
13													

I, BRYAN L. BOSS in a field survey on OCTOBER 30, 1996, do hereby certify that under requirements of P.A. 74, Michigan P.A. of 1970, the corner points mentioned in lines 1 and 2 above were in conformance with regulations and rules therefore as required in the current manual of survey instructions of the United States Department of the Interior, bureau of Land Management or by a decree of a Court of Law and/or that the corner points mentioned in lines 3, 4 and 5 above were in conformance with the rules of the Michigan Board of Land Surveyors or by a Decree of a Court of Law, established, re-established, monumented, re-monumented, recovered, found as expressed below:

NOTE: Not more than 4 corners, all in the same town and range, may be recorded on this certificate.

A. Description of original monument and accessories and/or subsequent restoration:

- BLACK OAK 8" S 8½° E 3.13
- BLACK OAK 10" N 40° W 1.26 - 1880 BULLOCK
- WHITE OAK 30" N 08° W 97 LINKS - 1886 TELLER
- WHITE OAK 20" S 54½° W 106 LINKS IRON AND BRICK
- RED OAK 14" N 02° E 46½ LINKS - 1886 TELLER

B. Description of corner evidence found and/or applied in restoring or reestablishing corner:

FOUND 1" INCH PIPE ½ FOOT BELOW SURFACE OF OLD EAST AND WEST ROAD BED.

C. Description of monument for corner and accessories established to perpetuate location the position of the corner:

SET 1 ¼ X 36" IRON PIPE WITH BRASS CAP STAMPED "LIVINGSTON COUNTY MONUMENT CORNER"

N 45° E NAIL & TAG SOUTH SIDE 24" ELM 28.91'

S 40° E NAIL & TAG SOUTHWEST SIDE 12" ELM 45.55'

S 80° W NAIL & TAG NORTH SIDE 20" TRIPLE BOXELDER 40.92'

N 15° W NAIL & TAG WEST SIDE 24" LOCUST 23.67'

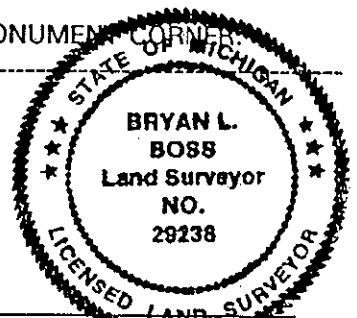

Signed by Bryan L. Boss
Surveyor's Michigan License No. 29238

Date 11-21-1996

FORM APPROVED BY MICHIGAN STATE BOARD OF LAND SURVEYORS, JAN. 28, 1971

REVISED MAY 14, 1975
REVISED JAN., 1983

PA. 345 1990, APPROVED BY LIVINGSTON COUNTY
PEER GROUP ON 7-17-96, CO. REP JED

05112

SUMMARY

E-12

West ¼ Corner, Section 33, T2N-R6E, Brighton Township, Livingston County, Michigan

Found 1" Iron Pipe ½' below surface of old East & West Road bed. No occupation found North or South. This corner is between the eastbound & westbound lanes of I-96 and northbound U.S. 23 ramp at interchange. The original corner was set on April 28, 1823, by Sylvester Sibley. Witnesses were subsequently set in 1885-1886 by Miles Bullock and J. Teller. Number 3 Witness on page 7, this dossier was recorded in 1960 by M.D.O.T. and still found and checked by Boss Engineering on April 5, 1996. The distance Easterly to the East ¼ Corner Section 33 measured between 5378.6' and 5379.50' by four survey companies. The Area is heavily wooded and will be a difficult G.P.S. corner, also made sweep for additional monuments and found none.

Considering all witnesses found either a 3/4" or 1" pipe, and measured distances easterly to the East ¼ Corner of Section 33 were consistent, we recommend approval of corner as found.

Bryan L. Boss No. 29238

