

LAND CORNER RECORDATION CERTIFICATE
Filing Requirement of Act 74, Mich. P.A. 1970

9-

FILED

1996 DEC 19 A 11:27

NANCY HAVILAND
 REGISTER OF DEEDS
 LIVINGSTON COUNTY, MI.
 48843

L.S.C. #635m

REGISTER OF DEEDS STAMP & FILE NUMBER

	A	B	C	D	E	F	G	H	I	J	K	L	M
2	6	5	4	3	2	1							
3													
4	7	8	9	10	11	12							
5													
6	18	17	16	15	14	13							
7													
8	19	20	21	22	23	24							
9													
10	30	29	28	27	26	25							
11													
12	31	32	33	34	35	36							
13													

For Corners in BRIGHTON TWP.

<u>LIVINGSTON</u> (COUNTY)	Located In	Corner Code #
1. Public Land Survey	T2N R6E	E-13
	T__ R__	_____
	T__ R__	_____
	T__ R__	_____
2. Property Controlling in Section	S__ T__ R__	_____
	S__ T__ R__	_____
3. Miscellaneous Property in Sec.	S__ T__ R__	_____
	S__ T__ R__	_____

4. Lot No. _____, Recorded Plat _____
 5. Private Claims _____

I, BRYAN L. BOSS in a field survey on DECEMBER 17, 1996, do hereby certify that under requirements of P.A. 74, Michigan P.A. of 1970, the corner points mentioned in lines 1 and 2 above were in conformance with regulations and rules therefore as required in the current manual of survey instructions of the United States Department of the Interior, bureau of Land Management or by a decree of a Court of Law and/or that the corner points mentioned in lines 3, 4 and 5 above were in conformance with the rules of the Michigan Board of Land Surveyors or by a Decree of a Court of Law, established, re-established, monumented, re-monumented, recovered, found as expressed below:

NOTE: Not more than 4 corners, all in the same town and range, may be recorded on this certificate.

A. Description of original monument and accessories and/or subsequent restoration:

CORNER IN FONDA LAKE
 SYCAMORE 14" S 86 1/2° E 3.82 CHAINS
 WEST TO SHORE OF LAKE 17.57 CHAINS
 EAST TO SHORE OF LAKE 3.43 CHAINS

B. Description of corner evidence found and/or applied in restoring or reestablishing corner:

SET WITNESS MONUMENT 1 FOOT WEST OF THE SOUTHWEST CORNER LOT 11 "GRAND RIVER LAKES COLONY" SUBDIVISION, WITNESS IS 227.00 FEET EAST OF THE SOUTHWEST CORNER, SECTION 33, ON THE SOUTH LINE OF SAID SECTION.

SET WITNESS MONUMENT AT THE NORTHEAST CORNER OF LOT 141, "GRAND RIVER LAKES COLONY NO. 2", WHICH IS 1816.69 FEET WEST OF SECTION CORNER E-13.

C. Description of monument for corner and accessories established to perpetuate location the position of the corner:

SET 1 1/4" X 36" PIPE WITH BRASS CAP STAMPED "LIVINGSTON COUNTY REMON WITNESS"
 N 20° E NAIL & TAG EAST SIDE 10" TWIN STUMP 40.30'
 EAST NAIL & TAG NORTH SIDE 3" TREE 10.54'
 S 80° E NAIL & TAG SOUTH SIDE 42" OAK 28.24'
 S 10° E NAIL & TAG WEST SIDE 10" TREE 50.55'

SET 1 1/4" X 36" PIPE WITH BRASS CAP STAMPED "LIVINGSTON COUNTY REMON WITNESS"
 NORTH NAIL & TAG EAST SIDE 6" MAPLE 74.91'
 N 88° W NAIL & TAG NORTH SIDE 30" OAK 35.24'
 S 65° W NAIL & TAG NORTH SIDE 28" TREE 75.68'
 S 05° E NORTHEAST CORNER STEEL RETAINING WALL 114.62'

P.A. 345 1990, APPROVED BY LIVINGSTON COUNTY
 PEER GROUP ON 9-18-96 CO. REP JEO

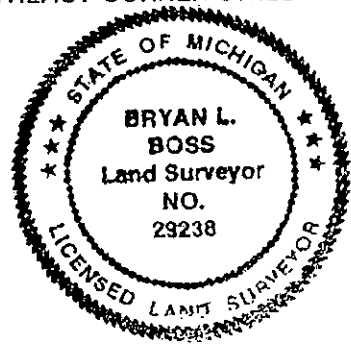

Signed by Bryan L. Boss Date 12-17-1996
 Surveyor's Michigan License No. 29238

SUMMARY E-13

Southwest corner, Section 33, T2N-R6E, Brighton Township, Livingston County, Michigan.

CORNER EVIDENCE

Corner is in Fonda Lake.

Page 7 of this dossier notes surveyed in 1816 by Alex Holmes, Deputy Surveyor, and on the 4th mile West along the Township line at 76 chains a lake. At 80 chains comes in Lake to Sections 32 & 33.

Page 7 this dossier notes North between Sections 32 & 33, from corner in pond as by traverse. At 11.50 chains to the margin North shore.

Surveyor Teller's 1886 field notes on page 10 calls for Southeast corner of Section 32 in Lake 3.43 chains (226.38 feet) West of East shore of Lake.

G.P.S. corner only when Lake is frozen.

DISTANCES

In 1920, "Grand River Lakes Colony Subdivision"(pages 12-14) was platted and a called distance from the Southwest corner of Section 33 to the Easterly shore line of Fonda Lake of 328.00 feet. This distance is approx. 100' West of GLO distance, (note possible schribner's error of 100 feet : 328' should be 228').

March 18,1982 survey by Boss Eng. shows the SW Cor. Sec. 33. A Nail was set on the ice by projecting the South Line of this plat Westerly, 328.00 feet from the SW Corner of Lot 11.This nail was N87-35-52E, 2543.49 feet from "D-13"(S 1/4 Cor. Sec. 33)(approx. 100 feet short of GLO) and was 5382.4 feet from G-13(SE Cor., Sec. 33)(approx. 100" longer than GLO)

The NE Cor. of Lot 141 of "Grand River Lakes Colony No. 2"(page 15) is a 1" pipe near the Westerly shore of Fonda Lake, and is N87-31-58E, 826.80 feet (recorded as 827.10) from "D-13". This NE Cor of Lot 141 is 0.96 feet North of the Section Line.

RECOMMENDATION

We therefore recommend establishing Section Corner E-13 at a point 228 feet West of the SW Cor of Lot 11 of "Grand River Lakes Colony". This location acknowledges that a schrieblers error was made in the plat of "Grand River Lakes Colony".

Two reference monuments will be set as follows:

- 1) witness monument 1 foot West of the Southwest corner of Lot 11, which is 227.00 feet East of Southwest corner, Section 33, on the South line of said Section; and
- 2) witness monument at the Northeast corner of Lot 141, "G.R. Lakes Colony No. 2" which is 2643.49 - 826.80 = 1816.69 feet West of said Section corner E-13.

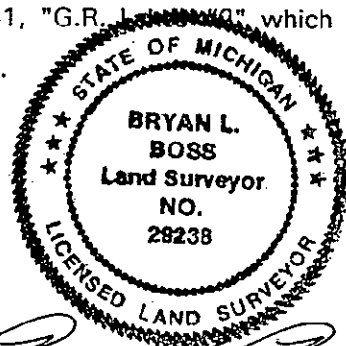

Bryan L. Boss
Bryan L. Boss No. 29238