

OCT 26 1995

COMMISSION

LAND CORNER RECORDATION CERTIFICATE  
Filing Requirement of Act 74, Mich. P.A. 1970

9-  
FILED  
NANCY HAVILAND  
REGISTER OF DEEDS  
LIVINGSTON COUNTY, MI  
48843

OCT 11 9 19 PM '95

For corners in

<u>Livingston</u> <small>(County)</small>	Located In:	Corner Code <u>≠#</u>
1. Public Land Survey	T <u>2N</u> R <u>6E</u>	<u>G-7</u>
	T _____ R _____	_____
	T _____ R _____	_____
	T _____ R _____	_____
2. Property Controlling in Section	S _____ T _____ R _____	_____
	S _____ T _____ R _____	_____
3. Miscellaneous Property in Sec.	S _____ T _____ R _____	_____
	S _____ T _____ R _____	_____
4. Lot No. _____, Recorded Plat _____		
5. Private Claims _____		

L.S.C. #440m

Register of Deeds Stamp & File Number

I, Bryan Boss, in a field survey on 8-23, 19 95, do hereby certify that under requirements of P.A. 74, Michigan P.A. of 1970, the corner points mentioned in lines 1 and 2 above were in conformance with regulations and rules therefore as required in the current manual of survey instructions of the United States Department of the Interior, Bureau of Land Management or by a decree of a Court of Law and/or that the corner points mentioned in lines 3, 4 and 5 above were in conformance with the rules of the Michigan Board of Land Surveyors or by a Decree of a Court of Law; established, re-established, monumented, re-monumented, recovered, found as expressed below:

NOTE: Not more than 4 corners, all in the same town and range, may be recorded on this certificate.

A	B	C	D	E	F	G	H	I	J	K	L	M
2	6	5	4	3	2	1						
3												
4	7	8	9	10	11	12						
5												
6	18	17	16	15	14	13						
7												
8	19	20	21	22	23	24						
9												
10	30	29	28	27	26	25						
11												
12	31	32	33	34	35	36						
13												

A. Description of original monument and accessories and/or subsequent restoration:

- Black Oak 14" S 10 E 30 links
- Black Oak 12" N 46 W 90 links
- Yellow Oak 20" S 15 E 52
- Yellow Oak 12" N 51 W 59
- Set post corner to Sections 15, 16, 21 & 22

B. Description of corner evidence found and/or method applied in restoring or reestablishing corner:

- P.K. nail found 0.9 feet East of Centerline Van Amberg Road
- S 30° E 46.80' nail & tag Southwest side 6" Pine
- N 35° E 32.94' center sign post
- S 45° W 72.50' nail found Southwest side 12" Oak
- S 55° W 69.35 nail Northwest side 12" Oak
- S 40° E 2.80 center empty monument box.

C. Description of monument for corner and accessories established to perpetuate locating the position of the corner:

- Set brass cap on 1/2" iron in monument box
- 102.82' N 10° E nail & tag West side 26" Oak
- 46.82' S 45° E nail & tag Southwest side 8" Pine
- 72.53' S 10° W nail & tag East side 12" Oak
- 69.36' S 45° W nail & tag Northwest side 18" Oak
- 133.57' N 5° W nail & tag East side 30" Maple

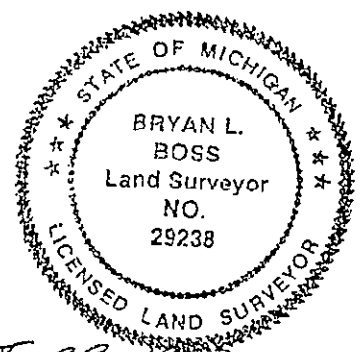

Signed by Bryan L. Boss Date Sept. 28, 1995  
 Surveyor's Michigan License No. 29238

AP. JUNE D  
3-15-95

SUMMARY

G-7

Northwest Corner, Section 22, T2N-R6E, Brighton Township, Livingston County, Michigan.

Found multiple corner at intersection of Van Amberg Road and Seitz Road. Good for GPS.

One May 18, 1972, Charles Wilson found a 3/4" iron rod 11.55 feet North and 2.10 feet West of a spike (see pages 12 & 13). In 1974 Donald Ross found same witnesses and iron. On 1-18-78 David Finney witnesses found 1/2" iron 0.3 feet and 0.4 feet difference from same witness points. In February 1988, Tri-County Survey found 3/8" iron and 36" maple in S.E. Quadrant is short by 10.66 feet. Also the 12" Oak in S.W. Quadrant is 3.77 feet short of previous witnesses.

On 10-10-88, Tri-County set P.K. & Cap from David Finney survey and now the 10" Oak in the S.W. Quadrant is 7.32 feet longer than in February of same year. Also the 36" Maple in S.E. Quadrant is 10.46 feet longer. On 2-8-89, Patrick O'Rourke found a monument box with same witnesses as David Finney.

on 5-21-90, Matthew Brady found 1/2" iron with same witness points as Patrick O'Rourke. On 11-10-92, Boss Engineering found a P. K. Nail 0.9 feet East of centerline and empty monument box 2.80 feet S40°E.

On 3/14/95 Charles Garlock informed Boss Engineering that a survey he has in progress of a portion of the O'Rourke survey (page 24) agrees with the P.K. Nail as witnessed on 11/10/92 Boss Engineering survey (see pages 27 & 28). This P.K. nail agrees with Wilson (pages 12 & 13), Don Ross (pages 14 & 15), Boss Engineering (pages 27 & 28) and Tri-County (pages 21 & 22).

The distances Easterly to the North 1/4 corner of Section 22 were recorded at 2626.18 feet by Finney, O'Rourke and Brady. The distances Northerly to the West 1/4 Corner of Section 15 were consistent with a difference of 0.46 feet by Newton, Tri-County and Ross.

Conclusion: We recommend removing existing Monument Box and replacing at location of P.K. nail..

BRIG-7S

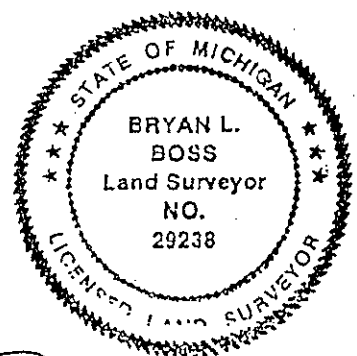

*Bryan L. Boss*