

OCT 26 1995

9-

COMMISSION

LAND CORNER RECORDATION CERTIFICATE
Filing Requirement of Act 74, Mich. P.A. 1970

For corners in

<u>Livingston</u> (County)	Located In:	Corner Code #/
1. Public Land Survey	T <u>2N</u> R <u>6E</u>	<u>G-8</u>
	T _____ R _____	_____
	T _____ R _____	_____
	T _____ R _____	_____
2. Property Controlling in Section	S _____ T _____ R _____	_____
	S _____ T _____ R _____	_____
3. Miscellaneous Property in Sec.	S _____ T _____ R _____	_____
	S _____ T _____ R _____	_____

FILED
 OCT 4 3 18 PM '95
 NANCY HAVILAND
 REGISTER OF DEEDS
 LIVINGSTON COUNTY, MI
 48843
 L.S.C. #441m
 Register of Deeds Stamp & File Number

4. Lot No. _____, Recorded Plat _____
 5. Private Claims _____

	A	B	C	D	E	F	G	H	I	J	K	L	M
2	6	5	4	3	2	1							
3													
4	7	8	9	10	11	12							
5													
6	18	17	16	15	14	13							
7													
8	19	20	21	22	23	24							
9													
10	30	29	28	27	26	25							
11													
12	31	32	33	34	35	36							
13													

I, Bryan Boss, in a field survey on 9-6, 19 95, do hereby certify that under requirements of P.A. 74, Michigan P.A. of 1970, the corner points mentioned in lines 1 and 2 above were in conformance with regulations and rules therefore as required in the current manual of survey instructions of the United States Department of the Interior, Bureau of Land Management or by a decree of a Court of Law and/or that the corner points mentioned in lines 3, 4 and 5 above were in conformance with the rules of the Michigan Board of Land Surveyors or by a Decree of a Court of Law; established, re-established, monumented, re-monumented, recovered, found as expressed below:

NOTE: Not more than 4 corners, all in the same town and range, may be recorded on this certificate.

A. Description of original monument and accessories and/or subsequent restoration:

Black Oak 10" S 35 E 112 links
 Black Oak 6" S 88 W 66 links
 set half mile post

B. Description of corner evidence found and/or method applied in restoring or reestablishing corner:

1/2" iron found in monument box 4 feet East of centerline Van Amberg Road.
 N 50° W 64.40' 10" Locust
 N 30° E 41.70' Centerline Michigan Bell Pedestal
 S 20° E 22.60' 3" Locust
 West 36.65' power pole

C. Description of monument for corner and accessories established to perpetuate locating the position of the corner:

Set brass cap on 1/2" iron in monument box
 154.80' N 15° W nail & tag East side 28" Oak
 40.91' N 30° E face Michigan Bell Phone Box
 29.98' S 20° E face Michigan Bell Phone Pedestal
 126.48' S 25° W nail & tag East side 6" Quad Maple
 36.52' West nail & tag North side power pole

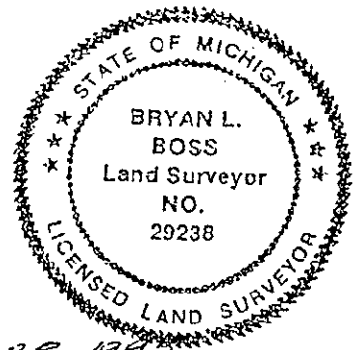

Signed by Bryan L. Boss Date Sept. 28, 1995
 Surveyor's Michigan License No. 29238

SUMMARY

G-8

West 1/4 Corner, Section 22, T2N-R6E, Brighton Township, Livingston County, Michigan.

Found 1/2" iron rod in monument box 4 feet ± East of centerline of Van Amberg Road. No evidence of a multiple corner and this area is wide open for G.P.S.

On March 20, 1995, Boss Engineering traversed from G-6, to G-7 to G-8, to G-9, to G-10, and to H-9. See pages 33, 34, and 35. Found 4 of 6 witnesses on I-12-95.

Results of recommended tabled corner by Peer Group on 3-15-95 are as noted on Pages 33, 34 and 35.

Conclusion: We therefore recommend replacement of iron in monument box 0.19 feet West of present location.

BRIG-8S

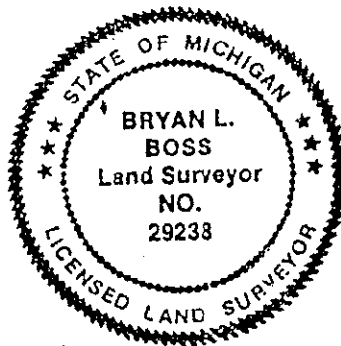

Bryan L. Boss