

FEB 25 1999

FILED

9-

SECTION

LAND CORNER RECORDATION CERTIFICATE

Filing Requirement of Act 74, Mich. P.A. 1970 1998 OCT 27 P 2: 23

For corners in

Livingston
(County)

Located In:

Corner Code //

NANCY HAVILAND
REGISTER OF DEEDS
LIVINGSTON COUNTY, MI.
48843

- 1. Public Land Survey T 2N R 6E T-3
- T R
- T R
- T R
- 2. Property Controlling S T R
- in Section S T R
- 3. Miscellaneous S T R
- Property in Sec. S T R

LSC981M

Register of Deeds Stamp & File Number

- 4. Lot No. _____, Recorded Plat _____
- 5. Private Claims _____

	A	B	C	D	E	F	G	H	I	J	K	L	M
2	6	5	4	3	2	1							
3													
4	7	8	9	10	11	12							
5													
6	18	17	16	15	14	13							
7													
8	19	20	21	22	23	24							
9													
10	30	29	28	27	26	25							
11													
12	31	32	33	34	35	36							
13													

I, Bryan L. Boss, in a field survey on Oct. 7, 19 98, do hereby certify that under requirements of P.A. 74, Michigan P.A. of 1970, the corner points mentioned in lines 1 and 2 above were in conformance with regulations and rules therefore as required in the current manual of survey instructions of the United States Department of the Interior, Bureau of Land Management or by a decree of a Court of Law and/or that the corner points mentioned in lines 3, 4 and 5 above were in conformance with the rules of the Michigan Board of Land Surveyors or by a Decree of a Court of Law, established, re-established, monumented, re-monumented, recovered, found as expressed below:

NOTE: Not more than 4 corners, all in the same town and range, may be recorded on this certificate.

A. Description of original monument and accessories and/or subsequent restoration:

Set post 1823
 Black Oak 16" N 7½ E 22 L
 Black Oak 10" S 21 W 38 L

B. Description of corner evidence found and/or method applied in restoring or reestablishing corner:

Found capped iron # 24607/ # 10057
 at fence intersection new fence to East older fence S/W

P.A. 345 1990, APPROVED BY LIVINGSTON COUNTY
 PEER GROUP ON 9-2-98 CO. REP JED

C. Description of monument for corner and accessories established to perpetuate locating the position of the corner:

Set 1½" iron pipe & Brass cap Stamped "Livingston County Monumentation Corner"
 South 9.14' set Remon N/T in top of conc. post
 S 80 E 19.82 set Remon N/T in N/S 8" Oak
 N 5 W 32 .20' set Remon N/T in E/S 30" Elm
 N 75 W 32.46 set Remon N/T in N/S 4" Maple
 North 10.1' center 4" steel post
 West 13.9' center 4" steel post

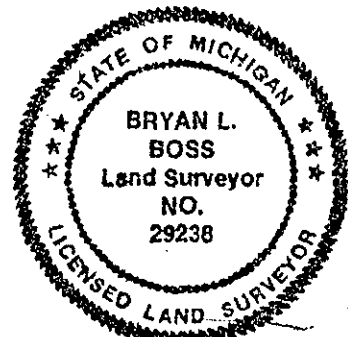

Signed by Bryan L. Boss
 Surveyor's Michigan License No. 29238

Date 10-15-1998