

**SURVEY &
REMONUMENTATION**

FILED

APR 28 1995

Nov 16 11 03 AM '94

COMMISSION LAND CORNER RECORDATION CERTIFICATE
Filing Requirement of Act 74, Mich. P.A. 1970

NANCY HAVILAND
REGISTER OF DEEDS
LIVINGSTON COUNTY, MI
48843

For corners in
Livingston
(County)

| | Located In: | Corner Code #/1 |
|------------------------------------|-------------------------|-----------------|
| 1. Public Land Survey | T <u>2N</u> R <u>6E</u> | <u>I-11</u> |
| | T _____ R _____ | _____ |
| | T _____ R _____ | _____ |
| | T _____ R _____ | _____ |
| 2. Property Controlling in Section | S _____ T _____ R _____ | _____ |
| | S _____ T _____ R _____ | _____ |
| 3. Miscellaneous Property in Sec. | S _____ T _____ R _____ | _____ |
| | S _____ T _____ R _____ | _____ |

L.S.C. #313m
Register of Deeds Stamp & File Number

4. Lot No. _____, Recorded Plat _____
5. Private Claims _____

| | A | B | C | D | E | F | G | H | I | J | K | L | M |
|----|----|----|----|----|----|----|---|---|---|---|---|---|---|
| 2 | 6 | 5 | 4 | 3 | 2 | | | | | | | | |
| 3 | | | | | | | | | | | | | |
| 4 | 7 | 8 | 9 | 10 | 11 | 12 | | | | | | | |
| 5 | | | | | | | | | | | | | |
| 6 | 18 | 17 | 16 | 15 | 14 | 13 | | | | | | | |
| 7 | | | | | | | | | | | | | |
| 8 | 19 | 20 | 21 | 22 | 23 | 24 | | | | | | | |
| 9 | | | | | | | | | | | | | |
| 10 | 30 | 29 | 28 | 27 | 26 | 25 | | | | | | | |
| 11 | | | | | | | | | | | | | |
| 12 | 31 | 32 | 33 | 34 | 35 | 36 | | | | | | | |
| 13 | | | | | | | | | | | | | |

I, Bryan Boss, in a field survey on 10-28, 19 94, do hereby certify that under requirements of P.A. 74, Michigan P.A. of 1970, the corner points mentioned in lines 1 and 2 above were in conformance with regulations and rules therefore as required in the current manual of survey instructions of the United States Department of the Interior, Bureau of Land Management or by a decree of a Court of Law and/or that the corner points mentioned in lines 3, 4 and 5 above were in conformance with the rules of the Michigan Board of Land Surveyors or by a Decree of a Court of Law; established, re-established, monumented, re-monumented, recovered, found as expressed below:

NOTE: Not more than 4 corners, all in the same town and range, may be recorded on this certificate.

A. Description of original monument and accessories and/or subsequent restoration:

White Oak 10" N 83 W 41 Links
White Oak 12" S 86 E 29 Links
White Oak 4" N 70 E 3 Links

ADDITIONAL HISTORICAL DATA ON BACK OF SHEET

B. Description of corner evidence found and/or method applied in restoring or reestablishing corner:

Found Concrete Monument in East & West fence line 0.70' feet East of old fence corner post.

C. Description of monument for corner and accessories established to perpetuate locating the position of the corner:

Set brass cap marked Livingston County Monument Corner over existing concrete monument.

North 18.25' N/T E/S 36" Oak
N80°E 11.79' N/T N/S 36" Oak
S15°E 20.54' N/T E/S 8" Twin Beech
N80°W 27.87' N/T N/S 4" Locust

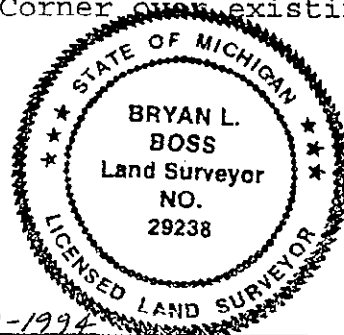

Signed by Bryan L. Boss Date 11-10-1994

Surveyor's Michigan License No. 29238

FORM APPROVED BY MICHIGAN STATE BOARD OF LAND SURVEYORS, JAN. 28, 1971
REVISED MAY 14, 1975
REVISED JAN., 1983

PA. 345 1990, APPROVED BY LIVINGSTON COUNTY
PEER GROUP ON 7 Sep 94 CO. REP [Signature]

T2N-R6E I-11 Pg. 1

BOSS ENGINEERING **ENGINEERS & SURVEYORS**

SUMMARY

I-11

NORTHWEST CORNER, SECTION 35, T2N-R6E BRIGHTON TOWNSHIP, LIVINGSTON COUNTY, MICHIGAN.

Found Monument in East & West Fence Line, 0.7' feet East of old fence corner post. Stone row remnants of wire fence to the North. Township Surveyed on 1815 by Alex Holmes D.S. Sections were Surveyed in 1823 by Sylvester Sibley. Sections Surveyed and witnessed again in 1879 by M.W. Bullock.

Measured to Witnesses found. Recorded Witness Corner #131 by Landini on 10-71 was submitted with wrong Corner Code. Page 11 of this Dossier. Found 3 of 3 Albright Witnesses pages 11, 12, 13, 15 and they checked. Found 3 of 3 Tri-County Witnesses page 18 and they checked. Found 4 of 4 Darrell Hughes Witnesses page 24 and they checked.

Distance from the Northwest Corner of Section 35 to the North 1/4 Corner of said Section is 2671.68' feet G.L.O. page 5 this Dossier. Distance to the West 1/8 line from said Northwest Corner is 1327.99' feet Munzel Survey page 22 this Dossier; 1327.99' feet Hughes Survey page 23 of this Dossier; Distance from Northwest Corner of Section 35 to the North 1/4 Corner of Section 34 is 2574.00 G.L.O. page 5 this Dossier; 2644.54' feet Raymond Donnelly plat page 17 this Dossier; 2646.47' feet Orchard Hiltz plat on page 19 of this Dossier; distance from the Northwest Corner of Section 35 to the West 1/4 Corner of Section 26 is 2691.32' feet Boss Engineering Survey page 21 this Dossier; 2691.32' feet Hughes Survey on page 23 of this Dossier.

Area is heavily wooded and not conducive for G.P.S..

Conclusion: We find that the aforementioned evidence describes the concrete monument as the Northwest Corner of Section 35.

file:sum

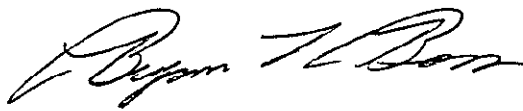
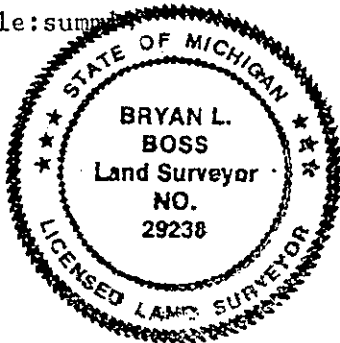
A handwritten signature in cursive script, appearing to read "Bryan L. Boss".

Boss Engineering Company • 3121 East Grand River • Howell Michigan 48843
Phone (517) 546-4836 • Brighton (313) 229-4773 • Fax (517) 548-1670