

SURVEY & REMONUMENTATION

FILED

APR 28 1995

Nov 16 2 06 PM '94

LAND CORNER RECORDATION CERTIFICATE COMMISSION Filing Requirement of Act 74, Mich. P.A. 1970

NANCY HAVILAND
REGISTER OF DEEDS
LIVINGSTON COUNTY, MI
48843

For corners in

Livingston <small>(County)</small>	Located In:	Corner Code //	
1. Public Land Survey	T 2N R 6E	L-11	
	T _____ R _____	_____	_____
	T _____ R _____	_____	_____
	T _____ R _____	_____	_____
2. Property Controlling in Section	S _____ T _____ R _____	_____	_____
	S _____ T _____ R _____	_____	_____
3. Miscellaneous Property in Sec.	S _____ T _____ R _____	_____	_____
	S _____ T _____ R _____	_____	_____

L.S.C. #356m

Register of Deeds Stamp & File Number

4. Lot No. _____, Recorded Plat _____
5. Private Claims _____

	A	B	C	D	E	F	G	H	I	J	K	L	M
2	6	5	4	3	2	1							
3													
4	7	8	9	10	11	12							
5													
6	18	17	16	15	14	13							
7													
8	19	20	21	22	23	24							
9													
10	30	29	28	27	26	25							
11													
12	31	32	33	34	35	36							
13													

I, Bryan Boss, in a field survey on Sept. 9, 19 94, do hereby certify that under requirements of P.A. 74, Michigan P.A. of 1970, the corner points mentioned in lines 1 and 2 above were in conformance with regulations and rules therefore as required in the current manual of survey instructions of the United States Department of the Interior, Bureau of Land Management or by a decree of a Court of Law and/or that the corner points mentioned in lines 3, 4 and 5 above were in conformance with the rules of the Michigan Board of Land Surveyors or by a Decree of a Court of Law; established, re-established, monumented, re-monumented, recovered, found as expressed below:

NOTE: Not more than 4 corners, all in the same town and range, may be recorded on this certificate.

A. Description of original monument and accessories and/or subsequent restoration:

- W. Oak 20 in. S41E 19 Links
- W. Oak 14 in. N56W 104 Links

Surveyed By Sylvester Sibley - 1823

Additional information on back.

B. Description of corner evidence found and/or method applied in restoring or reestablishing corner:

Found well point at fence intersection

C. Description of monument for corner and accessories established to perpetuate locating the position of the corner:

- North 21.38' Spike E/S 18" Cherry
- West 23.18' Spike S/S 24" Oak
- East 33.79' Spike N/S 6" Cherry
- S25°W 11.28' Set N/T W/S 10" Elm

Set 1 1/4" x 36" Iron Pipe with Brass Cap
(Livingston County Monument Corner)

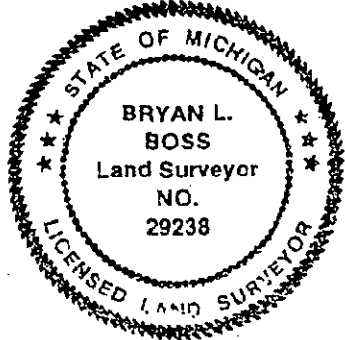

Approved by
Monumentation Peer
Group 9/15/93

Signed by Bryan Boss

Date Sept. 26, 1994

Surveyor's Michigan License No. 29238

SUMMARY

L-11 N 1/4 Corner, Section 36, Brighton Township, T2N-R6E

Found 2" well point at fence intersection. This point hits the coordinates of Huron Clinton Metro Authority Job of 1944. This corner was used by John D. Albright #10057 in August of 1976, again in October of 1977, he recorded on Act 74. Gary R. Boss #17022 in 1986 used the same corner

Bryan L. Boss. P.S.

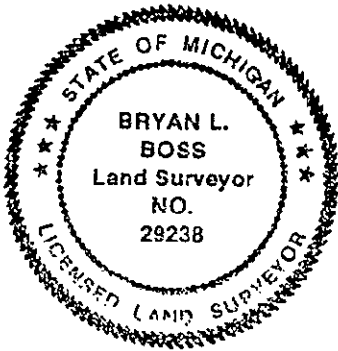

A handwritten signature in cursive script that reads "Bryan L. Boss".