

SURVEY & REMONUMENTATION

FEB 24 1998

9-

SECTION

LAND CORNER RECORDATION CERTIFICATE
Filing Requirement of Act 74, Mich. P.A. 1970

FILED

1997 NOV 25 A 11: 12

NANCY HAVILAND
REGISTER OF DEEDS
LIVINGSTON COUNTY, MI.
48843

L.S.C. #814H

Register of Deeds Stamp & File Number

For corners in

LIVINGSTON (County) Located in: BRIGHTON TWP. Corner Code //

Public Land Survey T 2N R 6E M-4

T R

T R

T R

Property Controlling S T R

in Section S F R

Miscellaneous S T R

Property in Sec. S T R

Lot No. Recorded Plat

Private Claims

	A	B	C	D	E	F	G	H	I	J	K	L	M
2	6	5	4	3	2	1							
3													
4	7	8	9	10	11	12							
5													
6	18	17	16	15	14	13							
7													
8	19	20	21	22	23	24							
9													
10	30	29	28	27	26	25							
11													
12	31	32	33	34	35	36							
13													

BRYAN L. BOSS in a field survey on NOVEMBER 4, 1997

hereby certify that under requirements of P.A. 74, Michigan P.A. of 1970, the corner points mentioned in lines 1 and 2 above were in conformance with regulations and rules therefore as required in the current manual of survey instructions of the United States Department of the Interior, Bureau of Land Management or by a decree of a Court of Law and/or that the corner points mentioned in lines 3, 4 and 5 above were in conformance with the rules of the Michigan Board of Land Surveyors or by a Decree of a Court of Law; established, re-established, monumented, re-monumented, recovered, found as pressed below:

NOTE: Not more than 4 corners, all in the same town and range, may be recorded on this certificate.

Description of original monument and accessories and/or subsequent restoration:

BLACK OAK 12" S 75 E 87 LINKS

MAPLE 15" S 40 E 36.4

MAPLE 22" N 50 E 63

OAK N 03 E 23.5

Description of corner evidence found and/or method applied in restoring or reestablishing corner:

CORNER OBLITERATED.

LOCATED BETWEEN TWO GENERAL MOTORS PROVING GROUNDS TEST TRACKS.

REESTABLISHED M-4 BY USING WARNER & WARNER SURVEY.

PA. 345 1990, APPROVED BY LIVINGSTON COUNTY

DEED GROUP ON 9-17-97 CO. REP JED

Description of monument for corner and accessories established to perpetuate locating the position of the corner:

SET 1 1/2" X 30" PIPE WITH 6" BREAKOFF IN MONUMENT BOX

AT NORTH EDGE OF OLD HYNE ROAD BED. SET BRASS CAP

IN PIPE STAMPED "LIVINGSTON CO. MONUMENTATION CORNER".

EAST 210.47' CENTER OF SIGN POST (EDISON)

SOUTH 73.10' SOUTH END CULVERT

N 10° E 19.61' CENTER OF BEEHIVE CATCH BASIN

WEST 167.79' CENTER OF SIGN POST (PINGREE)

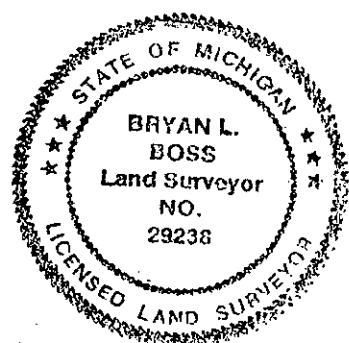

Surveyed by *Bryan L. Boss* Date *Nov. 11, 1997*

Surveyor's Michigan License No. 29238

SUMMARY
M-4

East 1/4 Corner, Section 12, T2N-R6E Brighton Township.

The corner was set in 1816 by Alex Holmes.

It is located between two General Motors Proving Grounds Test Tracks where construction has obliterated corner.(see field notes page 12 of dossier)

The Warner survey of 1954 shows a location for this point.

Boss Eng. set a GPS point near this Corner in June of 1997. The distance between M-3 and M-5 is 1.4 feet longer then the Warner survey. A temporary iron was placed at a prorated location using the Warner survey , which is 0.7feet longer from M-3 to M-4 and 0.7 feet longer from M-4 to M-5. This temp. Corner is 21 feet North of Centerline Old Hyne Road. The entire area was searched and no other evidence was found.

The area was open for a G.P.S.

We recommend re-establishment of M-4 by using the Warner survey as M-4.

BRISM-4

Bryan L. Boss

