

SURVEY & REMONUMENTATION

FILED

APR 28 1995

Nov 16 11 04 AM '94

COMMISSION LAND CORNER RECORDATION CERTIFICATE
 Filing Requirement of Act 74, Mich. P.A. 1970
 NANCY HAVILAND
 REGISTER OF DEEDS
 LIVINGSTON COUNTY, MI
 48843

For corners in

Livingston	Located In:	Corner Code #
1. Public Land Survey	T 2N R 6E	M-8
	T R	
	T R	
	T R	
2. Property Controlling In Section	S T R	
	S T R	
3. Miscellaneous Property in Sec.	S T R	
	S T R	

L.S.C.#324m

Register of Deeds Stamp & File Number

4. Lot No. _____, Recorded Plat _____
 5. Private Claims _____

	A	B	C	D	E	F	G	H	I	J	K	L	M
2	6	5	4	3	2	1							
3													
4	7	8	9	10	11	12							
5													
6	18	17	16	15	14	13							
7													
8	19	20	21	22	23	24							
9													
10	30	29	28	27	26	25							
11													
12	31	32	33	34	35	36							
13													

I, Bryan Boss, in a field survey on 10-26, 19 94, do hereby certify that under requirements of P.A. 74, Michigan P.A. of 1970, the corner points mentioned in lines 1 and 2 above were in conformance with regulations and rules therefore as required in the current manual of survey instructions of the United States Department of the Interior, Bureau of Land Management or by a decree of a Court of Law and/or that the corner points mentioned in lines 3, 4 and 5 above were in conformance with the rules of the Michigan Board of Land Surveyors or by a Decree of a Court of Law; established, re-established, monumented, re-monumented, recovered, found as expressed below:

NOTE: Not more than 4 corners, all in the same town and range, may be recorded on this certificate.

A. Description of original monument and accessories and/or subsequent restoration:

Black Oak 6" N 15 W 77 Links
 White Oak -- South 1.70

ADDITIONAL HISTORICAL DATA ON BACK OF SHEET

B. Description of corner evidence found and/or method applied in restoring or reestablishing corner:

Found 1/2" inch capped iron #21577 to be 4 feet ± North and 10 feet ± East of Witnesses set by others. Correct location was obliterated by underground construction. William Mills R.L.S. #21577 did not dispute location approved by Peer Group.

T2N-R6E M-8 Pg. 1

C. Description of monument for corner and accessories established to perpetuate locating the position of the corner:

Set 1 1/4" x 30" iron pipe and raised with 1 1/4" x 6" iron pipe with brass cap marked Livingston County Monument corner. 10.50 feet West of centerline Labadie Road.

- N40°E 58.88' N/T NW/S 32" Oak
- S35°E 46.00' N/T SW/S 28" Oak
- N30°W 46.39' N/T NE/S 24" Cherry
- S35°W 44.44' N/T SE/S 30" Oak
- West 19.95' 3" galvanized fence corner post

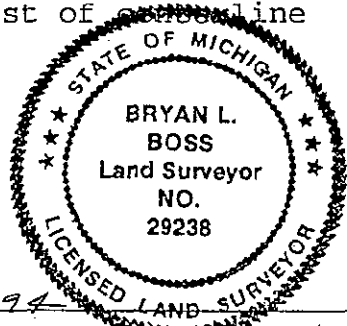

Signed by Bryan L. Boss

Date 11-10-1994

Surveyor's Michigan License No. 29238

FORM APPROVED BY MICHIGAN STATE BOARD OF LAND SURVEYORS, JAN. 28, 1971
 REVISED MAY 14, 1975
 REVISED JAN., 1983

P.A. 345 1990, APPROVED BY LIVINGSTON COUNTY
 PEER GROUP ON 5 Oct 94 CO. REP RMB

BOSS ENGINEERING ENGINEERS & SURVEYORS

SUMMARY
M-8

EAST 1/4 CORNER, SECTION 24, T2N-R6E BRIGHTON TOWNSHIP, LIVINGSTON COUNTY, MICHIGAN.

Found capped iron #21577 William Mills, Westland Michigan, employed by Jarrett Mills, Schron Consulting Engineers. 0.20 under surface and 2 feet \pm West of Centerline of Labadie Road. New cyclone fence 4 feet South of West side of Labadie Road. Measured to Witnesses found.

Found 4 of 4 Donald Ross Witnesses page 13 and they did not check. Found 4 of 4 Donald King Witnesses page 14 they did not check. Found 2 of 4 Kennedy Surveying Witnesses page 17 and they did not check.

The witnesses from the 3 surveys, Ross, King & Kennedy check to a point 4' South and 10' \pm West of the Mills capped iron. A recent gas line was installed at this location, explaining the absence of any monumentation.

Distance from the East 1/4 Corner of Section 24 to the center of said Section 24 is 2657.33' feet Donald H. King Survey page 14 of this Dossier; and 2657.20' feet Kennedy Survey page 16.

Distance from the East 1/4 Corner of Section 24 to the Northeast Corner of said Section is 2667.77' feet Kennedy Survey page 16 this Dossier; and 2665.49' feet Raymond Kostecke Survey page 11. Distance from the East 1/4 Corner of Section 24 to the Southeast Corner of said Section is 2623.09' feet Donald Ross Survey pages 12 and 15 this Dossier; 2623.24 Kennedy Survey page 16; 2627.12 feet Jarrett-Mills-Schron Survey Pages 20,21. Many overhanging branches will make a difficult G.P.S.

Conclusion: We recommend resetting East 1/4 corner 4' +/- South and 10' +/- West of existing capped iron by utilizing witnesses found and used by Ross, King and Kennedy. In accordance with directives approved by the Livingston County Survey and Remonumentation Committee on August 12, 1994, a letter stipulating that a multiple marker situation does exist, has been sent to William Mills L.S. #21577. There is a conflict, however, with the existing Iron found. William Mills L.S. #21577 set this 1/4 corner per deed description furnished by Holloway Gravel Company. A follow up phone conversation with Mr. Mills was made on October 4, 1994. Mr. Mills will not be attending the Peer Group meeting and does not dispute the conclusion of this dossier. Previous corner was obliterated by underground construction per William Mills and Boss Engineering field observation.

file: summm8

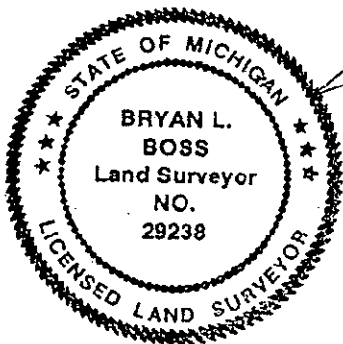

Bryan L. Boss
Boss Engineering Company • 3121 East Grand River • Howell, Michigan 48843
Phone (517) 546-4836 • Brighton (810) 229-4773 • Fax (517) 548-1670