

MAR 17 2000

SECTION

LAND CORNER RECORDATION CERTIFICATE
Filing Requirement of Act 74, Mich. P.A. 1970

FILED

For corners in

<u>LIVINGSTON</u> (County)	Located In:	Corner Code #
1. Public Land Survey	<u>T3N R4E</u>	<u>K-06</u>
	T ___ R ___	_____
	T ___ R ___	_____
	T ___ R ___	_____
2. Property Controlling in Section	S ___ T ___ R ___	_____
	S ___ T ___ R ___	_____
3. Miscellaneous Property in Sec.	S ___ T ___ R ___	_____
	S ___ T ___ R ___	_____

1999 MAY 21 A 9:22

NANCY HAVILAND
REGISTER OF DEEDS
LIVINGSTON COUNTY, MI.
48843

L.S.C.#1010 m

Register of Deeds Stamp & File Number

4. Lot No. _____, Recorded Plat _____
5. Private Claims _____

I, JACK K SMITH, in a field survey on APRIL 30, 1999 do hereby state that under requirements of P.A. 74, Michigan P.A. of 1970, the corner points mentioned in lines 1 and 2 above were in conformance with regulations and rules therefore as required in the current manual of survey instructions of the United States Department of the Interior, Bureau of Land Management or by a decree of a Court of Law and/or that the corner points mentioned in lines 3, 4 and 5 above were in conformance with the rules of the Michigan Board of Land Surveyors or by a Decree of a Court of Law, established, re-established, monumented, recovered, found as expressed below:

NOTE: Not more than 2 corners, all in the same town and range, may be recorded on this certificate.

1	A	B	C	D	E	F	G	H	I	J	K	L	M
2		6		5		4		3		2		1	
3													
4		7		8		9		10		11		12	
5													
6		18		17		16		15		14		13	
7													
8		19		20		21		22		23		24	
9													
10		30		29		28		27		26		25	
11													
12		31		32		33		34		35		36	
13													

A. Description of original monument and accessories and/or subsequent restoration:

GLO 1825 SIBLEY SET POST
BLACK OAK 17 N 78 1/2° E 41.6'
BLACK OAK 8 N 47° W 44.2'

B. Description of corner evidence found and/or method applied in restoring or reestablishing corner:

FOUND 1/2" REROD OVER BOAT SPIKE IN MONUMENT BOX FROM PREVIOUS WITNESSES. THIS POSITION IS THE ONLY ONE THAT APPEARS TO HAVE BEEN USED.

C. Description of monument for corner and accessories established to perpetuate locating the position of the corner:

K-06 WEST 1/4 CORNER SECTIONS 13 AND EAST 1/4 CORNER SECTION 14, T3N, R4E, HOWELL TOWNSHIP, LIVINGSTON COUNTY, MICHIGAN:

SET 1 1/4" X 36" STEEL PIPE WITH 6" BREAK OFF SECTION AND LIVINGSTON COUNTY REMONUMENTATION BRASS CAP WITH SURVEYOR #35999 IN MONUMENT BOX 2 FEET EAST OF CENTER LINE OF OAK GROVE ROAD.

N26°W NAIL WITH LIVINGSTON COUNTY REMON TAG IN EAST SIDE 48" OAK	69.65'
N46°E NAIL WITH LIVINGSTON COUNTY REMON TAG IN SOUTH SIDE LIGHT POLE	52.37'
N85°E NAIL WITH LIVINGSTON COUNTY REMON TAG IN SOUTH SIDE 48" OAK	88.61'
S53°W CENTER LINE OF 3" STEEL LIGHT POLE	71.10'

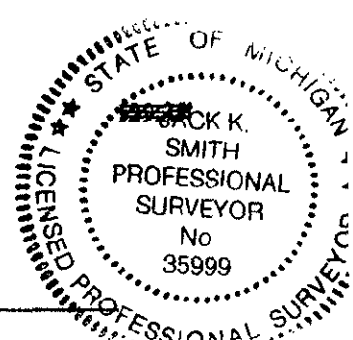

Signed by [Signature]

Date 5-12-1999

Surveyor's Michigan License No. 35999