

MAR 17 2000

LAND CORNER RECORDATION CERTIFICATE
Filing Requirement of Act 74, Mich. P.A. 1970

1999 MAY 21 A 9 22

NANCY HAVILAND
REGISTER OF DEEDS
LIVINGSTON COUNTY, MI.
48843

For corners in

SECTION

| | | |
|---------------------------------------|---------------------------|---------------|
| <u>LIVINGSTON</u> (County) | Located in: | Corner Code # |
| 1. Public Land Survey | T <u>3</u> N R <u>4</u> E | <u>L-03</u> |
| | T _____ R _____ | _____ |
| | T _____ R _____ | _____ |
| | T _____ R _____ | _____ |
| 2. Property Controlling in Section | S _____ T _____ R _____ | _____ |
| | S _____ T _____ R _____ | _____ |
| 3. Miscellaneous Property in Sec. | S _____ T _____ R _____ | _____ |
| | S _____ T _____ R _____ | _____ |

L.S.C.#1013m

Register of Deeds Stamp & File Number

- 4. Lot No. _____, Recorded Plat _____
- 5. Private Claims _____

| | | | | | | | | | | | | |
|----|----|---|----|---|----|---|----|---|----|---|----|---|
| A | B | C | D | E | F | G | H | I | J | K | L | M |
| 1 | | | | | | | | | | | | |
| 2 | 6 | | 5 | | 4 | | 3 | | 2 | | 1 | |
| 3 | | | | | | | | | | | | |
| 4 | 7 | | 8 | | 9 | | 10 | | 11 | | 12 | |
| 5 | | | | | | | | | | | | |
| 6 | 13 | | 17 | | 16 | | 15 | | 14 | | 13 | |
| 7 | | | | | | | | | | | | |
| 8 | 19 | | 20 | | 21 | | 22 | | 23 | | 24 | |
| 9 | | | | | | | | | | | | |
| 10 | 30 | | 29 | | 28 | | 27 | | 26 | | 25 | |
| 11 | | | | | | | | | | | | |
| 12 | 31 | | 32 | | 33 | | 34 | | 35 | | 36 | |
| 13 | | | | | | | | | | | | |

I, JACK K SMITH, in a field survey on APRIL 30, 1999 do hereby state that under requirements of P.A. 74, Michigan P.A. of 1970, the corner points mentioned in lines 1 and 2 above were in conformance with regulations and rules therefore as required in the current manual of survey instructions of the United States Department of the Interior, Bureau of Land Management or by a decree of a Court of Law and/or that the corner points mentioned in lines 3, 4 and 5 above were in conformance with the rules of the Michigan Board of Land Surveyors or by a Decree of a Court of Law; established, re-established, monumented, recovered, found as expressed below:

NOTE: Not more than 2 corners, all in the same town and range, may be recorded on this certificate.

A. Description of original monument and accessories and/or subsequent restoration:

GLO 1825 SIBLEY SET POST
TAMARAC 10 N 49° W 5.3'
TAMARAC 7 S 19° E 5.3'

B. Description of corner evidence found and/or method applied in restoring or reestablishing corner:

SET 1 1/4" STEEL PIPE IN CENTER OF CIRCULAR NEST OF STONES AT LOCATION OF FOUND 6" DIAMETER WOODEN POST. THIS POSITION IS 2 FEET NORTH AND 3 FEET EAST OF 1/2 DISTANCE ON LINE BETWEEN THE SOUTHEAST AND SOUTHWEST CORNERS OF SECTION 1.

C. Description of monument for corner and accessories established to perpetuate locating the position of the corner:

L-03 SOUTH CORNER SECTION 1 AND NORTH 1/4 CORNER SECTION 12, T3N, R4E, HOWELL TOWNSHIP, LIVINGSTON COUNTY, MICHIGAN:
SET 1 1/4" X 36" STEEL PIPE WITH LIVINGSTON COUNTY REMONUMENTATION BRASS CAP STAMPED WITH SURVEYOR #35999 1 FOOT NORTH OF FENCE TO WEST OF LARGE SWAMP.

S05°W NAIL WITH LIVINGSTON COUNTY REMON TAG IN WEST SIDE 10" MAPLE
S80°W NAIL WITH LIVINGSTON COUNTY REMON TAG IN SOUTH SIDE 10" MAPLE
N80°W NAIL WITH LIVINGSTON COUNTY REMON TAG IN SOUTH SIDE 10" MAPLE
NORTH NAIL WITH LIVINGSTON COUNTY REMON TAG IN WEST SIDE 10" ELM

18.03'
52.49'
45.51'
31.40'

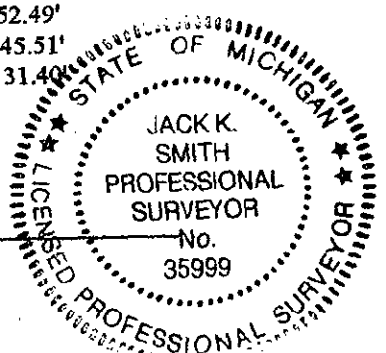

Signed by

[Signature]

Date

5-12-1999

Surveyor's Michigan License No. 35999