

MAR 17 2000

FILED

SECTION

LAND CORNER RECORDATION CERTIFICATE
Filing Requirement of Act 74, Mich. P.A. 1970

1999 MAY 21 A 9:22

For corners in

NANCY HAVILAND
REGISTER OF DEEDS
LIVINGSTON COUNTY, MI.
48843

<u>LIVINGSTON</u> (County)	Located In:	Corner Code #
1. Public Land Survey	<u>T 3 N R 4 E</u>	<u>L-05</u>
	T ___ R ___	_____
	T ___ R ___	_____
	T ___ R ___	_____
2. Property Controlling in Section	S ___ T ___ R ___	_____
	S ___ T ___ R ___	_____
3. Miscellaneous Property in Sec.	S ___ T ___ R ___	_____
	S ___ T ___ R ___	_____

L.S.C.#1014m

Register of Deeds Stamp & File Number

4. Lot No. _____, Recorded Plat _____
5. Private Claims _____

I, JACK K SMITH, in a field survey on APRIL 30, 1999, do hereby state that under requirements of P.A. 74, Michigan P.A. of 1970, the corner points mentioned in lines 1 and 2 above were in conformance with regulations and rules therefore as required in the current manual of survey instructions of the United States Department of the Interior, Bureau of Land Management or by a decree of a Court of Law and /or that the corner points mentioned in lines 3, 4 and 5 above were in conformance with the rules of the Michigan Board of Land Surveyors or by a Decree of a Court of Law; established, re-established, monumented, recovered, found as expressed below:

NOTE: Not more than 2 corners, all in the same town and range, may be recorded on this certificate.

A	B	C	D	E	F	G	H	I	J	K	L	M
1												
2	6	5	4	3	2	1						
3												
4	7	8	9	10	11	12						
5												
6	16	17	16	15	14	13						
7												
8	19	20	21	22	23	24						
9												
10	30	29	28	27	26	25						
11												
12	31	32	33	34	35	36						
13												

A. Description of original monument and accessories and/or subsequent restoration:

GLO 1825 SIBLEY SET POST
BLACK OAK 10 N 43° E 17.5'
WHITE OAK 7 S 57 1/2° W 15.2'

B. Description of corner evidence found and/or method applied in restoring or reestablishing corner:

FOUND 1/2" REROD ON EAST SIDE OF GOLF COURSE FROM PREVIOUS WITNESSES. THIS POSITION APPEARS TO BE THE ONLY ONE THAT HAS BEEN USED.

C. Description of monument for corner and accessories established to perpetuate locating the position of the corner:

L-05 SOUTH CORNER SECTION 12 AND NORTH 1/4 CORNER SECTION 13, T3N, R4E, HOWELL TOWNSHIP, LIVINGSTON COUNTY, MICHIGAN:
SET 1 1/4" X 36" STEEL PIPE WITH LIVINGSTON COUNTY REMONUMENTATION BRASS CAP STAMPED WITH SURVEYOR #35999 ON EAST SIDE OF GOLF COURSE AND ON THE EAST EDGE OF A 40" STUMP.

S05°W NAIL WITH LIVINGSTON COUNTY REMON TAG IN EAST SIDE 8" ASH
S72°W CENTER LINE OF 2" MAPLE
S53°W CENTER LINE OF 3" SPRUCE
N30°W NAIL WITH LIVINGSTON COUNTY REMON TAG IN EAST SIDE 7" MAPLE
N07°W NAIL WITH LIVINGSTON COUNTY REMON TAG IN EAST SIDE 24" CHERRY

5.95'
46.35'
86.40'
33.20'
62.28'

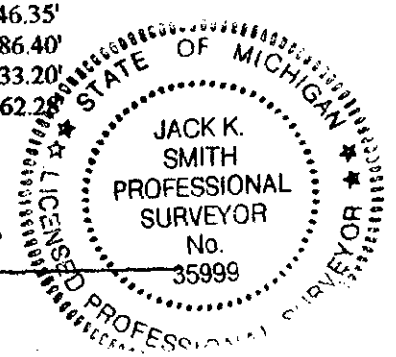

Signed by

[Handwritten Signature]

Date

5-12-1999

Surveyor's Michigan License No. 35999