

MAR 17 2000

FILED

SECTION

LAND CORNER REGORDATION CERTIFICATE
Filing Requirement of Act 74, Mich. P.A. 1970

1999 MAY 21 A 9:22

For corners in

NANCY HAVILAND
REGISTER OF DEEDS
LIVINGSTON COUNTY, MI.
48843

| | | |
|---------------------------------------|---------------------------|---------------|
| <u>LIVINGSTON</u> (County) | Located In: | Corner Code # |
| 1. Public Land Survey | T <u>3</u> N R <u>4</u> E | <u>L-07</u> |
| | T ___ R ___ | _____ |
| | T ___ R ___ | _____ |
| | T ___ R ___ | _____ |
| 2. Property Controlling in Section | S ___ T ___ R ___ | _____ |
| | S ___ T ___ R ___ | _____ |
| 3. Miscellaneous Property in Sec. | S ___ T ___ R ___ | _____ |
| | S ___ T ___ R ___ | _____ |

L.S.C.#1015m

Register of Deeds Stamp & File Number

4. Lot No. _____, Recorded Plat _____
5. Private Claims _____

I, JACK K SMITH, in a field survey on APRIL 30, 1999 do hereby state that under requirements of P.A. 74, Michigan P.A. of 1970, the corner points mentioned in lines 1 and 2 above were in conformance with regulations and rules therefore as required in the current manual of survey instructions of the United States Department of the Interior, Bureau of Land Management or by a decree of a Court of Law and /or that the corner points mentioned in lines 3, 4 and 5 above were in conformance with the rules of the Michigan Board of Land Surveyors or by a Decree of a Court of Law; established, re-established, monumented, recovered, found as expressed below:

NOTE: Not more than 2 corners, all in the same town and range, may be recorded on this certificate.

| | | | | | | | | | | | | | |
|----|----|----|----|----|----|----|---|---|---|---|---|---|---|
| | A | B | C | D | E | F | G | H | I | J | K | L | M |
| 1 | | | | | | | | | | | | | |
| 2 | 6 | 5 | 4 | 3 | 2 | 1 | | | | | | | |
| 3 | | | | | | | | | | | | | |
| 4 | 7 | 8 | 9 | 10 | 11 | 12 | | | | | | | |
| 5 | | | | | | | | | | | | | |
| 6 | 16 | 17 | 16 | 15 | 14 | 13 | | | | | | | |
| 7 | | | | | | | | | | | | | |
| 8 | 19 | 20 | 21 | 22 | 23 | 24 | | | | | | | |
| 9 | | | | | | | | | | | | | |
| 10 | 30 | 29 | 28 | 27 | 26 | 25 | | | | | | | |
| 11 | | | | | | | | | | | | | |
| 12 | 31 | 32 | 33 | 34 | 35 | 36 | | | | | | | |
| 13 | | | | | | | | | | | | | |

A. Description of original monument and accessories and/or subsequent restoration:

GLO 1825 SIBLEY SET POST
WHITE OAK 12 S 42° W 33.0'
WHITE OAK 12 S 56° E 25.7'

B. Description of corner evidence found and/or method applied in restoring or reestablishing corner:

FOUND SPIKE IN TOP OF RAIL ROAD TIE FENCE CORNER POST FROM PREVIOUS WITNESSES. THIS POSITION APPEARS TO BE THE ONLY ONE THAT HAS BEEN USED.

C. Description of monument for corner and accessories established to perpetuate locating the position of the corner:

L-07 SOUTH CORNER SECTION 13 AND NORTH 1/4 CORNER SECTION 24, T3N, R4E, HOWELL TOWNSHIP, LIVINGSTON COUNTY, MICHIGAN:
SET SPIKE IN NORTHERLY FACE OF RAILROAD TIE FENCE CORNER POST.

| | |
|--|--------|
| WEST 1" X 36" PIPE WITH LIVINGSTON COUNTY REMON BRASS WITNESS CAP | 1.00' |
| SOUTH 1" X 36" PIPE WITH LIVINGSTON COUNTY REMON BRASS WITNESS CAP | 1.00' |
| N70°E NAIL WITH LIVINGSTON COUNTY REMON TAG IN NW SIDE UTILITY POLE | 3.00' |
| S85°W NAIL WITH LIVINGSTON COUNTY REMON TAG IN NORTH SIDE 9" HICKORY | 28.48' |
| S36°W NAIL WITH LIVINGSTON COUNTY REMON TAG IN EAST SIDE 13" MAPLE | 42.28' |
| S75°E NAIL WITH LIVINGSTON COUNTY REMON TAG IN NORTH SIDE 40" OAK | 54.62' |

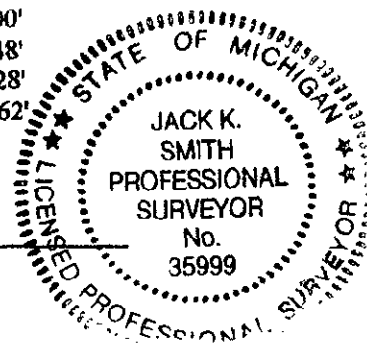

Signed by [Signature]

Date 5-12-1999

Surveyor's Michigan License No. 35999