

**SURVEY & REMONUMENTATION**

FEB 24 1998

SECTION

**LAND CORNER RECORDATION CERTIFICATE**  
Filing Requirement of Act 74, Mich. P.A. 1970

**FILED**

For corners in

LIVINGSTON  
(County)

Located In:

Corner Code #

- |                                    |   |             |
|------------------------------------|---|-------------|
| 1. Public Land Survey              | T <u>3N</u> R <u>5E</u>                   | <u>D-13</u> |
|                                    | T <u>    </u> R <u>    </u>               | <u>    </u> |
|                                    | T <u>    </u> R <u>    </u>               | <u>    </u> |
|                                    | T <u>    </u> R <u>    </u>               | <u>    </u> |
| 2. Property Controlling in Section | S <u>    </u> T <u>    </u> R <u>    </u> | <u>    </u> |
|                                    | S <u>    </u> T <u>    </u> R <u>    </u> | <u>    </u> |
| 3. Miscellaneous Property in Sec.  | S <u>    </u> T <u>    </u> R <u>    </u> | <u>    </u> |
|                                    | S <u>    </u> T <u>    </u> R <u>    </u> | <u>    </u> |

1997 NOV 13 P 1:45

NANCY HAVILAND  
REGISTER OF DEEDS  
LIVINGSTON COUNTY, MI.  
48843

L. S. C. 809m

Register of Deeds Stamp & File Number

4. Lot No. \_\_\_\_\_, Recorded Plat \_\_\_\_\_  
5. Private Claims \_\_\_\_\_

I, Jack K. Smith, in a field survey on Sept. July 20, 1997 do hereby state that under requirements of P.A. 74, Michigan P.A. of 1970, the corner points mentioned in lines 1 and 2 above were in conformance with regulations and rules therefore as required in the current manual of survey instructions of the United States Department of the Interior, Bureau of Land Management or by a decree of a Court of Law and /or that the corner points mentioned in lines 3, 4 and 5 above were in conformance with the rules of the Michigan Board of Land Surveyors or by a Decree of a Court of Law; established, re-established, monumented, recovered, found as expressed below:

	A	B	C	D	E	F	G	H	I	J	K	L	M
1													
2		6		5		4		3		2		1	
3													
4		7		8		9		10		11		12	
5													
6		18		17		16		15		14		13	
7													
8		19		20		21		22		23		24	
9													
10		30		29		28		27		26		25	
11													
12		31		32		33		34		35		36	
13													

NOTE: Not more than 2 corners, all in the same town and range, may be recorded on this certificate.

A. Description of original monument and accessories and/or subsequent restoration:

D-13 The South 1/4 Corner of Section 32, Oceola Township was set by Alex Holmes for the GLO in 1816.  
The original witnesses are:  
Tamarack 8" S15°E 24 lk (15.8')  
Tamarack 9" S33°W 26 lk (17.2')

NOTE: NONE OF THE ORIGINAL WITNESSES COULD BE FOUND OR PERPETUATED. SEE THE BACK OF THIS SHEET FOR ADDITIONAL HISTORICAL DATA.

B. Description of corner evidence found and/or method applied in restoring or reestablishing corner:

D-13 Found 1/2" re-rod in a monument box on the centerline of Golf Club Road

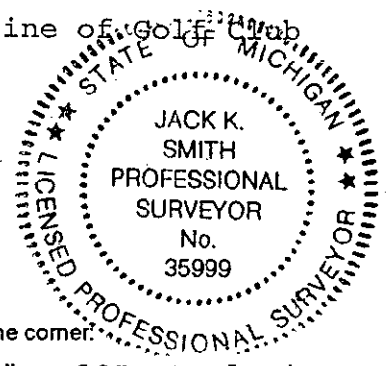

C. Description of monument for corner and accessories established to perpetuate locating the position of the corner:

D-13 South 1/4 Corner, Section 32, T3N, R5E - Set 1 1/4" x 30" steel pipe with 6" break-off section and brass cap marked as "Livingston County Remonumentation Corner" in existing monument box.

S62°E	Set witness pipe*	44.17'
S66°W	Set witness pipe**	45.71'
N61°W	Set witness pipe**	49.45'
N59°E	Set witness pipe*	44.27'

\* 36"X1" iron pipe with brass cap marked "Livingston County Remonumentation Witness"

Signed by Jack K. Smith  
Surveyor's Michigan License No. 35999

Date Sept. July 20, 1997

July 12, 1997

D-13 T3N - R5E: SOUTH 1/4 CORNER, SECTION 32, OCEOLA TOWNSHIP

**MONUMENTATION**

D-13 was set by Alex Holmes for the GLO in 1816. This corner is currently marked by a 1/2" re-rod in a monument box on the centerline of Golf Club Road. There is a fenceline (the east side of the golf course) going to the north. No other marker could be found near this location.

**MEASUREMENTS**

Current measure is 2648.97 feet to the east which agrees within 0.05 feet with Boss 1987 measure.

**OCCUPATION**

The corner falls on the centerline of Golf Club Road in line with a fence to the north. A sweep of the area around the corner with a magnetic locator did not reveal any alternate corner positions. This corner is open for GPS but there is poor sight distance to the east.

**RECORDATION**

There is an Act 74 filed by Gary Boss in 1979 for this corner although it is shown as C-13 (which falls in Earl Lake). The corner has been shown on 4 Act 132s.

**SUMMARY**

The current location of the corner has been used for numerous surveys in the area and no other position has been used that I could find. I recommend that the existing 1/2" iron be replaced with a Livingston County Remonumentation pipe and cap in the present location.

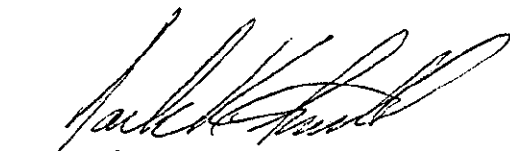
  
Jack K. Smith, PS  
Desine Inc.

