

SURVEY & REMONUMENTATION

FEB 24 1998

SECTION

LAND CORNER RECORDATION CERTIFICATE
Filing Requirement of Act 74, Mich. P.A. 1970

FILED

For corners in
LIVINGSTON
(County)

Located In:	Corner Code #
T <u>3N</u> R <u>5E</u>	E-13
T <u> </u> R <u> </u>	_____
T <u> </u> R <u> </u>	_____
T <u> </u> R <u> </u>	_____
S <u> </u> T <u> </u> R <u> </u>	_____
S <u> </u> T <u> </u> R <u> </u>	_____
S <u> </u> T <u> </u> R <u> </u>	_____
S <u> </u> T <u> </u> R <u> </u>	_____

1997 NOV 13 P 1:45

NANCY HAVILAND
REGISTER OF DEEDS
LIVINGSTON COUNTY, MI.
48843

L.S.C.#810m

Register of Deeds Stamp & File Number

1. Public Land Survey

2. Property Controlling in Section

3. Miscellaneous Property in Sec.

4. Lot No. _____, Recorded Plat _____
5. Private Claims _____

I, Jack K. Smith, in a field survey on Sept. 20, 1997 do hereby state that under requirements of P.A. 74, Michigan P.A. of 1970, the corner points mentioned in lines 1 and 2 above were in conformance with regulations and rules therefore as required in the current manual of survey instructions of the United States Department of the Interior, Bureau of Land Management or by a decree of a Court of Law and for that the corner points mentioned in lines 3, 4 and 5 above were in conformance with the rules of the Michigan Board of Land Surveyors or by a Decree of a Court of Law, established, re-established, monumented, recovered, found as expressed below.

NOTE: Not more than 2 corners, all in the same town and range, may be recorded on this certificate.

	A	B	C	D	E	F	G	H	I	J	K	L	M
1													
2	6		5		4		3		2		1		
3													
4	7		8		9		10		11		12		
5													
6	18		17		16		15		14		13		
7													
8	19		20		21		22		23		24		
9													
10	30		29		28		27		26		25		
11													
12	31		32		33		34		35		36		
13													

A. Description of original monument and accessories and/or subsequent restoration:

E-13 The Southeast Corner of Section 32, Oceola Township was set by Alex Holmes for the GLO in 1816.
The original witnesses are:
W Oak 15" S10°W 9 lk (5.9')
W Oak 18" N17°E 16 lk (10.6')

NOTE: NONE OF THE ORIGINAL WITNESSES COULD BE FOUND OR PERPETUATED.
SEE THE BACK OF THIS SHEET FOR ADDITIONAL HISTORICAL DATA.

B. Description of corner evidence found and/or method applied in restoring or reestablishing corner:

E-13 Found 1/2" re-rod in a monument box at the intersection of centerlines of Latson and Golf Club Roads.

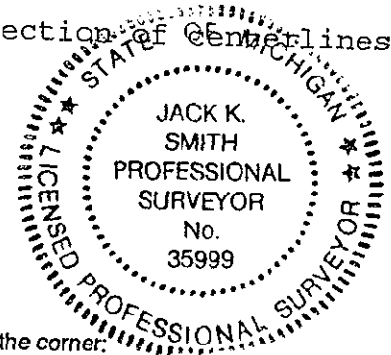

C. Description of monument for corner and accessories established to perpetuate locating the position of the corner:

E-13 Southeast Corner, Section 32, T3N, R5E - Set 1 1/4" x 30" steel pipe with 6" break-off section and brass cap marked as "Livingston County Remonumentation Corner" in existing monument box.

S39°W	Set witness pipe*	53.19'
S45°E	Set witness pipe*	52.58'
N48°E	Set witness pipe*	51.21'
N51°W	Set witness pipe*	52.98'

* 36"X1" iron pipe with brass cap marked "Livingston County Remonumentation Witness"

Signed by [Signature]
Surveyor's Michigan License No. 35999

Date Sept. 20, 1997

July 12, 1997

E-13 T3N - R5E: SOUTHEAST CORNER, SECTION 32, OCEOLA TOWNSHIP

MONUMENTATION

E-13 was set by Alex Holmes for the GLO in 1816. This corner is currently marked by a 1/2" re-rod in a monument box which can be traced back to witnesses for a found "T" iron by Newton in 1972. The corner is in the intersection of centerlines of Latson and Golf Club Roads. No other marker could be found near this location.

MEASUREMENTS

Current measure is 2648.97 feet to the west and 2647.78 feet to the east. Measures by other surveyors to adjacent corners compare well.

OCCUPATION

The corner falls in the intersection of centerlines of Latson and Golf Club Roads. A sweep of the area around the corner with a magnetic locator did not reveal any alternate corner positions. This corner is open for GPS but the intersection is very busy.

RECORDATION

There is an Act 74 filed by Chris Newman in 1984 for this corner. The corner has been shown on 15 Act 132s.

SUMMARY

The current location of the corner has been used for numerous surveys in the area and no other position has been used that I could find. I recommend that the existing 1/2" iron be replaced with a Livingston County Remonumentation pipe and cap in the present location.

Jack K. Smith, PS
Desine Inc.

