

**SURVEY & REMONUMENTATION**

FEB 24 1998

**FILED**

**SECTION**

**LAND CORNER RECORDATION CERTIFICATE**  
Filing Requirement of Act 74, Mich. P.A. 1970

For corners in

LIVINGSTON  
(County)

Located In:	Corner Code #
T <u>3N</u> R <u>5E</u>	F-13
T <u>    </u> R <u>    </u>	_____
T <u>    </u> R <u>    </u>	_____
T <u>    </u> R <u>    </u>	_____
S <u>    </u> T <u>    </u> R <u>    </u>	_____
S <u>    </u> T <u>    </u> R <u>    </u>	_____
S <u>    </u> T <u>    </u> R <u>    </u>	_____
S <u>    </u> T <u>    </u> R <u>    </u>	_____

1997 NOV 13 P 1:45

HANCY HAVILAND  
REGISTER OF DEEDS  
LIVINGSTON COUNTY, MI.  
48843

L.S.C.#811m

Register of Deeds Stamp & File Number

1. Public Land Survey

2. Property Controlling in Section

3. Miscellaneous Property in Sec.

4. Lot No. \_\_\_\_\_, Recorded Plat \_\_\_\_\_

5. Private Claims \_\_\_\_\_

I, Jack K. Smith, in a field survey on Sept. 20, 1997 do hereby state that under requirements of P.A. 74, Michigan P.A. of 1970, the corner points mentioned in lines 1 and 2 above were in conformance with regulations and rules therefore as required in the current manual of survey instructions of the United States Department of the Interior, Bureau of Land Management or by a decree of a Court of Law and/or that the corner points mentioned in lines 3, 4 and 5 above were in conformance with the rules of the Michigan Board of Land Surveyors or by a Decree of a Court of Law, established, re-established, monumented, recovered, found as expressed below:

NOTE: Not more than 2 corners, all in the same town and range, may be recorded on this certificate.

A	B	C	D	E	F	G	H	I	J	K	L	M
1												
2	6	5	4	3	2	1						
3												
4	7	8	9	10	11	12						
5												
6	18	17	16	15	14	13						
7												
8	19	20	21	22	23	24						
9												
10	30	29	28	27	26	25						
11												
12	31	32	33	34	35	36						
13												

A. Description of original monument and accessories and/or subsequent restoration:

F-13 The South 1/4 Corner of Section 33, Oceola Township was set by Alex Holmes for the GLO in 1816.

The original witnesses are:

B Oak	12"	WEST	8 lk (5.3')
W Oak	8"	SW	15 lk (9.9')

NOTE: NONE OF THE ORIGINAL WITNESSES COULD BE FOUND OR PERPETUATED. SEE THE BACK OF THIS SHEET FOR ADDITIONAL HISTORICAL DATA.

B. Description of corner evidence found and/or method applied in restoring or reestablishing corner:

F-13 Found 1/2" re-rod in a monument box 9 feet easterly and 11 feet northerly of the intersection of centerlines of Gulley (gravel to the north) and Golf Club Roads.

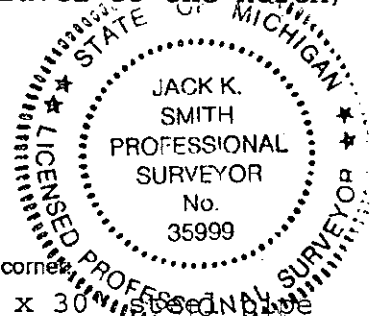

C. Description of monument for corner and accessories established to perpetuate locating the position of the corner:

F-13 South 1/4 Corner, Section 33, T3N, R5E - Set 1 1/4" x 30" steel nail pipe with 6" break-off section and brass cap marked as "Livingston County Remonumentation Corner" in existing monument box.

N70°E	Set witness pipe*	37.80'
S14°E	Set nail/tag in West side 16" Locust	61.18'
SOUTH	Set nail/tag in West side 18" Cherry	52.04'
N32°W	Set witness pipe*	52.17'

\* 36"X1" iron pipe with brass cap marked "Livingston County Remonumentation Witness"

Signed by Jack K. Smith  
Surveyor's Michigan License No. 35999

Date Sept. 20, 1997

July 12, 1997

F-13 T3N - R5E: SOUTH 1/4 CORNER, SECTION 33, OCEOLA TOWNSHIP

**MONUMENTATION**

F-13 was set by Alex Holmes for the GLO in 1816. This corner is currently marked by a 1/2" re-rod in a monument box which can be traced back to witnesses for a found "T" iron by Garlock in 1972. The corner is 9 feet easterly and 11 feet northerly of the intersection of centerlines of Gulley (gravel to the north) and Golf Club Roads. No other marker could be found near this location.

**MEASUREMENTS**

Current measure is 2647.78 feet to the west and 2649.30 feet to the east (within 0.76 feet of a split). All measures subsequent to 1972 compare well.

**OCCUPATION**

The corner falls 9 feet easterly and 11 feet northerly of the intersection of centerlines of Gulley (gravel to the north) and Golf Club Roads. A thorough sweep of the area around the corner with a magnetic locator did not reveal any alternate corner positions. This corner is open for GPS and can be used with minimal pre-mission planning.

**RECORDATION**

There is an Act 74 filed by Chris Newman in 1984 for this corner. The corner has been shown on 12 Act 132s.

**SUMMARY**

The current location of the corner has been used for numerous surveys in the area and no other position has been used that I could find. I recommend that the existing 1/2" iron be replaced with a Livingston County Remonumentation pipe and cap in the present location.

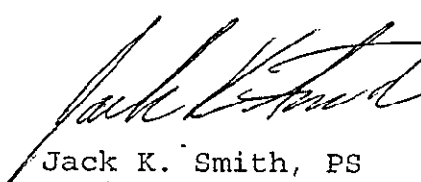
  
Jack K. Smith, PS  
Desine Inc.

