

MAR 17 2000

FILED

SECTION

LAND CORNER RECORDATION CERTIFICATE  
Filing Requirement of Act 74, Mich. P.A. 1970

For corners in

LIVINGSTON  
(County)

Located In:

Corner Code #

1. Public Land Survey

T 3N R 5E G-10

T \_\_\_\_\_ R \_\_\_\_\_

T \_\_\_\_\_ R \_\_\_\_\_

T \_\_\_\_\_ R \_\_\_\_\_

2. Property Controlling  
in Section

S \_\_\_\_\_ T \_\_\_\_\_ R \_\_\_\_\_

S \_\_\_\_\_ T \_\_\_\_\_ R \_\_\_\_\_

3. Miscellaneous  
Property in Sec.

S \_\_\_\_\_ T \_\_\_\_\_ R \_\_\_\_\_

S \_\_\_\_\_ T \_\_\_\_\_ R \_\_\_\_\_

4. Lot No. \_\_\_\_\_, Recorded Plat \_\_\_\_\_

5. Private Claims \_\_\_\_\_

9  
1999 NOV 22 A 10:07  
NANCY HAVILAND  
REGISTER OF DEEDS  
LIVINGSTON COUNTY, MI.  
48843  
LSC# 1081m  
Register of Deeds Stamp & File  
Number

I, MARY A. BARNWELL, in a field survey on OCTOBER 22, 1999 do hereby state that under requirements of P.A. 74, Michigan P.A. of 1970, the corner points mentioned in lines 1 and 2 above were in conformance with regulations and rules therefore as required in the current manual of survey instructions of the United States Department of the Interior, Bureau of Land Management or by a decree of a Court of Law and for that the corner points mentioned in lines 3, 4 and 5 above were in conformance with the rules of the Michigan Board of Land Surveyors or by a Decree of a Court of Law; established, re-established, monumented, recovered, found as expressed below:

A	B	C	D	E	F	G	H	I	J	K	L	M
1												
2	6	5	4	3	2	1						
3												
4	7	8	9	10	11	12						
5												
6	18	17	16	15	14	13						
7												
8	19	20	21	22	23	24						
9												
10	30	29	28	27	26	25						
11												
12	31	32	33	34	35	36						
13												

NOTE: Not more than 2 corners, all in the same town and range, may be recorded on this certificate.

A. Description of original monument and accessories and/or subsequent restoration:

G-10 Oceola Township was set by the GLO in 1823.

The original witnesses are:

White Oak 14" N. 62 1/2° E. 25 (16.5')

White Oak 9" N. 38 1/2° W. 29 (19.1')

NOTE: None of the original witnesses could be found or perpetuated.  
See the back of this sheet for additional historical data.

B. Description of corner evidence found and/or method applied in restoring or reestablishing corner:

G-10 Found 1/2" Iron Rod 9 feet West of the centerline of Hughes Road (gravel surface running North/South) -aerial photography of the area reveals Hughes Road swings Easterly through this area. No well defined occupation running West in the area. To the East the 1/2" Iron Rod is at the Westerly extension of the Northerly line of a private road easement.

C. Description of monument for corner and accessories established to perpetuate locating the position of the corner:

G-10 West 1/4 Corner, Section 27, T3N, R5E - Reset 1/2" Iron Rod with 36" x 1 1/4" Breakaway Iron Pipe W/Brass Cap marked as "Livingston County Monumentation Corner" 9'± West of centerline of Gravel Road

S 87° W Set Nail/Remon Washer N/S 30" Box Elder 18.47'

N 65° E Set Nail/Remon Washer S/S Twin 14" Oak 38.24'

N 87° E Set Nail/Remon Washer S/S Twin 12" Oak 43.62'

S 45° E Set Nail/Remon Washer SW/S 12" Oak 50.35'

Signed by

*Mary A. Barnwell*

Surveyor's Michigan License No.

33971

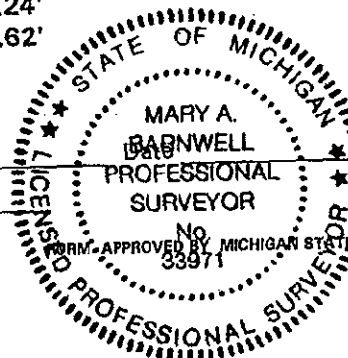

11-7-99

PA. 345 1990, APPROVED BY LIVINGSTON COUNTY  
PEER GROUP ON 10-8-99, CO. REP JED