

SURVEY & REMONUMENTATION

FEB 25 1999

FILED

SECTION

LAND CORNER RECORDATION CERTIFICATE
Filing Requirement of Act 74, Mich. P.A. 1970

For corners in

1998 OCT 20 P 1:21

NANCY HAVILAND
 REGISTER OF DEEDS
 LIVINGSTON COUNTY, MI.
 48843

<u>LIVINGSTON</u> (County)	Located In:	Corner Code #
1. Public Land Survey	<u>T3N R5E</u>	<u>I-03</u>
	T <u> </u> R <u> </u>	<u> </u>
	T <u> </u> R <u> </u>	<u> </u>
	T <u> </u> R <u> </u>	<u> </u>
2. Property Controlling in Section	§ <u> </u> T <u> </u> R <u> </u>	<u> </u>
	§ <u> </u> T <u> </u> R <u> </u>	<u> </u>
3. Miscellaneous Property in Sec.	§ <u> </u> T <u> </u> R <u> </u>	<u> </u>
	§ <u> </u> T <u> </u> R <u> </u>	<u> </u>

LSC 919M

Register of Deeds Stamp & File Number

4. Lot No. _____, Recorded Plat _____
 5. Private Claims _____

1	A	B	C	D	E	F	G	H	I	J	K	L	M
2		6		5		4		3		2		1	
3									●				
4		7		8		9		10		11		12	
5													
6		18		17		16		15		14		13	
7													
8		19		20		21		22		23		24	
9													
10		30		29		28		27		26		25	
11													
12		31		32		33		34		35		36	
13													

I, MARY A. BARNWELL, in a field survey on AUGUST 17, 1998, do hereby state that under requirements of D.A. 74, Michigan D.A. of 1970, the corner points mentioned in lines 1 and 2 above were in conformance with regulations and rules therefore as required in the current manual of survey instructions of the United States Department of the Interior, Bureau of Land Management or by a decree of a Court of Law and /or that the corner points mentioned in lines 3, 4 and 5 above were in conformance with the rules of the Michigan Board of Land Surveyors or by a Decree of a Court of Law, established, re-established, monumented, recovered, found as expressed below:

NOTE: Not more than 2 corners, all in the same town and range, may be recorded on this certificate.

A. Description of original monument and accessories and/or subsequent restoration:

GLO 5/29/1823 BY SIBLEY
 ELM 10 N 11 W 11 LKS (7.3')
 B. OAK 6 S 22 E 8 LKS (5.3')

B. Description of corner evidence found and/or method applied in restoring or reestablishing corner:

FOUND A 1/2" STEEL PIPE IN A MONUMENT BOX 3 FEET WEST OF THE INTERSECTION OF THE CENTERLINES OF CLYDE ROAD AND ARGENTINE ROAD (BOTH PAVED). THIS CORNER POSITION AGREES WELL WITH WITNESSES OF RECORD SINCE 1963.

C. Description of monument for corner and accessories established to perpetuate locating the position of the corner:

I-03 CORNER COMMON TO SECTIONS 2,3,10 AND 11, T3N, R5E OCEOLA TOWNSHIP, LIVINGSTON COUNTY, MICHIGAN:
 RESET THE FOUND 1/2" STEEL PIPE WITH 1 1/4" X 36" BREAKAWAY STEEL PIPE WITH LIVINGSTON COUNTY REMONUMENTATION BRASS CAP WITH SURVEYOR #35999 IN MONUMENT BOX 1/2 FOOT BELOW THE SURFACE OF CLYDE ROAD.

N34°E NAIL WITH LIVINGSTON COUNTY REMON TAG IN EAST SIDE 22" MAPLE 168.04'
 S55°E 2" DIAMETER STEEL PIPE SET IN CONCRETE 112.98'
 S50°W NAIL WITH LIVINGSTON COUNTY REMON TAG IN NORTH SIDE UTILITY POLE 46.89'
 N63°W NAIL WITH LIVINGSTON COUNTY REMON TAG IN SOUTH SIDE UTILITY POLE 101.21'

Signed by [Signature]

Date 10/1/98

Surveyor's Michigan license No. 33971

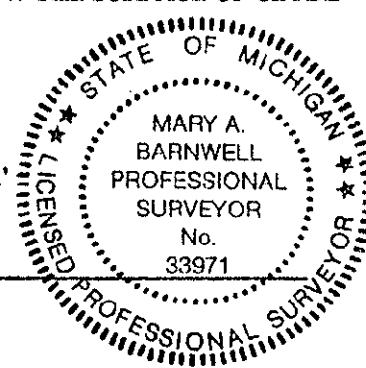

FORM APPROVED BY MICHIGAN SURVEY BOARD OF PROFESSIONAL SURVEYORS, JAN 21, 1991
 BOARD MAY 1975
 BOARD JAN 1985
 BOARD OCT 1995

P.A. 345 1990, APPROVED BY LIVINGSTON COUNTY
 PEER GROUP ON 7-15-98 CO. REP JED