

LAND CORNER RECORDATION CERTIFICATE
Filing Requirement of Act 74, Mich. P.A. 1970

For corners in
LIVINGSTON
(County)

Located In: Corner Code #/

1. Public Land Survey	T	3N	R	5E	I-11
	T		R		
	T		R		
	T		R		
2. Property Controlling in Section	S		T	R	
	S		T	R	
3. Miscellaneous Property in Sec.	S		T	R	
	S		T	R	

NANCY HAVILAN
REGISTER OF DEEDS
LIVINGSTON COUNTY, MI
48843
OCT 7 11 09 AM '96

FILED

L.S.C.#561M

Register of Deeds Stamp & File Number

4. Lot No. _____, Recorded Plat _____
5. Private Claims _____

	A	B	C	D	E	F	G	H	I	J	K	L	M
2		6		5		4		3		2		1	
3													
4		7		8		9		10		11		12	
5													
6		18		17		16		15		14		13	
7													
8		19		20		21		22		23		24	
9													
10		30		29		28		27		26		25	
11													
12		31		32		33		34		35		36	
13													

I, Jack K. Smith, in a field survey on June 20, 19 96, do hereby certify that under requirements of P.A. 74, Michigan P.A. of 1970, the corner points mentioned in lines 1 and 2 above were in conformance with regulations and rules therefore as required in the current manual of survey instructions of the United States Department of the Interior, Bureau of Land Management or by a decree of a Court of Law and/or that the corner points mentioned in lines 3, 4 and 5 above were in conformance with the rules of the Michigan Board of Land Surveyors or by a Decree of a Court of Law; established, re-established, monumented, re-monumented, recovered, found as expressed below:

NOTE: Not more than 4 corners, all in the same town and range, may be recorded on this certificate.

A. Description of original monument and accessories and/or subsequent restoration:

I-11 Northeast Corner of Section 34 Oceola Township was set by the GLO in 1823 by Sylvester Sibley.
The original witnesses are:

Spruce 14" S8 1/2°W 35 lks (23.1')
Spruce 16" S81°W 30 lks (19.8')

NOTE: NONE OF THE ORIGINAL WITNESSES COULD BE FOUND OR PERPETUATED
SEE THE BACK OF THIS SHEET FOR ADDITIONAL HISTORICAL DATA.

B. Description of corner evidence found and/or method applied in restoring or reestablishing corner:

I-11 Found 1/2" iron 3.0 feet west of the centerline of Argentine Road with old fence lines and tree rows running east and west.

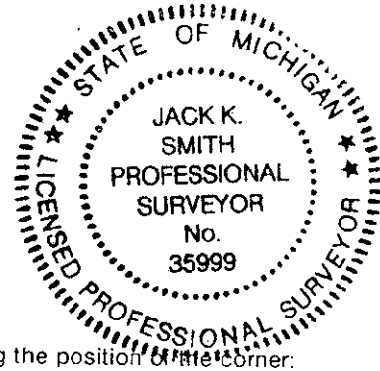

C. Description of monument for corner and accessories established to perpetuate locating the position of the corner:

I-11 Northeast Corner, Section 34, T3N, R5E
Set 30" x 1 1/4" iron pipe with 6" x 1 1/4" break-off and brass cap marked as "Livingston County Monumentation Corner" 3.0 feet west of Argentine Road centerline.

N15°E Set nail and remon tag in W side twin 20" Maple 109.92'
N15°W Set nail and remon tag in E side 28" Maple 98.53'
N50°W Set nail and remon tag in SW side 24" Maple 50.02'
S35°W Set nail and remon tag in SE side 26" Oak 26.90'

Signed by [Signature] Date June 20, 1996
Surveyor's Michigan License No. 35999

June 6, 1996

I-11 T3N - R5E: Northeast Corner, Section 34, Oceola Township

We found a 1/2" iron in the centerline of Argentine Road. There are old fence lines and tree rows east and west. This corner was reported as being set by Sibley in 1823 for the GLO. There is an Act 74 filed by Boss(1972) with witnesses that can still be traced to the present time. All recorded adjoining section line distances that I could find agreed well with current measure with the exception of a 1987 Boss dimension to the west which appears to indicate a second location for the North 1/4 Corner of Section 34. A sweep of the area near this location did not reveal any other corner markers. Considering the perpetuation of this corner since 1971 and the widespread acceptance of this corner by local surveyors I recommend acceptance of the current location with the replacement of the existing iron with a standard Livingston County Remonumentation monument. This corner is heavily masked for GPS occupation by trees and is probably not occupiable with GPS equipment.

Jack K. Smith, PS
Desine Inc.

