

**SURVEY &
REMONUMENTATION**

1993

COMMISSION

**LAND CORNER RECORDATION CERTIFICATE
Filing Requirement of Act 74, Mich. P.A. 1970**

Dec 28 4 35 PM '93
NANCY HAVLAND
REGISTER OF DEEDS
LIVINGSTON COUNTY, MI
48843

FILED

For corners in

LIVINGSTON
(County)

Located In:

Corner Code #

- | | | |
|---------------------------------------|-------------------------|-------------|
| 1. Public Land Survey | T <u>3N</u> R <u>5E</u> | <u>K-13</u> |
| | T _____ R _____ | _____ |
| | T _____ R _____ | _____ |
| | T _____ R _____ | _____ |
| 2. Property Controlling
in Section | S _____ T _____ R _____ | _____ |
| | S _____ T _____ R _____ | _____ |
| 3. Miscellaneous
Property in Sec. | S _____ T _____ R _____ | _____ |
| | S _____ T _____ R _____ | _____ |

L.S.C. #156m
Register of Deeds Stamp & File Number

4. Lot No. _____, Recorded Plat _____
5. Private Claims _____

A	B	C	D	E	F	G	H	I	J	K	L	M
2	6	5	4	3	2	1						
3												
4	7	8	9	10	11	12						
5												
6	18	17	16	15	14	13						
7												
8	19	20	21	22	23	24						
9												
10	30	29	28	27	26	25						
11												
12	31	32	33	34	35	36						
13												

I, MARY A. BARNWELL, in a field survey on December 06, 19 93, do hereby certify that under requirements of P.A. 74, Michigan P.A. of 1970, the corner points mentioned in lines 1 and 2 above were in conformance with regulations and rules therefore as required in the current manual of survey instructions of the United States Department of the Interior, Bureau of Land Management or by a decree of a Court of Law and/or that the corner points mentioned in lines 3, 4 and 5 above were in conformance with the rules of the Michigan Board of Land Surveyors or by a Decree of a Court of Law; established, re-established, monumented, re-monumented, recovered, found as expressed below:

NOTE: Not more than 4 corners, all in the same town and range, may be recorded on this certificate.

A. Description of original monument and accessories and/or subsequent restoration:

K-13 The Southwest Corner of Section 36, Oceola Township was set by the GLO in 1815 by Joseph Wampler.
The original witnesses are:
W. Oak 18" N32W 48 lks
W. Oak 24" S46W 39 lks

NOTE: NONE OF THE ORIGINAL WITNESSES COULD BE FOUND OR PERPETUATED SEE THE BACK OF THIS SHEET FOR ADDITIONAL HISTORICAL DATA.

B. Description of corner evidence found and/or method applied in restoring or reestablishing corner:

K-13 Found 3/8" iron rod on centerline of Golf Club Road and 7'+/- west of the centerline of Kellogg Road to the north. All known surveys since 1974 by Boss and Desine appear to be tied to this same corner location.

NOTE: See the Dossier as filed for the Livingston County Remonumentation Program for additional information concerning this corner.

C. Description of monument for corner and accessories established to perpetuate locating the position of the corner:

Southwest, Section 36, T3N, R5E
Set 30" x 1 1/4" iron pipe with 6" break-off pipe and brass cap marked as "Livingston County Monument Corner"
N37°E Nail and tag in NW side Tw. 12" Box Elder 24.08'
S56°E 36" x 1" iron pipe with brass "Witness" cap 33.57'
S58°W NE corner brick fiber optics building 141.54'
S80°W Nail and tag in N side 8" Ash 101.35'
N12°W Nail and tag in NE side Tw. 8" Ash 108.06'

APPROVED BY THE LIVINGSTON COUNTY MONUMENTATION PEER GROUP OCT. 13 1993.

Signed by Mary A. Barnwell Date DECEMBER 24, 1993
Surveyor's Michigan License No. 33971
No. 33971

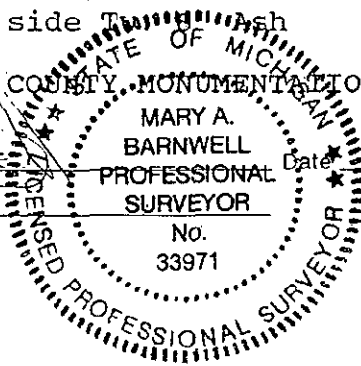

October 13, 1993

K-13, T3N, R5E: SOUTHWEST CORNER, SECTION 36, OCEOLA TOWNSHIP

Found 3/8" Iron Rod on centerline of East - West road, 7 ft +/- West of centerline road to North. Benton witness records indicate "Iron Pipe by Cole - 1960" with witnesses matching those used from the mid - 70's to present. All known surveys since 1974 by Boss and Desine appear to be tied to the same corner location. A sweep of the area found no additional irons. Closing corner (?) falls at intersection of centerlines road to South. I recommend accepting the Southwest Corner at the location as is presently monumented.

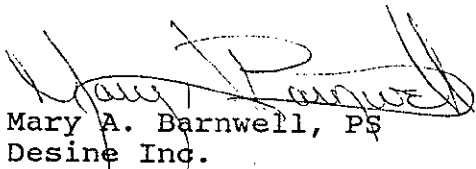
Mary A. Barnwell, P.S.
Desine Inc.

