

SURVEY & REMONUMENTATION

1993

COMMISSION

LAND CORNER RECORDATION CERTIFICATE
 Filing Requirement of Act 74, Mich. P.A. 1970

Dec 28 4 35 PM '93
 NANCY HAVILAND
 REGISTER OF DEEDS
 LIVINGSTON COUNTY, MI
 48843

FILED

For corners in

<u>LIVINGSTON</u> (County)	Located In:	Corner Code #
1. Public Land Survey	T <u>3N</u> R <u>5E</u>	<u>L-11</u>
	T _____ R _____	_____
	T _____ R _____	_____
	T _____ R _____	_____
2. Property Controlling in Section	S _____ T _____ R _____	_____
	S _____ T _____ R _____	_____
3. Miscellaneous Property in Sec.	S _____ T _____ R _____	_____
	S _____ T _____ R _____	_____
4. Lot No. _____, Recorded Plat _____		
5. Private Claims _____		

L.S.C. #157m
 Register of Deeds Stamp & File Number

A	B	C	D	E	F	G	H	I	J	K	L	M
2	6	5	4	3	2	1						
3												
4	7	8	9	10	11	12						
5												
6	18	17	16	15	14	13						
7												
8	19	20	21	22	23	24						
9												
10	30	29	28	27	26	25						
11												
12	31	32	33	34	35	36						
13												

MARY A. BARNWELL
 I, _____, in a field survey on DECEMBER 06, 19 93
 do hereby certify that under requirements of P.A. 74, Michigan P.A. of 1970, the corner points mentioned
 in lines 1 and 2 above were in conformance with regulations and rules therefore as required in the
 current manual of survey instructions of the United States Department of the Interior, Bureau of Land
 Management or by a decree of a Court of Law and/or that the corner points mentioned in lines 3, 4 and 5
 above were in conformance with the rules of the Michigan Board of Land Surveyors or by a Decree of a
 Court of Law; established, re-established, monumented, re-monumented, recovered, found as
 expressed below:

**NOTE: Not more than 4 corners, all in the same town and range, may be recorded
 on this certificate.**

A. Description of original monument and accessories and/or subsequent restoration:

L-11 The North 1/4 Corner of Section 36, Oceola Township was set by the GLO
 in 1815 by Joseph Wampler.
 The original witnesses are:
 W. Oak 18" S39W 50 lks
 W. Oak 14" S54 1/2E 49 lks

**NOTE: NONE OF THE ORIGINAL WITNESSES COULD BE FOUND OR PERPETUATED
 SEE THE BACK OF THIS SHEET FOR ADDITIONAL HISTORICAL DATA.**

B. Description of corner evidence found and/or method applied in restoring or reestablishing corner:

L-11 Found 1/2" iron rod on centerline of Bergin Road. All known surveys
 since 1973 by Benton, Kostecke, and Garlock appear to be tied to this same
 corner location.

**NOTE : SEE DOSSIER AS FILED FOR THE LIVINGSTON COUNTY
 REMONUMENTATION PROGRAM FOR ADDITIONAL INFORMATION
 CONCERNING THIS CORNER.**

C. Description of monument for corner and accessories established to perpetuate locating the position of the corner:

North 1/4 Corner Section 36, T3N, R5E
 Set 30" x 1 1/4" iron pipe with 6" break-off pipe and brass cap marked as
 "Livingston County Monument Corner"
 N35°W Nail and tag in SW side 16" Cherry 24.08'
 S63°W Nail and tag in N side 18" Cherry 38.15'
 N60°E Nail and tag in SE side 20" Ash 28.46'
 S50°E Nail and tag in N side 34" Oak 32.66'

APPROVED BY THE LIVINGSTON COUNTY MONUMENTATION PEER GROUP OCT. 20 1993.

Signed by Mary A. Barnwell
 Surveyor's Michigan License No. 33971

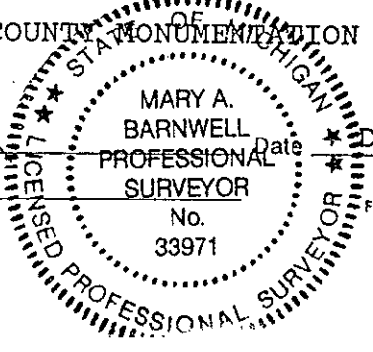

Date DECEMBER 24, 1993

October 20, 1993

L-11, T3N, R5E: NORTH 1/4 CORNER, SECTION 36, OCEOLA TOWNSHIP

Found 1/2" Iron Rod on road centerline +/- . In 1874 Bullock noted the corner location on line and at half distance between the Northwest corner location and the Northeast corner location (County Surveyor's Survey No.21). In 1973 Kostecke reported setting an iron at the corner location. The iron was re-set by Benton from Kostecke witnesses in 1975. There is no strong occupation today in the area. A fenceline does run North from Kostecke's iron location, but is not believed to be very old. All known surveys in area (Kostecke, Benton and Garlock) appear to be tied to Kostecke's 1973 corner location. Excavation of the immediate area found no other corner evidence and no additional irons. I recommend accepting the North 1/4 Corner at the location as is presently monumented.

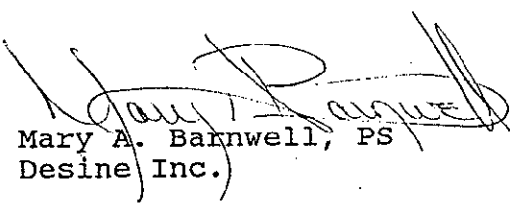
Mary A. Barnwell, PS
Desine Inc.)

