

Survey &
REMONUMENTATION

1993

COMMISSION

LAND CORNER RECORDATION CERTIFICATE
Filing Requirement of Act 74, Mich. P.A. 1970

For corners in

<u>LIVINGSTON</u> <small>(County)</small>	Located In:	Corner Code #
1. Public Land Survey	T <u>3N</u> R <u>5E</u>	<u>L-13</u>
	T _____ R _____	_____
	T _____ R _____	_____
	T _____ R _____	_____
2. Property Controlling in Section	S _____ T _____ R _____	_____
	S _____ T _____ R _____	_____
3. Miscellaneous Property in Sec.	S _____ T _____ R _____	_____
	S _____ T _____ R _____	_____
4. Lot No. _____, Recorded Plat _____		
5. Private Claims _____		

FILED
 DEC 27 12 30 PM '93
 NANCY HAVILLANT
 REGISTER OF DEEDS
 LIVINGSTON COUNTY, MI
 48843
 L.S.C.# 97m
 Register of Deeds Stamp & File Number

A	B	C	D	E	F	G	H	I	J	K	L	M
2	6	5	4	3	2	1						
3												
4	7	8	9	10	11	12						
5												
6	18	17	16	15	14	13						
7												
8	19	20	21	22	23	24						
9												
10	30	29	28	27	26	25						
11												
12	31	32	33	34	35	36						
13												

I, JACK K. SMITH, in a field survey on DECEMBER 13, 19 93, do hereby certify that under requirements of P.A. 74, Michigan P.A. of 1970, the corner points mentioned in lines 1 and 2 above were in conformance with regulations and rules therefore as required in the current manual of survey instructions of the United States Department of the Interior, Bureau of Land Management or by a decree of a Court of Law and/or that the corner points mentioned in lines 3, 4 and 5 above were in conformance with the rules of the Michigan Board of Land Surveyors or by a Decree of a Court of Law; established, re-established, monumented, re-monumented, recovered, found as expressed below:

NOTE: Not more than 4 corners, all in the same town and range, may be recorded on this certificate.

A. Description of original monument and accessories and/or subsequent restoration:

L-13 The South 1/4 Corner of Section 36, Oceola Township was set by the GLO in 1815 by Joseph Wampler.
The original witnesses are:
B. Oak 12" S61E 36 lks
W. Oak 8" S72W 45 lks

NOTE: NONE OF THE ORIGINAL WITNESSES COULD BE FOUND OR PERPETUATED
SEE THE BACK OF THIS SHEET FOR ADDITIONAL HISTORICAL DATA.

B. Description of corner evidence found and/or method applied in restoring or reestablishing corner:

L-13 Found 1/2" iron 5 feet north of centerline of Golf Club Road.
AN ADDITIONAL IRON WAS FOUND 5.06 FEET SOUTH OF AFFOREMENTIONED IRON.

NOTE : SEE THE DOSSIER AS FILED FOR THE LIVINGSTON COUNTY
REMONUMENTATION PROGRAM FOR ADDITIONAL INFORMATION
CONCERNING THIS CORNER.

C. Description of monument for corner and accessories established to perpetuate locating the position of the corner:

South 1/4 Corner Section 36, T3N, R5E
Set 30" x 1 1/4" iron pipe with 6" break-off pipe and brass cap marked as "Livingston County Monument Corner"
N60°W Nail and tag in SW side 28" Oak 49.48'
S56°W Nail and tag in N side 24" Oak 63.28'
S04°E Nail and tag in W side 26" Ash 28.15'
S50°E Nail and tag in NE side 18" Hickory 38.78'

APPROVED BY THE LIVINGSTON COUNTY MONUMENTATION PEER GROUP DECEMBER 11, 1993.

Signed by [Signature] Date DECEMBER 24, 1993
Surveyor's Michigan License No. 35999

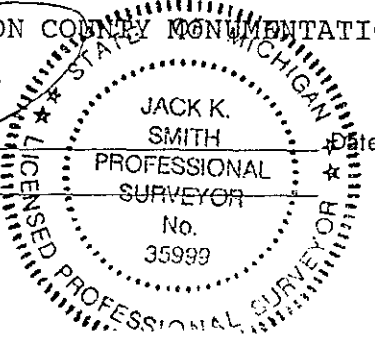

L-13 - SOUTH 1/4 CORNER SECTION 36, T3N, R6E, OCEOLA TOWNSHIP

SUMMARY:

There are two 1/2" irons which have been used over the last 15 years or so to mark the location of the South 1/4 Corner. They lie 5.06 feet apart and directly north and south of one another. The northerly iron measures 33.0 feet south of an iron at the corner of a cyclone fence, but approximately 5 feet north of the centerline of Golf Club Road.

The first recorded (and dated) use of either of these irons we could find was on a 1971 survey by David Finney (2), although it would appear that an undated survey by Pike Engineering (1) may predate the Finney work. The survey by Pike shows the South 1/4 Corner to be at the halfway point on the line between the SE and SW Corners of Section 36, with no deflection shown at the South 1/4 Corner. The survey by Finney shows the same distance to the SE Corner as Pike, as well as a found iron 990 feet north of the South 1/4 Corner which correlates with the NW corner of the Pike parcel. There is an iron set by Gary Boss in 1992 which falls very near the 1/2 distance point, 1.47 feet north of the straight line location from the SE to the SW Corners.

In 12 different surveys by Boss Engineering, the North 1/4 Corner of Section 1 Genoa has been used to control the direction of the South line of Section 36, with a jog then shown to continue easterly to the South 1/4 Corner on some surveys, and some of the surveys only showing the line extended to the North 1/4 Corner.

Beginning in 1977, Boss shows a found South 1/4 Corner that is 5.06 feet South of a "calculated" location. It would appear that this "calculated" location was arrived at by computation from found irons lying northerly of the South 1/4 Corner (3). I could find no evidence to indicate who set this southerly iron, but Boss field notes (4) call for a 1/2" iron with beatup cap. This point falls within 0.1 feet of an extension of line from the Southwest Corner of Section 36 through the North 1/4 Corner of Section 1, Genoa Township. The southerly iron fits road centerline well.

In 1992 Gary Boss set a South 1/4 Corner at the "calculated" location and witnesses a found iron 5.06 feet South.

There is a relatively new cyclone fence running north from the 2 irons at this location.

It appears that the northerly location predates the southerly, and would appear to have been set by an acceptable method, therefore I recommend using the northerly iron as set and witnessed by Boss.

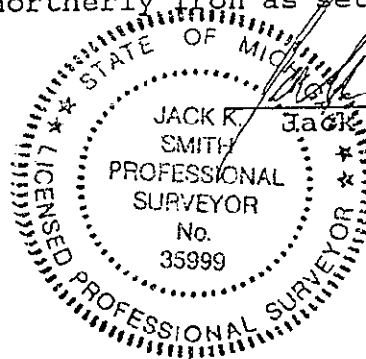

Jack K. Smith, PS