

SURVEY & REMONUMENTATION

OCT 21 1999

SECTION

LAND CORNER RECORDATION CERTIFICATE
Filing Requirement of Act 74, Mich. P.A. 1970

DEC 28 4 35 PM '93
 NANCY HAVILAND
 REGISTER OF DEEDS
 LIVINGSTON COUNTY, MI
 48843

For corners in

LIVINGSTON
 (County)

Located In:

Corner Code #

- | | | |
|------------------------------------|-------------------------|-------------|
| 1. Public Land Survey | T <u>3N</u> R <u>6E</u> | <u>A-13</u> |
| | T _____ R _____ | _____ |
| | T _____ R _____ | _____ |
| | T _____ R _____ | _____ |
| 2. Property Controlling in Section | S _____ T _____ R _____ | _____ |
| | S _____ T _____ R _____ | _____ |
| 3. Miscellaneous Property in Sec. | S _____ T _____ R _____ | _____ |
| | S _____ T _____ R _____ | _____ |

L.S.C. #150m
 Register of Deeds Stamp & File Number

4. Lot No. _____, Recorded Plat _____
 5. Private Claims _____

A	B	C	D	E	F	G	H	I	J	K	L	M
2	6	5	4	3	2	1						
3												
4	7	8	9	10	11	12						
5												
6	18	17	16	15	14	13						
7												
8	19	20	21	22	23	24						
9												
10	30	29	28	27	26	25						
11												
12	31	32	33	34	35	36						
13												

MARY A. BARNWELL

in a field survey on DECEMBER 6, 19 93

do hereby certify that under requirements of P.A. 74, Michigan P.A. of 1970, the corner points mentioned in lines 1 and 2 above were in conformance with regulations and rules therefore as required in the current manual of survey instructions of the United States Department of the Interior, Bureau of Land Management or by a decree of a Court of Law and/or that the corner points mentioned in lines 3, 4 and 5 above were in conformance with the rules of the Michigan Board of Land Surveyors or by a Decree of a Court of Law; established, re-established, monumented, re-monumented, recovered, found as expressed below:

NOTE: Not more than 4 corners, all in the same town and range, may be recorded on this certificate.

A. Description of original monument and accessories and/or subsequent restoration:

A-13 The Southwest Corner of Section 31, Hartland Township was set by the GLO in 1815 by Joseph Wampler.
 The original witnesses are:
 W. Oak 18" S-E 31 lks
 B. Oak 12" N 1.05 lks

NOTE: NONE OF THE ORIGINAL WITNESSES COULD BE FOUND OR PERPETUATED SEE THE BACK OF THIS SHEET FOR ADDITIONAL HISTORICAL DATA.

B. Description of corner evidence found and/or method applied in restoring or reestablishing corner:

A-13 Found Nail in pipe in monument box at centerline intersection of Golf Club Road and Hacker Road to the west.

NOTE : SEE THE DOSSIER AS FILED FOR THE LIVINGSTON COUNTY REMONUMENTATION PROGRAM FOR ADDITIONAL INFORMATION CONCERNING THIS CORNER.

C. Description of monument for corner and accessories established to perpetuate locating the position of the corner:

Southwest Corner, Section 31, T3N, R6E
 Set 30" x 1 1/4" iron pipe with 6" break-off pipe and brass cap marked as "Livingston County Monument Corner"
 S56°W Nail and tag in NW side multiple 8" Maple 37.71'
 N20°E Nail and tag in NW side 12" Oak 102.75'
 N78°E Nail and tag in N side Tw. 8" Oak 62.69'
 S78°E Nail and tag in S side Tw. 8 and 12" Apple 60.60'

APPROVED BY THE LIVINGSTON COUNTY MONUMENTATION PEER GROUP OCT. 13 1993.

Signed by [Signature] Date DECEMBER 24, 1993

Surveyor's Michigan License No. 33971

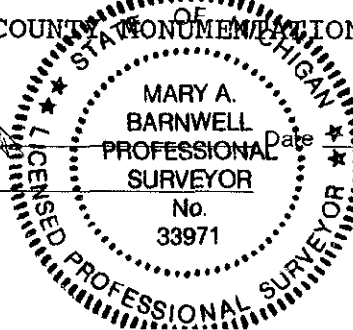

ALTERED

DEC 28 4 32 PM '93

October 13, 1993

A-13, T3N, R6E: SOUTHWEST CORNER, SECTION 31, HARTLAND TOWNSHIP

Found nail in pipe in monument box at intersection of centerline North - South road with road to West. No occupation to the East. All known surveys since 1943 by Gordon, Garlock, Boss and Desine appear to be tied to the same corner location. All known survey records indicate that this is a common Township corner. A sweep of the area found no additional irons. Based upon occupational evidence, previous usage and long standing acceptance, I recommend approving the location of the corner at the point as currently marked.

Mary A. Barnwell, PS
Desine Inc.



**SURVEY &
REMONUMENTATION**

OCT 21 1999

SECTION