

MAR 17 2000

FILED

SECTION

LAND CORNER RECORDATION CERTIFICATE
Filing Requirement of Act 74, Mich. P.A. 1970

1999 JUL 29 P 12:27

NANCY HAVILAND
REGISTER OF DEEDS
LIVINGSTON COUNTY, MI.
48843

For corners in
LIVINGSTON
(County)

Located in:	Corner Code #
T 3N R 6E	F11
T R	
T R	
T R	
S T R	
S T R	
S T R	
S T R	

CLS # 1045m
Register of Deeds Stamp & File Number

4. Lot No. _____, Recorded Plat _____
5. Private Claims _____

I, CHARLES E GARLOCK, in a field survey on JULY 14, 1999 do hereby state that under requirements of P.A. 74, Michigan P.A. of 1970, the corner points mentioned in lines 1 and 2 above were in conformance with regulations and rules therefore as required in the current manual of survey instructions of the United States Department of the Interior, Bureau of Land Management or by a decree of a Court of Law and /or that the corner points mentioned in lines 3, 4 and 5 above were in conformance with the rules of the Michigan Board of Land Surveyors or by a Decree of a Court of Law, established, re-established, monumented, recovered, found as expressed below.

NOTE: Not more than 2 corners, all in the same town and range, may be recorded on this certificate.

1	A	B	C	D	E	F	G	H	I	J	K	L	M
2		6		5		4		3		2		1	
3													
4		7		8		9		10		11		12	
5													
6		18		17		16		15		14		13	
7													
8		19		20		21		22		23		24	
9													
10		30		29		28		27		26		25	
11													
12		31		32		33		34		35		36	
13													

A. Description of original monument and accessories and/or subsequent restoration:

GLO SURVEY DATED: MAY 24, 1823 BY S SIBLEY AND NONE OF THE GLO WITNESSES REMAIN.
GLO WITNESSES WO 10-S86E-24.42'
WO 8-N25E-29.70'

B. Description of corner evidence found and/or method applied in restoring or reestablishing corner:

DOUBLE CORNER FOUND, MDOT SET A BOAT SPIKE ABOUT 1963 FOR THE SOUTH 1/4 NEAR THE SPLIT OF THE MILE BETWEEN SECTION CORNERS, BUT COULD NOT FIND SURVEY DATA AS TO WHY THEY SET IT WHERE THEY DID. WE FOUND A STEEL POST SET IN CONCRETE 11.58 FEET SOUTH AND 653.84 FEET EAST OF THE MDOT CORNER WITH VERY OLD OCCUPATION LINES RUNNING TO THE SOUTHWEST AND SOUTHEAST, WE ALSO FOUND A CHAIN OF SURVEY DATA DATING BACK TO 1847 TO THE CORNER SET AT THE STEEL POST IN CONCRETE. LYLE W MUNSELL, RLS, HAD TOLD MDOT IN THE 1960'S THAT THE CORNER THEY HAD SET WAS INCORRECT, BASED ON SURVEY DATA MUNSELL HAD IN HIS OFFICE DATING BACK TO 1847 AND THAT THE CORNER 654 FEET TO THE EAST WAS THE CORRECT CORNER AS PER GLO NOTES.

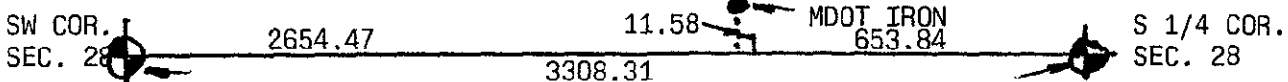

C. Description of monument for corner and accessories established to perpetuate locating the position of the corner:

F-11: S 1/4 COR. SEC. 28 T3N-R6E, HARTLAND TWP. LIV. CO. MI. SET 1/2" X 18" I. ROD IN CONCRETE AT BASE OF STEEL POST WITH LIV. CO. REMON. BRASS CAP ON TOP.
S20W-23.71'-SP & TAG W/S 7" ASH
S45E-4.69'-SP & TAG N/S 16" CHERRY
EAST-28.87'-SP & TAG N/S FORKED 30" MAPLE
N50E-42.10'-SP & TAG S/S 14" MAPLE
SET CARSONITE POST NEXT TO IRON ROD AND BRASS CAP.

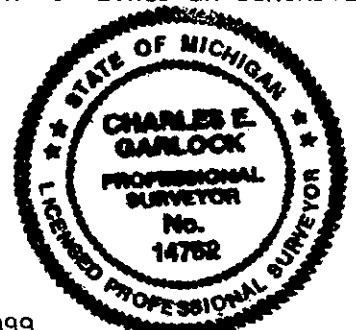

Signed by Charles E. Garlock
Surveyor's Michigan License No. 14762

Date JULY 19, 1999

P.A. 345 1990, APPROVED BY LIVINGSTON COUNTY
PEER GROUP ON 6-16-1999 CO. REP VED

FORM APPROVED BY MICHIGAN STATE BOARD OF PROFESSIONAL SURVEYORS, JAN. 28, 1971
REVISED MAY 14, 1975
REVISED JAN., 1983
REVISED OCT., 1995