

SURVEY & REMONUMENTATION

FEB 25 1999

FILED

SECTION

LAND CORNER RECORDATION CERTIFICATE
Filing Requirement of Act 74, Mich. P.A. 1970

For corners in

<u>LIVINGSTON</u> (County)	Located In:	Corner Code #
1. Public Land Survey	T <u>3N</u> R <u>6E</u>	<u>G4</u>
	T _____ R _____	_____
	T _____ R _____	_____
	T _____ R _____	_____
2. Property Controlling in Section	S _____ T _____ R _____	_____
	S _____ T _____ R _____	_____
3. Miscellaneous Property in Sec.	S _____ T _____ R _____	_____
	S _____ T _____ R _____	_____

1998 OCT 20 P 1:21

NANCY HAVILAND
REGISTER OF DEEDS
LIVINGSTON COUNTY, MI.
48843

LSC928M

Register of Deeds Stamp & File Number

4. Lot No. _____, Recorded Plat _____
5. Private Claims _____

I, MARY BARNWELL, in a field survey on SEPT 17, 1998, do hereby state that under requirements of P.A. 74, Michigan P.A. of 1970, the corner points mentioned in lines 1 and 2 above were in conformance with regulations and rules therefore as required in the current manual of survey instructions of the United States Department of the Interior, Bureau of Land Management or by a decree of a Court of Law and /or that the corner points mentioned in lines 3, 4 and 5 above were in conformance with the rules of the Michigan Board of Land Surveyors or by a Decree of a Court of Law; established, re-established, monumented, recovered, found as expressed below:

NOTE: Not more than 2 corners, all in the same town and range, may be recorded on this certificate.

	A	B	C	D	E	F	G	H	I	J	K	L	M
1													
2		6		5		4		3		2		1	
3													
4		7		8		9		10		11		12	
5													
6		18		17		16		15		14		13	
7													
8		19		20		21		22		23		24	
9													
10		30		29		28		27		26		25	
11													
12		31		32		33		34		35		36	
13													

A. Description of original monument and accessories and/or subsequent restoration:
GLO SURVEY DATED MAY 24, 1823, BY S. SIBLEY, DS
GLO WITNESSES WO 6-N2E-10.56'
WO 6-S36E-2.64'

B. Description of corner evidence found and/or method applied in restoring or reestablishing corner:
FOUND 1/2" I. ROD, 4' LONG, IN CENTER OF OLD FENCE POST HOLE RUNG WITH STONES AND WITH FENCES LINES RUNNING SOUTH EAST WEST AND NORTH.

C. Description of monument for corner and accessories established to perpetuate locating the position of the corner:
G4: W 1/4 COR. SEC. 10 T3N-R6E HARTLAND TWP. LIV. CO. MI, REPLACED 1/2" I. ROD WITH 1 1/4" X 36" I. PIPE WITH LIV. CO. REMON BRASS CAP ON TOP.
N8E-26.91'-SP & TAG W/S 16" MAPLE
S60E-11.93'-SP & TAG SW/S 8" OAK
S20E-34.79'-SP & TAG E/S 11" HICKORY
SOUTH-7.89'-SP & TAG E/S 10" OAK
WEST-2.45'-FACE OF RR TIE POST.

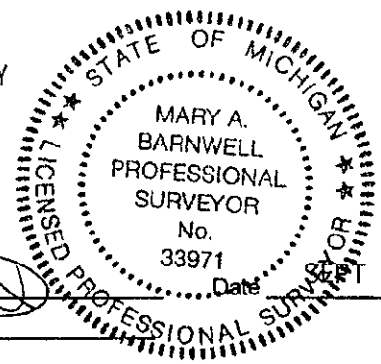

Signed by [Signature]
Surveyor's Michigan License No. 33971

Date SEPT 21, 1998