

FEB 25 1999

FILED

SECTION

LAND CORNER RECORDATION CERTIFICATE  
Filing Requirement of Act 74, Mich. P.A. 1970

For corners in

<u>LIVINGSTON</u> (County)	Located In:	Corner Code #
1. Public Land Survey	T <u>3N</u> R <u>6E</u>	<u>G7</u>
	T___ R___	_____
	T___ R___	_____
	T___ R___	_____
2. Property Controlling in Section	S___ T___ R___	_____
	S___ T___ R___	_____
3. Miscellaneous Property in Sec.	S___ T___ R___	_____
	S___ T___ R___	_____

1998 OCT 20 P 1:22

NANCY HAVILAND  
REGISTER OF DEEDS  
LIVINGSTON COUNTY, MI.  
48843

LSC932M

Register of Deeds Stamp & File Number

- 4. Lot No. \_\_\_\_\_, Recorded Plat \_\_\_\_\_
- 5. Private Claims \_\_\_\_\_

I, MARY BARNWELL, in a field survey on AUG 20, 1998 do hereby state that under requirements of P.A. 74, Michigan P.A. of 1970, the corner points mentioned in lines 1 and 2 above were in conformance with regulations and rules therefore as required in the current manual of survey instructions of the United States Department of the Interior, Bureau of Land Management or by a decree of a Court of Law and /or that the corner points mentioned in lines 3, 4 and 5 above were in conformance with the rules of the Michigan Board of Land Surveyors or by a Decree of a Court of Law; established, re-established, monumented, recovered, found as expressed below:

NOTE: Not more than 2 corners, all in the same town and range, may be recorded on this certificate.

1	A	B	C	D	E	F	G	H	I	J	K	L	M
2		6		5		4		3		2		1	
3													
4		7		8		9		10		11		12	
5													
6		18		17		16		15		14		13	
7													
8		19		20		21		22		23		24	
9													
10		30		29		28		27		26		25	
11													
12		31		32		33		34		35		36	
13													

A. Description of original monument and accessories and/or subsequent restoration:  
GLO SURVEY DATED MAY 24, 1823 BY S SIBLEY AND NONE OF THE GLO WITNESSES REMAIN.  
GLO WITNESSES: W024-N74W-9.9'  
W016-N72E-7.26'

B. Description of corner evidence found and/or method applied in restoring or reestablishing corner:  
FOUND 1/2" I. ROD ON C/L ROAD TO SOUTH AND 6' SOUTH OF EAST-WEST ROAD C/L

C. Description of monument for corner and accessories established to perpetuate locating the position of the corner:  
G7: SW CORNER SECTION 15 T3N-R6E HARTLAND TOWNSHIP, LIVINGSTON COUNTY, MICHIGAN.  
REPLACED 1/2" I. ROD WITH 1 1/4" X 36" BREAKAWAY PIPE WITH LIV. REMON. BRASS CAP ON TOP.  
S80E-95.02'-SP & TAG N/S 24" OAK  
S70E-58.50'-SP & TAG N/S 8" WALNUT  
S15E-79.90'-SP & TAG W/S 2ND. 8" WALNUT

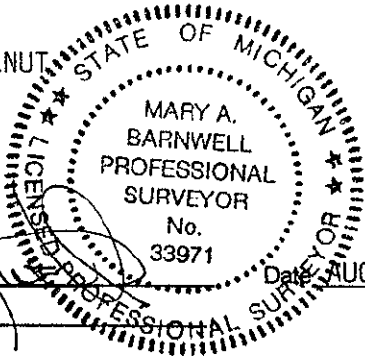

Signed by \_\_\_\_\_ Date AUGUST 21, 1998  
Surveyor's Michigan License No. 33971

PA. 345 1980, APPROVED BY LIVINGSTON COUNTY  
PEER GROUP ON 8-5-98 CO. REP JED