

FEB 25 1999

FILED

SECTION

LAND CORNER RECORDATION CERTIFICATE  
Filing Requirement of Act 74, Mich. P.A. 1970

For corners in

LIVINGSTON  
(County)

Located in:

Corner Code #

- 1. Public Land Survey      T 3N R 6E      H5
- T    R
- T    R
- T    R
- 2. Property Controlling    S    T    R
- in Section                S    T    R
- 3. Miscellaneous            S    T    R
- Property in Sec.         S    T    R

1998 OCT 20 P 1:21

NANCY HAVILAND  
REGISTER OF DEEDS  
LIVINGSTON COUNTY, MI.  
48843

LSC930M

Register of Deeds Stamp & File Number

- 4. Lot No. \_\_\_\_\_, Recorded Plat \_\_\_\_\_
- 5. Private Claims \_\_\_\_\_

I, MARY BARNWELL, in a field survey on AUG20, 1998 do hereby state that under requirements of P.A. 74, Michigan P.A. of 1970, the corner points mentioned in lines 1 and 2 above were in conformance with regulations and rules therefore as required in the current manual of survey instructions of the United States Department of the Interior, Bureau of Land Management or by a decree of a Court of Law and/or that the corner points mentioned in lines 3, 4 and 5 above were in conformance with the rules of the Michigan Board of Land Surveyors or by a Decree of a Court of Law, established, re-established, monumented, recovered, found as expressed below:

NOTE: Not more than 2 corners, all in the same town and range, may be recorded on this certificate.

	A	B	C	D	E	F	G	H	I	J	K	L	M
1													
2	6		5		4		3		2		1		
3													
4	7		8		9		10		11		12		
5								●					
6	18		17		16		15		14		13		
7													
8	19		20		21		22		23		24		
9													
10	30		29		28		27		26		25		
11													
12	31		32		33		34		35		36		
13													

A. Description of original monument and accessories and/or subsequent restoration:  
GLO SURVEY DATED MAY 24, 1823 BY S SIBLEY AND NONE OF THE GLO WITNESSES REMAIN.  
GLO WITNESSES: W012-S77E-8.58'  
                          ASPEN12-S66½W-9.9'

B. Description of corner evidence found and/or method applied in restoring or reestablishing corner:  
FOUND 1/2" I. ROD INSIDE A MON. BOX ON C/L OF EAST-WEST ASPHALT ROAD.

C. Description of monument for corner and accessories established to perpetuate locating the position of the corner:  
H5: SOUTH 1/4 CORNER OF SECTION 10, T3N-R6E, HARTLAND TOWNSHIP, LIVINGSTON COUNTY MICHIGAN.  
REPLACED FOUND 1/2" I. ROD WITH 1 1/4" X 36" BREAKAWAY PIPE WITH LIVINGSTON COUNTY  
REMON. BRASS CAP ON TOP.  
S10W-34.10'-SP & TAG E/S 14" OAK  
S45W-43.76'-SP & TAG N/S 12" OAK  
N10W-55.85'-SP & TAG W/S U. POLE  
N75W-113.43'-SP & TAG S/S 18" FORKED PEAR TREE.

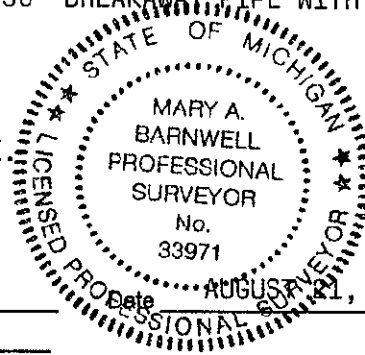

Signed by [Signature]  
Surveyor's Michigan License No. 33971

P.A. 345 1990, APPROVED BY LIVINGSTON COUNTY  
PEER GROUP ON 8-5-98, CO. REP JED