

LAND CORNER RECORDATION CERTIFICATE  
Filing Requirement of Act 74, Mich. P.A. 1970

For corners in

LIVINGSTON  
(County)

Located In:

Corner Code ://

1. Public Land Survey	T	3N	R	6E	I-07
	T		R		
	T		R		
	T		R		
2. Property Controlling in Section	S		T	R	
	S		T	R	
3. Miscellaneous Property in Sec.	S		T	R	
	S		T	R	

HARCY HAVILLAN  
REGISTER OF DEEDS  
LIVINGSTON COUNTY, MI  
48843

OCT 7 11 09 AM '96

FILED

L.S.C.#553M

Register of Deeds Stamp & File Number

4. Lot No. \_\_\_\_\_, Recorded Plat \_\_\_\_\_  
5. Private Claims \_\_\_\_\_

A	B	C	D	E	F	G	H	I	J	K	L	M
2	6	5	4	3	2	1						
3												
4	7	8	9	10	11	12						
5												
6	16	17	16	15	14	13						
7												
8	19	20	21	22	23	24						
9												
10	30	29	28	27	26	25						
11												
12	31	32	33	34	35	36						
13												

I, Jack K. Smith, in a field survey on June 20, 1996, do hereby certify that under requirements of P.A. 74, Michigan P.A. of 1970, the corner points mentioned in lines 1 and 2 above were in conformance with regulations and rules therefore as required in the current manual of survey instructions of the United States Department of the Interior, Bureau of Land Management or by a decree of a Court of Law and/or that the corner points mentioned in lines 3, 4 and 5 above were in conformance with the rules of the Michigan Board of Land Surveyors or by a Decree of a Court of Law; established, re-established, monumented, re-monumented, recovered, found as expressed below:

NOTE: Not more than 4 corners, all in the same town and range, may be recorded on this certificate.

A. Description of original monument and accessories and/or subsequent restoration:

I-07 The Southwest Corner of Section 14, Hartland Township was set by the GLO in 1823 by Sylvester Sibley.  
The original witnesses are:  
B Oak 10" N75°W 38 lk (25.1')  
B Oak 14" S81°E 66 lk (43.6')

NOTE: NONE OF THE ORIGINAL WITNESSES COULD BE FOUND OR PERPETUATED.  
SEE THE BACK OF THIS SHEET FOR ADDITIONAL HISTORICAL DATA.

B. Description of corner evidence found and/or method applied in restoring or reestablishing corner:

I-07 Found 1" solid iron (possibly a railroad spike?) 5 feet north of centerline of Dunham Road and on centerline of Bullard Road to the north (6.5 feet east of Bullard Road centerline to the south).

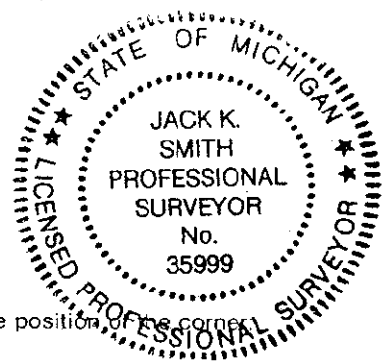

C. Description of monument for corner and accessories established to perpetuate locating the position of the corner:

I-07 Southwest Corner, Section 14, T3N, R6E  
Set 30" x 1 1/4" iron pipe with 6" x 1 1/4" break-off and brass cap marked as "Livingston County Monument Corner".

N45°W	Set witness pipe*	32.42'
N20°E	Set nail and tag in W side 8" Walnut	112.17'
S40°E	Set nail and tag in NE side 18" Oak	84.50'
S55°W	Set nail and tag in NW side 30" Willow	89.97'

\* 36" X 1" iron pipe with brass cap marked "Livingston County Remonumentation Witness"

Signed by *[Signature]* Date June 20, 1996

Surveyor's Michigan License No. 35999

April 12, 1996

**I-07 T3N - R6E: SOUTHWEST CORNER, SECTION 14, HARTLAND TOWNSHIP**

We found a 1" solid iron with a mushroomed top (possible railroad spike?) in the intersection of Bullard and Dunham Roads. The iron is 5 feet northerly of centerline and on centerline to the north (6.5 feet east of centerline to south). The corner was originally recorded as being set by S. Sibley in 1823. This corner is used as the northeast corner of "Hartland Country Club Subdivision" and checks well with existing monumentation. Witnesses have agreed on this corner since 1972, and measures compare well. There is a multiple corner at the Southwest Corner of Section 23 which accounts for the discrepancy of measure with MDOT and Boss on the West line of Section 23 (See Remon dossier for corner I-09). This corner is wide open for GPS and has decent sight distance for safe occupation. Based on the apparent perpetuation of the corner from 1972 to the present, and the usage for the aforementioned plat I recommend accepting I-07, the Southwest Corner of Section 14, at the location as is presently monumented.

  
Jack K. Smith, PS  
Desine Inc.

