

SURVEY & REMONUMENTATION

DEC 07 1994

COMMISSION

LAND CORNER RECORDATION CERTIFICATE

Filing Requirement of Act 74, Mich. P.A. 1970

SEP 15 8 59 AM '94
 NANCY HAVILAND
 REGISTER OF DEEDS
 LIVINGSTON COUNTY, MI
 48843

FILED

For corners in

LIVINGSTON
(County)

Located In:

Corner Code #

- | | | |
|------------------------------------|-------------------------|-------------|
| 1. Public Land Survey | T <u>3N</u> R <u>6E</u> | <u>K-10</u> |
| | T _____ R _____ | _____ |
| | T _____ R _____ | _____ |
| | T _____ R _____ | _____ |
| 2. Property Controlling in Section | S _____ T _____ R _____ | _____ |
| | S _____ T _____ R _____ | _____ |
| 3. Miscellaneous Property in Sec. | S _____ T _____ R _____ | _____ |
| | S _____ T _____ R _____ | _____ |

L.S.C. #270m
Register of Deeds Stamp & File Number

4. Lot No. _____, Recorded Plat _____
 5. Private Claims _____

A	B	C	D	E	F	G	H	I	J	K	L	M
2	6	5	4	3	2	1						
3												
4	7	8	9	10	11	12						
5												
6	18	17	16	15	14	13						
7												
8	19	20	21	22	23	24						
9												
10	30	29	28	27	26	25						
11												
12	31	32	33	34	35	36						
13												

I, Jack K. Smith, in a field survey on September 7, 19 94, do hereby certify that under requirements of P.A. 74, Michigan P.A. of 1970, the corner points mentioned in lines 1 and 2 above were in conformance with regulations and rules therefore as required in the current manual of survey instructions of the United States Department of the Interior, Bureau of Land Management or by a decree of a Court of Law and/or that the corner points mentioned in lines 3, 4 and 5 above were in conformance with the rules of the Michigan Board of Land Surveyors or by a Decree of a Court of Law; established, re-established, monumented, re-monumented, recovered, found as expressed below:

NOTE: Not more than 4 corners, all in the same town and range, may be recorded on this certificate.

A. Description of original monument and accessories and/or subsequent restoration:

K-10 The West 1/4 Corner of Section 25, Hartland Township was set by the GLO in 1823 by S. Sibley.
 The original witnesses are:
 W. Oak 14" N62E 41 lks
 W. Oak 10" S63W 40 lks

NOTE: NONE OF THE ORIGINAL WITNESSES COULD BE FOUND OR PERPETUATED SEE THE BACK OF THIS SHEET FOR ADDITIONAL HISTORICAL DATA.

B. Description of corner evidence found and/or method applied in restoring or reestablishing corner:

K-10 Found 3/8" square solid iron matching CHMP description of monumentation, and matching previous witnesses. There are tree rows and fences to the east and west. The corner falls in the center of Pleasant Valley Road.

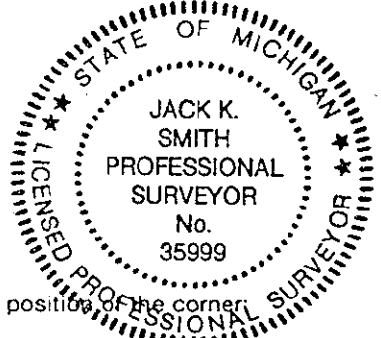

C. Description of monument for corner and accessories established to perpetuate locating the position of the corner:

- K-10 West 1/4 Corner, Section 25, T3N, R6E
 Set 36" x 1 1/4" iron pipe with brass cap marked as "Livingston County Monument Corner"
- | | | | |
|-------|------------------------|-----------|---------|
| S10°E | Nail and tag in N side | 24" Oak | 156.59' |
| EAST | Nail and tag in N side | 24" Apple | 26.49' |
| N86°E | Nail and tag in N side | 24" Maple | 43.10' |
| N20°E | Nail and tag in W side | 28" Maple | 52.94' |
| N11°E | Nail and tag in W side | 28" Maple | 95.35' |
| N15°W | Nail and tag in E side | 28" Maple | 92.59' |

Signed by Jack K. Smith Date September 10, 1994

Surveyor's Michigan License No. 35999

June 12, 1994

K-10 T3N - R6E: WEST 1/4 CORNER, SECTION 25, HARTLAND TOWNSHIP

Found 3/8" square solid iron matching CHMP description of monumentation, and matching previous witnesses. The corner was originally recorded as being set by S. Sibley in 1823. This corner is shown on old County surveyor notes with one witness from 1885 Bullock records. The first documented modern day usage is from an Act 74 from Douglas Hooth (1976) in which he calls for a found 3/8" iron rod as used by Bernard Feldhauser. Measured distance fit well with those shown on surveys of Boss (1980) and CHMP (1987), but we measured 17.72 feet shorter across the East-West 1/4 line to the east than the distance shown on a Garlock survey of 1979. There are tree rows and fences east and west and the corner falls in the center of Pleasant Valley Road. A sweep of the area did not reveal any additional irons. I recommend accepting K-10, the West 1/4 Corner of Section 25, at the location as is presently monumented by the 3/8" square iron and shown on the Act 74 of Hooth.

Jack K. Smith, PS
Desine Inc.

