

1993

COMMISSION

LAND CORNER RECORDATION CERTIFICATE
Filing Requirement of Act 74, Mich. P.A. 1970

HANCOCK HAYLAND
REGISTER OF DEEDS
LIVINGSTON COUNTY, MI
48843

DEC 27 12 30 PM '93

FILED

For corners in

LIVINGSTON
(County)

Located In:

Corner Code #

- 1. Public Land Survey T 3N R 6E L-13
- T _____ R _____
- T _____ R _____
- T _____ R _____
- 2. Property Controlling S _____ T _____ R _____
- in Section S _____ T _____ R _____
- 3. Miscellaneous S _____ T _____ R _____
- Property in Sec. S _____ T _____ R _____

L.S.C.# 94m

Register of Deeds Stamp & File Number

- 4. Lot No. _____, Recorded Plat _____
- 5. Private Claims _____

| | A | B | C | D | E | F | G | H | I | J | K | L | M |
|----|----|---|----|---|----|---|----|---|----|---|----|---|---|
| 2 | 6 | | 5 | | 4 | | 3 | | 2 | | 1 | | |
| 3 | | | | | | | | | | | | | |
| 4 | 7 | | 8 | | 9 | | 10 | | 11 | | 12 | | |
| 5 | | | | | | | | | | | | | |
| 6 | 18 | | 17 | | 16 | | 15 | | 14 | | 13 | | |
| 7 | | | | | | | | | | | | | |
| 8 | 19 | | 20 | | 21 | | 22 | | 23 | | 24 | | |
| 9 | | | | | | | | | | | | | |
| 10 | 30 | | 29 | | 28 | | 27 | | 26 | | 25 | | |
| 11 | | | | | | | | | | | | | |
| 12 | 31 | | 32 | | 33 | | 34 | | 35 | | 36 | | |
| 13 | | | | | | | | | | | | | |

I, JACK K. SMITH, in a field survey on DECEMBER 14, 19 93, do hereby certify that under requirements of P.A. 74, Michigan P.A. of 1970, the corner points mentioned in lines 1 and 2 above were in conformance with regulations and rules therefore as required in the current manual of survey instructions of the United States Department of the Interior, Bureau of Land Management or by a decree of a Court of Law and/or that the corner points mentioned in lines 3, 4 and 5 above were in conformance with the rules of the Michigan Board of Land Surveyors or by a Decree of a Court of Law; established, re-established, monumented, re-monumented, recovered, found as expressed below:

NOTE: Not more than 4 corners, all in the same town and range, may be recorded on this certificate.

A. Description of original monument and accessories and/or subsequent restoration:

L-13 The South 1/4 Corner of Section 36, Hartland Township was set by the GLO in 1815 by Joseph Wampler. The original witnesses are:
W. Oak 12" S21W 88 lks
W. Oak 18" N66W 112 lks

NOTE: NONE OF THE ORIGINAL WITNESSES COULD BE FOUND OR PERPETUATED SEE THE BACK OF THIS SHEET FOR ADDITIONAL HISTORICAL DATA.

B. Description of corner evidence found and/or method applied in restoring or reestablishing corner:

L-13 Set 1 1/4" iron pipe with 6" break-off pipe and brass cap marked as "Livingston County Monument Corner" in monument box. Corner was established by single proration between the Southwest and Southeast Corners of Section 36, T3N, R6E.

NOTE: SEE THE DOSSIER AS FILED FOR THE LIVINGSTON COUNTY REMONUMENTATION PROGRAM FOR ADDITIONAL INFORMATION CONCERNING THIS CORNER.

C. Description of monument for corner and accessories established to perpetuate locating the position of the corner:

South 1/4 Corner, Section 36, T3N, R6E
Set 30" x 1 1/4" iron pipe with 6" break-off pipe and brass cap marked as "Livingston County Monument Corner" in mon box
11' S of C/L Commerce Road
N55°W Nail and tag in SW side 30" Oak 62.45'
N72°E Nail and tag in S side 26" Oak 140.39'
S76°E Nail and tag in N side 26" Cherry 56.94'
S64°W Nail and tag in N side 8" Cedar 34.23'

APPROVED BY THE LIVINGSTON COUNTY MONUMENTATION PEER GROUP ~~NOVEMBER 16~~, 1993.

Signed by [Signature] Date DECEMBER 24, 1993

Surveyor's Michigan License No. 35999

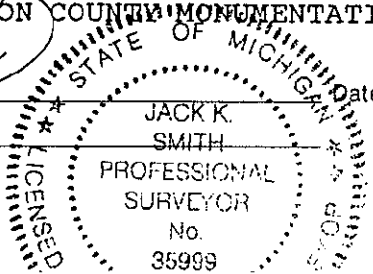

L-13 - SOUTH 1/4 CORNER SECTION 36, T3N, R6E, HARTLAND TOWNSHIP

SUMMARY:

The Boss Engineering survey of July 1972 shows no evidence of the existence of a South 1/4 Corner. In their survey, a straight line was run from the SW Corner to the SE Corner. A subsequent job by Boss in 1987 shows the South 1/4 Corner to be at the Southeast Corner of Parcel "1" of the 1972 work. Reproducing this location from found irons agrees within 0.2 feet with the line between the SE and SW Corners. There is not an iron at the location called for by Boss, and it falls approximately 11 feet south and 5 feet east of the North 1/4 Corner iron. After reviewing the notes of the 1987 survey by Boss Engineering it is found that no mention is made of finding the iron at the South 1/4 Corner as shown on the plat of survey, or any witnesses as shown on said drawing. This call on the drawing may have come from a draftsman error since no evidence can be found of the existence of an iron. The GLO falling would put the South 1/4 Corner 17.82 feet east of the North 1/4 Corner of Section 1 Brighton, although no apparent jog exists at the Southwest Corner of Section 36. The South 1/4 Corner was called for in a survey by David C. Adams in 1984, however his witnesses measure well to the North 1/4 Corner of Section 1, Brighton Township. Cornerstone Surveying split the westerly part of the Adams parcel in 1990 using the same bearings, distances, and witnesses as Adams. In looking at the "Boss" location for the South 1/4 Corner it falls southerly of the pavement on Commerce Road. There is no occupation to the south due to the proving grounds, and occupation to the north for 1/2 mile has been removed by development, but the proving grounds survey shows fence extending from the Southeast Corner to the west which would agree with a straight line to the Southwest Corner. I recommend setting the corner at a point which is at half the distance between the Southeast and Southwest Corners of Section 36 on line between them.

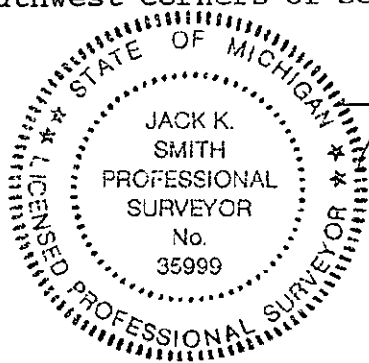

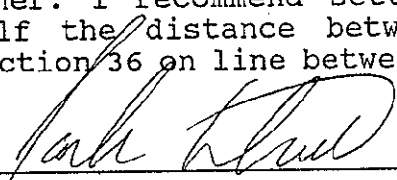
Jack K. Smith, PS