

**SURVEY & REMONUMENTATION**

FEB 25 1999

9-

**SECTION**

**LAND CORNER RECORDATION CERTIFICATE**  
**Filing Requirement of Act 74, Mich. P.A. 1970**

**FILED**

For corners in

<u>LIVINGSTON</u> (County)	Located In:	Corner Code #
1. Public Land Survey	<u>T3N R6E</u>	<u>M-01</u>
	T <u>    </u> R <u>    </u>	<u>    </u>
	T <u>    </u> R <u>    </u>	<u>    </u>
	T <u>    </u> R <u>    </u>	<u>    </u>
2. Property Controlling in Section	S <u>    </u> T <u>    </u> R <u>    </u>	<u>    </u>
	S <u>    </u> T <u>    </u> R <u>    </u>	<u>    </u>
3. Miscellaneous Property in Sec.	S <u>    </u> T <u>    </u> R <u>    </u>	<u>    </u>
	S <u>    </u> T <u>    </u> R <u>    </u>	<u>    </u>

1998 DEC 11 P 12:44

NANCY HAVILAND  
 REGISTER OF DEEDS  
 LIVINGSTON COUNTY, MI.  
 48843

L.S.C.#990m

Register of Deeds Stamp & File Number

4. Lot No. \_\_\_\_\_, Recorded Plat \_\_\_\_\_  
 5. Private Claims \_\_\_\_\_

I, JACK K. SMITH, in a field survey on DECEMBER 10, 1998 do hereby state that under requirements of P.A. 74, Michigan P.A. of 1970, the corner points mentioned in lines 1 and 2 above were in conformance with regulations and rules therefore as required in the current manual of survey instructions of the United States Department of the Interior, Bureau of Land Management or by a decree of a Court of Law and /or that the corner points mentioned in lines 3, 4 and 5 above were in conformance with the rules of the Michigan Board of Land Surveyors or by a Decree of a Court of Law; established, re-established, monumented, recovered, found as expressed below:

NOTE: Not more than 2 corners, all in the same town and range, may be recorded on this certificate.

1	A	B	C	D	E	F	G	H	I	J	K	L
2		6		5		4		3		2		1
3												
4		7		8		9		10		11		12
5												
6		16		17		16		15		14		13
7												
8		19		20		21		22		23		24
9												
10		30		29		28		27		26		25
11												
12		31		32		33		34		35		36
13												

A. Description of original monument and accessories and/or subsequent restoration:

GLO 1815 SET POST  
 WHITE OAK 10 N10W 4.50 (297)  
 BLACK OAK 6 S85W 3.80 (250.8')

B. Description of corner evidence found and/or method applied in restoring or reestablishing corner:

FOUND A 1" STEEL PIPE WEST OF A ROTTED WOODEN FENCE POST IN SWAMP MATCHES ACT 74 OF 1974 BY OSCAR BOSS LSC #843.

C. Description of monument for corner and accessories established to perpetuate locating the position of the corner:

M-01 NORTHEAST CORNER SECTION 1, HARTLAND TOWNSHIP, LIVINGSTON COUNTY, MICHIGAN:  
 RESET FOUND 1" PIPE WITH 1 1/4" X 72" STEEL PIPE WITH LIVINGSTON COUNTY REMONUMENTATION BRASS CAP WITH SURVEYOR #35999 @ 1/2 FOOT ABOVE THE SURFACE OF MOSS IN SWAMP.

- S63°43'W 1" PIPE WITH LIV. COUNTY REMON BRASS WITNESS CAP (SURVEYOR #11495) 42.72'
- S24°14'W 1" PIPE WITH LIV. COUNTY REMON BRASS WITNESS CAP (SURVEYOR #11495) 107.01'
- S02°21'W 1" PIPE WITH LIV. COUNTY REMON BRASS WITNESS CAP (SURVEYOR #11495) 105.89'
- S75°26'W 1" PIPE WITH LIV. COUNTY REMON BRASS WITNESS CAP (SURVEYOR #11495) 34.52'
- S02°21'W 1 1/4" PIPE WITH LIV. COUNTY REMON BRASS CORNER CAP (SURVEYOR #11495) 53.86'
- N28°16'48"W 1" PIPE WITH CARSONITE POST ON S. SIDE TIPSICO LAKE ROAD 41.87'
- S16°05'36"W 1/2" REROD WITH CAP #35999 AND CARSONITE POST ON W. SIDE TIPSICO LK. RD. 475.88'

Signed by [Signature] Date 12-10-1998

Surveyor's Michigan License No. 35999

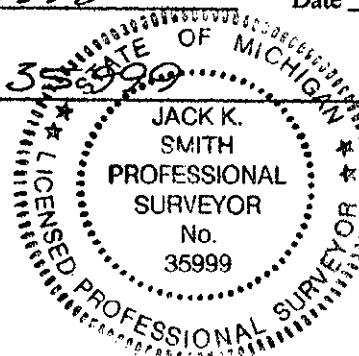

FORM APPROVED BY MICHIGAN STATE BOARD OF PROFESSIONAL SURVEYORS, JAN. 28  
 REVISED MAY 14, 1975 REVISED JAN. 1983  
 REVISED OCT. 1995

P.A. 345 1990, APPROVED BY LIVINGSTON COUNTY  
 PEER GROUP ON 12-11-98 CO. REP [Signature]