

FEB 24 1998

SECTION

LAND CORNER RECORDATION CERTIFICATE
Filing Requirement of Act 74, Mich. P.A. 1970

FILED

For corners in

LIVINGSTON
(County)

Located In: Corner Code #

- 1. Public Land Survey T 3N R 6E M-2
- T R
- T R
- T R
- 2. Property Controlling S T R
- in Section S T R
- 3. Miscellaneous S T R
- Property in Sec. S T R

1997 NOV 13 P 1:45

NANCY HAVILAND
REGISTER OF DEEDS
LIVINGSTON COUNTY, MI.
48843

L.S.C.#804m

Register of Deeds Stamp & File Number

- 4. Lot No. _____, Recorded Plat _____
- 5. Private Claims _____

I, Jack K. Smith, in a field survey on July 20, 1997 do hereby state that under requirements of P.A. 74, Michigan P.A. of 1970, the corner points mentioned in lines 1 and 2 above were in conformance with regulations and rules therefore as required in the current manual of survey instructions of the United States Department of the Interior, Bureau of Land Management or by a decree of a Court of Law and/or that the corner points mentioned in lines 3, 4 and 5 above were in conformance with the rules of the Michigan Board of Land Surveyors or by a Decree of a Court of Law; established, re-established, monumented, recovered, found as expressed below:

NOTE: Not more than 2 corners, all in the same town and range, may be recorded on this certificate.

A	B	C	D	E	F	G	H	I	J	K	L	M
1												
2	6		5		4		3		2		1	
3												
4	7		8		9		10		11		12	
5												
6	18		17		16		15		14		13	
7												
8	19		20		21		22		23		24	
9												
10	30		29		28		27		26		25	
11												
12	31		32		33		34		35		36	
13												

A. Description of original monument and accessories and/or subsequent restoration:

M-02 The East 1/4 Corner of Section 1, Hartland Township was set by Sylvester Sibley for the GLO in 1816.
The original witnesses are:
W Oak 30" S83°E 06 lk (4.0')
W Oak 6" N40°W 31 lk (20.5')

NOTE: NONE OF THE ORIGINAL WITNESSES COULD BE FOUND OR PERPETUATED.
SEE THE BACK OF THIS SHEET FOR ADDITIONAL HISTORICAL DATA.

B. Description of corner evidence found and/or method applied in restoring or reestablishing corner:

M-02 Found 1" steel pipe 2' W of C/L Tipsico Lake Road.

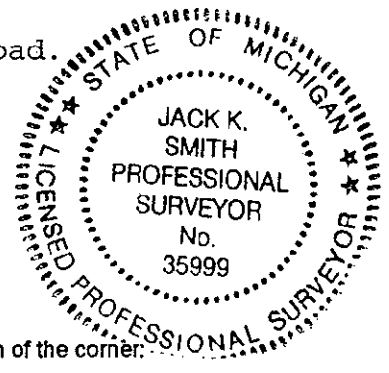

C. Description of monument for corner and accessories established to perpetuate locating the position of the corner:

M-02 East 1/4 Corner, Section 1, T3N, R6E - Set 1 1/4" x 30" steel pipe with 6" break-off section and brass cap marked as "Livingston County Remonumentation Corner".

- N42°W Set nail/tag in East side 36" Maple 33.15'
- S84°W Set nail/tag in North side triple 24" Oak 32.34'
- S60°W Set nail/tag in SE side 16" Oak 47.59'
- S40°E Set nail/tag in SW side twin 8" Hickory 35.05'

Signed by [Signature]
Surveyor's Michigan License No. 35999

Date July 20, 1997

May 5, 1997

M-02 T3N - R6E: EAST 1/4 CORNER, SECTION 1, HARTLAND TOWNSHIP

MONUMENTATION

We found a 1" iron pipe 2 feet west of the centerline of Tipsico Lake Road (gravel). The corner was originally recorded as being set by S. Sibley in 1823.

This corner is shown as a found 1" iron beginning in 1978 in a Richard Smith survey. There is a 1" pipe at the closing corner in Highland Township lying 48.45 feet to the north. The witnesses of Richard Smith are still existent and check well.

MEASUREMENTS

Bullock measure of 1870 was 3329 feet to corner M-1. Measure to the north by Richard Smith (and reported as measured by Boss Engineering) is 3376.11 feet. Our current measure was 3322.01 feet. In retracing the survey of Richard Smith it would appear that a second location for corner M-1 to the north may exist. Bullock measured 2646.6 feet to the south to corner M-03. Current measure is 2637.24 feet.

OCCUPATION

The corner is 2 feet west of the centerline of Tipsico Lake Road and fits well with a tree row, rock row and scraps of buried fence to the west. There is a rock row and light tree row to the east of the closing corner for Highland Township.

A sweep of the area did not reveal any additional irons and there was no evidence that any other corner position has been used.

This corner may be used for GPS with careful planning, but is not an easy corner to locate with GPS.

RECORDATION

This corner has Act 74s filed by Robert Pitts and Brad Thompson and is used on 4 Act 132s of record.

SUMMARY

Based on the apparent usage of the corner for all surveys that could be acquired and the fit of the corner with existing occupation, I recommend the acceptance of M-02, the East 1/4 Corner of Section 1, Hartland Township at the location as is presently monumented by the 1" pipe.

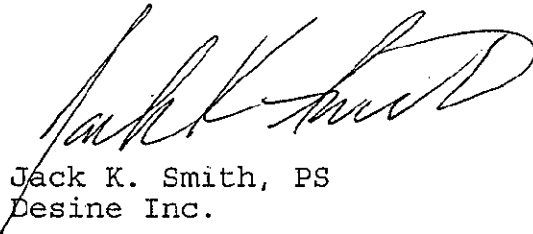
Jack K. Smith, PS
Desine Inc.

