

1993

COMMISSION

LAND CORNER RECORDATION CERTIFICATE
Filing Requirement of Act 74, Mich. P.A. 1970

For corners in

LIVINGSTON (County)

Located In:

Corner Code #

- 1. Public Land Survey T 3N R 6E M-12
2. Property Controlling in Section S T R
3. Miscellaneous Property in Sec. S T R

- 4. Lot No. , Recorded Plat
5. Private Claims

Dec 27 12 38 PM '93
NANCY HAYLANE
REGISTER OF DEEDS
LIVINGSTON COUNTY, MI
48843

FILED

L.S.C. #93m

Register of Deeds Stamp & File Number

1, JACK K. SMITH in a field survey on DECEMBER 14, 19 93, do hereby certify that under requirements of P.A. 74, Michigan P.A. of 1970, the corner points mentioned in lines 1 and 2 above were in conformance with regulations and rules therefore as required in the current manual of survey instructions of the United States Department of the Interior, Bureau of Land Management or by a decree of a Court of Law and/or that the corner points mentioned in lines 3, 4 and 5 above were in conformance with the rules of the Michigan Board of Land Surveyors or by a Decree of a Court of Law; established, re-established, monumented, re-monumented, recovered, found as expressed below:

NOTE: Not more than 4 corners, all in the same town and range, may be recorded on this certificate.

A. Description of original monument and accessories and/or subsequent restoration:

M-12 The East 1/4 Corner of Section 36, Hartland Township was set by the GLO in 1815 by Joseph Wampler. The original witnesses are: B. Oak 10" S29W 28 lks W. Oak 9" N51W 59 lks

NOTE: NONE OF THE ORIGINAL WITNESSES COULD BE FOUND OR PERPETUATED SEE THE BACK OF THIS SHEET FOR ADDITIONAL HISTORICAL DATA.

B. Description of corner evidence found and/or method applied in restoring or reestablishing corner:

M-12 Found P.K. Nail on centerline of tree row to the north and west, and 20 feet north of a private road running east-west. Corner falls 49.6 feet northerly of an iron used as the West 1/4 corner of Section 31, Highland Township, Oakland County.

NOTE: SEE THE DOSSIER AS FILED FOR THE LIVINGSTON COUNTY REMONUMENTATION PROGRAM FOR ADDITIONAL INFORMATION CONCERNING THIS CORNER.

C. Description of monument for corner and accessories established to perpetuate locating the position of the corner:

East 1/4 Corner, Section 36, T3N, R6E
Set 36" x 1 1/4" iron pipe with brass cap marked as "Livingston County Monument Corner"
15' N of North edge gravel private road
N84°W Nail and tag in N side 18" Cherry 12.14'
NORTH Nail and tag in E side 18" Cherry 24.18'
N25°E Nail and tag in SE side Tw. 4" Cedar 19.81'
SOUTH Nail and tag in E side 14" Cherry 49.62'

APPROVED BY THE LIVINGSTON COUNTY MONUMENTATION PEER GROUP DECEMBER 4, 1993. NOVEMBER 16, 1993.

Signed by JACK K. SMITH Date DECEMBER 24, 1993

Surveyor's Michigan License No. 35999

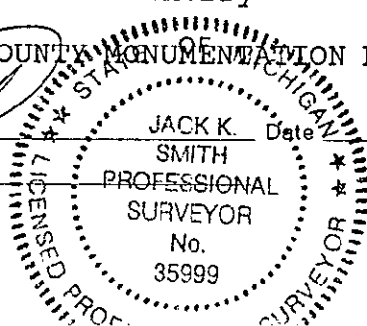

9

Grid table with columns A-M and rows 2-13. Cell 12,36 contains a circle with a dot.

M-12 - EAST 1/4 CORNER SECTION 36, T3N, R6E, HARTLAND TOWNSHIP

SUMMARY:

The East 1/4 Corner is shown on numerous surveys including: Don Ross, 1989, Cornerstone, 1990, and Wilderness Lake Estates (Cornerstone) 1990, but none of these surveys give witnesses or distances to the corner. The West 1/4 Corner of Section 31, Highland Township has been used by Brad Thompson and Ray Kostecke at the location of a 1/2" iron that fits an occupation tree row running east. The first recorded location information for the East 1/4 Corner of Section 36 is in a survey by Ray Kostecke in which he calls for the setting of a PK nail. There is a good occupation tree row running north and south through this area, which fits the location as called for by Kostecke, as well as a tree row to the west which also fits well. Line extended from the West 1/4 Corner of Section 36 Hartland to the Kostecke location falls 0.86 feet north of a found iron at the apparent center of Section 36. The Kostecke location places the West 1/4 Corner of Section 31, Highland Township 1.56 feet east of the line between the East 1/4 Corner and the Southeast Corner of Section 36. This corner falls 49.6 feet northerly of the iron used as the West 1/4 Corner of Section 31, Highland Township. This position falls approximately 20 feet northerly of the centerline of an existing east-west private gravel road. Taking the occupational evidence, and previous useage into account, I recommend using the location as shown on the Kostecke survey as the East 1/4 Corner of Section 36.



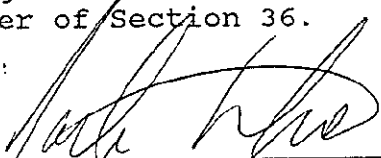

Jack K. Smith, PS