

1993

COMMISSION

LAND CORNER RECORDATION CERTIFICATE
Filing Requirement of Act 74, Mich. P.A. 1970

Dec 28 4 35 PM '93
NANCY HAYLAND
REGISTER OF DEEDS
LIVINGSTON COUNTY, MI
48843

FILED

For corners in

LIVINGSTON
(County)

Located In:

Corner Code #

- 1. Public Land Survey T 3N R 6E M-13
2. Property Controlling in Section S T R
3. Miscellaneous Property in Sec. S T R

L.S.C. #153m
Register of Deeds Stamp & File Number

- 4. Lot No. , Recorded Plat
5. Private Claims

Grid table with columns A-M and rows 2-13 containing numbers 1-36.

MARY A. BARNWELL

I, MARY A. BARNWELL, in a field survey on DECEMBER 6, 1993, do hereby certify that under requirements of P.A. 74, Michigan P.A. of 1970, the corner points mentioned in lines 1 and 2 above were in conformance with regulations and rules therefore as required in the current manual of survey instructions of the United States Department of the Interior, Bureau of Land Management or by a decree of a Court of Law and/or that the corner points mentioned in lines 3, 4 and 5 above were in conformance with the rules of the Michigan Board of Land Surveyors or by a Decree of a Court of Law; established, re-established, monumented, re-monumented, recovered, found as expressed below:

NOTE: Not more than 4 corners, all in the same town and range, may be recorded on this certificate.

A. Description of original monument and accessories and/or subsequent restoration:

M-13 The Southeast Corner of Section 36, Hartland Township was set by the GLO in 1815 by Joseph Wampler. The original witnesses are: W. Oak 14" S12W 134 lks, W. Oak 14" S86W 165 lks

NOTE: NONE OF THE ORIGINAL WITNESSES COULD BE FOUND OR PERPETUATED SEE THE BACK OF THIS SHEET FOR ADDITIONAL HISTORICAL DATA.

B. Description of corner evidence found and/or method applied in restoring or reestablishing corner:

M-13 Found 1" iron bar. Fence runs north, south, and west from corner.

NOTE : SEE THE DOSSIER AS FILED FOR THE LIVINGSTON COUNTY REMONUMENTATION PROGRAM FOR ADDITIONAL INFORMATION CONCERNING THIS CORNER.

C. Description of monument for corner and accessories established to perpetuate locating the position of the corner:

Southeast Corner, Section 36, T3N, R6E
Set 36" x 1 1/4" iron pipe with brass cap marked as "Livingston County Monument Corner"
N30°W Nail and tag in SW side 16" Cherry 63.95'
NORTH Nail and tag in W side 10" Cherry 38.81'
N85°E Nail and tag in S side 18" Cherry 37.22'
S85°W Nail and tag in N side 12" Elm 15.86'

APPROVED BY THE LIVINGSTON COUNTY MONUMENTATION PEER GROUP OCT. 30 1993.

Signed by [Signature]
Surveyor's Michigan License No. 33971

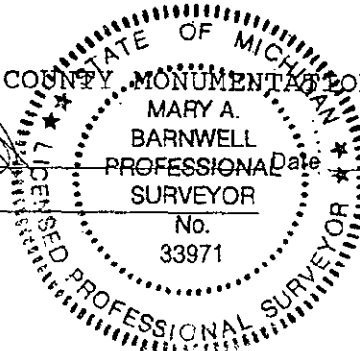

DECEMBER 24, 1993

October 30, 1993

M-13, T3N, R6E: SOUTHEAST CORNER, SECTION 36, HARTLAND TOWNSHIP

Found 1" Bar at the intersection of fence remains running north, south and west. First appearing on a 1954 survey of the General Motors Proving Grounds, the bar has been used in all known surveys since, including surveys by Boss in 1972, Claybourne J. Adams in 1984, Cornerstone in 1990 and Brad F. Thompson in 1993. All known survey records indicate that this is a common Hartland Township corner. A sweep of the area found no additional irons. Based upon occupational evidence, previous usage and long-standing acceptance, I recommend approving the location of the corner at the point as currently marked.

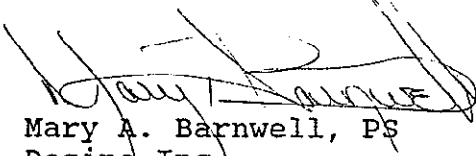
Mary A. Barnwell, PS
Desine Inc.)

