

**SURVEY & REMONUMENTATION**

FEB 24 1998

9-  
**FILED**

**SECTION**

**LAND CORNER RECORDATION CERTIFICATE**  
Filing Requirement of Act 74, Mich. P.A. 1970

For corners in

LIVINGSTON  
(County)

Located In:

Corner Code #

- |                                    |   |             |
|------------------------------------|---|-------------|
| 1. Public Land Survey              | T <u>4N</u> R <u>5E</u>                   | <u>C-13</u> |
|                                    | T <u>    </u> R <u>    </u>               | <u>    </u> |
|                                    | T <u>    </u> R <u>    </u>               | <u>    </u> |
|                                    | T <u>    </u> R <u>    </u>               | <u>    </u> |
| 2. Property Controlling in Section | S <u>    </u> T <u>    </u> R <u>    </u> | <u>    </u> |
|                                    | S <u>    </u> T <u>    </u> R <u>    </u> | <u>    </u> |
| 3. Miscellaneous Property in Sec.  | S <u>    </u> T <u>    </u> R <u>    </u> | <u>    </u> |
|                                    | S <u>    </u> T <u>    </u> R <u>    </u> | <u>    </u> |

1997 SEP 23 A 10: 18  
NANCY HAVILAND  
REGISTER OF DEEDS  
LIVINGSTON COUNTY, MI.  
48843  
  
L.S.C. #700m  
  
Register of Deeds Stamp & File Number

4. Lot No. \_\_\_\_\_, Recorded Plat \_\_\_\_\_  
5. Private Claims \_\_\_\_\_

I, Jack K. Smith, in a field survey on July 20, 1997 do hereby state that under requirements of P.A. 74, Michigan P.A. of 1970, the corner points mentioned in lines 1 and 2 above were in conformance with regulations and rules therefore as required in the current manual of survey instructions of the United States Department of the Interior, Bureau of Land Management or by a decree of a Court of Law and /or that the corner points mentioned in lines 3, 4 and 5 above were in conformance with the rules of the Michigan Board of Land Surveyors or by a Decree of a Court of Law, established, re-established, monumented, recovered, found as expressed below:

NOTE: Not more than 2 corners, all in the same town and range, may be recorded on this certificate.

	A	B	C	D	E	F	G	H	I	J	K	L	M
1													
2	6		5		4		3		2		1		
3													
4	7		8		9		10		11		12		
5													
6	18		17		16		15		14		13		
7													
8	19		20		21		22		23		24		
9													
10	30		29		28		27		26		25		
11													
12	31		32		33		34		35		36		
13													

A. Description of original monument and accessories and/or subsequent restoration:

C-13 The Southwest Corner of Section 32, Deerfield Township was set by John Mullett for the GLO in 1823.  
The original witnesses are:  
Tamarack 6" N48°E 3.40 (224.4')  
W Oak 15" N82°W 4.61 (304.3')

NOTE: NONE OF THE ORIGINAL WITNESSES COULD BE FOUND OR PERPETUATED. SEE THE BACK OF THIS SHEET FOR ADDITIONAL HISTORICAL DATA.

B. Description of corner evidence found and/or method applied in restoring or reestablishing corner:

C-13 Found 1/2" re-rod 2 feet south of the centerline of Allen Road (gravel).

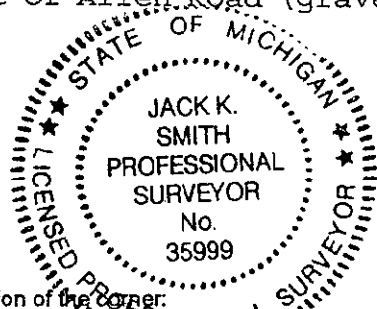

C. Description of monument for corner and accessories established to perpetuate locating the position of the corner:

C-13 Southwest Corner, Section 32, T4N, R5E - Set 1 1/4" x 30" steel pipe with 6" break-off section and brass cap marked as "Livingston County Remonumentation Corner".  
S62°E Set witness pipe\* 30.97'  
N51°E Set witness pipe\* 33.61'  
N55°W Set witness pipe\* 36.31'  
S67°W Set witness pipe\* 41.57'

\* 36"X1" iron pipe with brass cap marked "Livingston County Remonumentation Witness"

Signed by [Signature] Date July 20, 1997  
Surveyor's Michigan License No. 35999

July 12, 1997

C-13 T4N - R5E: SOUTHEAST CORNER, SECTION 31, DEERFIELD TOWNSHIP

**MONUMENTATION**

C-13 was originally set by John Mullett for the GLO in 1823. This corner is currently marked by a 1/2" re-rod (bent) set by Boss Engineering in 1992. The corner was reported to be a railroad spike set by Miller on a 1979 Act 74. The corner was placed at GLO distance from the closing corner to the east. The Boss 132 of 1992 shows this same distance used to place the current iron. No other marker could be found near this location.

**MEASUREMENTS**

Current measure is 2624.80 feet to the west and 2643.71 feet to the east. Post 1978 measures to east and west compare well. The early measures of Bullock (1875) are consistently short as compared to current. The closing corner falls 217.72 feet east of C-13 (GLO computes to 217.8 feet).

**OCCUPATION**

The corner falls 2 feet south of the centerline of Allen Road (gravel). There is no occupation to the north because the area is surrounded by swamp. This causes the historic witnesses to be of dubious value. A thorough sweep of the area around the corner with a magnetic locator did not reveal any alternate corner positions. The railroad spike may have been graded out since the iron we found was bent about 3 inches from the top and laid down flush. This corner is open for GPS and can be directly occupied.

**RECORDATION**

There is an Act 74 filed by A. F. Miller from 1979 when the railroad spike was set. The corner has been shown on 3 Act 132s.

**SUMMARY**

The current location of the corner has been used for numerous surveys in the area and no other position has been used that I could find. If a railroad spike was there at some time it would appear to have been removed before 1992. I recommend that the existing 1/2" iron be replaced with a Livingston County Remonumentation pipe and cap in the present location.

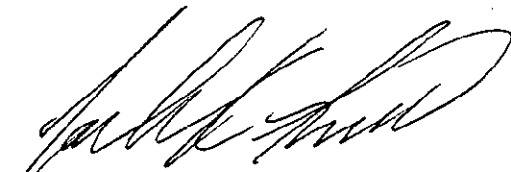
  
Jack K. Smith, PS  
Desine Inc.

