

MAR 17 2000

SECTION

LAND CORNER RECORDATION CERTIFICATE  
Filing Requirement of Act 74, Mich. P.A. 1970

FILED

For corners in

LIVINGSTON Located In: Corner Code #  
(County)

1. Public Land Survey T 4N R 5E I-05  
T R  
T R  
T R

2. Property Controlling S T R  
in Section S T R

3. Miscellaneous S T R  
Property in Sec. S T R

4. Lot No. \_\_\_\_\_, Recorded Plat \_\_\_\_\_

5. Private Claims \_\_\_\_\_

a

1999 NOV 22 A 10:08

NANCY HAVILAND  
REGISTER OF DEEDS  
LIVINGSTON COUNTY, MI.  
48843

ISC# 1089m  
Register of Deeds Stamp & File  
Number

I, MARY A. BARNWELL, in a field survey on SEPTEMBER 29, 1999 do hereby state that under requirements of P.A. 74, Michigan P.A. of 1970, the corner points mentioned in lines 1 and 2 above were in conformance with regulations and rules therefore as required in the current manual of survey instructions of the United States Department of the Interior, Bureau of Land Management or by a decree of a Court of Law and for that the corner points mentioned in lines 3, 4 and 5 above were in conformance with the rules of the Michigan Board of Land Surveyors or by a Decree of a Court of Law; established, re-established, monumented, recovered, found as expressed below:

NOTE: Not more than 2 corners, all in the same town and range, may be recorded on this certificate.

A	B	C	D	E	F	G	H	I	J	K	L	M
1												
2	6	5	4	3	2	1						
3												
4	7	8	9	10	11	12						
5												
6	18	17	16	15	14	13						
7												
8	19	20	21	22	23	24						
9												
10	30	29	28	27	26	25						
11												
12	31	32	33	34	35	36						
13												

A. Description of original monument and accessories and/or subsequent restoration:

I-05 Deerfield Township was set by the GLO in 1823.  
The original Witnesses are:  
White Oak 32° S. 61° W. 24 Links (15.8')  
White Oak 14° N. 43 1/2° E. 72 Links (47.5')

NOTE: None of the original witnesses could be found or perpetuated.  
See the back of this sheet for additional historical data.

B. Description of corner evidence found and/or method applied in restoring or reestablishing corner:

I-05 Found Railroad Spike beneath the pavement at the centerline intersection of Argentine Road (asphalt surface running North/South) and Hogan Road (gravel surface running East/West).

C. Description of monument for corner and accessories established to perpetuate locating the position of the corner:

I-05 Northwest Corner, Section 14, T4N, R5E - Reset the Railroad Spike with a 30" x 1 1/4" steel pipe with Brass Cap marked as "Livingston County Monumentation Corner" in new Monument Box

- N 64°W Set Nail/Remon Washer NE/S 18" Locust 67.88'
- N 74° E Set Nail/Remon Washer S/S 14" Elm 82.60'
- S 78° E Set Nail/Remon Washer N/S 24" Maple 90.70'
- S 18° W Set Nail/Remon Washer E/S 10" Walnut 90.48'

Signed by Mary A. Barnwell  
Surveyor's Michigan License No. 33971

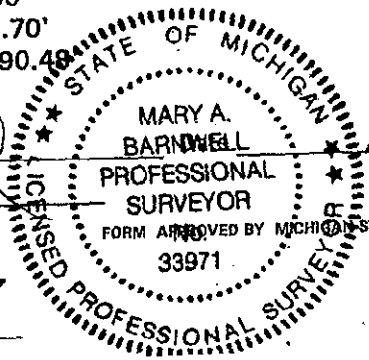

11-4-99

PA. 345 1990, APPROVED BY LIVINGSTON COUNTY  
PEER GROUP ON 8.4.99 CO. REP JED

MICHIGAN STATE BOARD OF PROFESSIONAL SURVEYORS, JAN. 28, 1971  
REVISED MAY 14, 1975  
REVISED JAN., 1983  
REVISED OCT., 1995