

MAR 17 2000

LAND CORNER RECORDATION CERTIFICATE  
Filing Requirement of Act 74, Mich. P.A. 1970

FILED

SECTION

For corners in

LIVINGSTON Located In: Corner Code #  
(County)

1. Public Land Survey T 4N R 5E I-08  
T \_\_\_\_\_ R \_\_\_\_\_  
T \_\_\_\_\_ R \_\_\_\_\_  
T \_\_\_\_\_ R \_\_\_\_\_

2. Property Controlling in Section S \_\_\_\_\_ T \_\_\_\_\_ R \_\_\_\_\_  
S \_\_\_\_\_ T \_\_\_\_\_ R \_\_\_\_\_

3. Miscellaneous Property in Sec. S \_\_\_\_\_ T \_\_\_\_\_ R \_\_\_\_\_  
S \_\_\_\_\_ T \_\_\_\_\_ R \_\_\_\_\_

4. Lot No. \_\_\_\_\_, Recorded Plat \_\_\_\_\_

5. Private Claims \_\_\_\_\_

a

1999 NOV 22 A 10:08

NANCY HAVILAND  
REGISTER OF DEEDS  
LIVINGSTON COUNTY, MI.  
48843

LSC# 1092m

Register of Deeds Stamp & File Number

I, MARY A. BARNWELL, in a field survey on SEPTEMBER 29, 1999 do hereby state that under requirements of P.A. 74, Michigan P.A. of 1970, the corner points mentioned in lines 1 and 2 above were in conformance with regulations and rules therefore as required in the current manual of survey instructions of the United States Department of the Interior, Bureau of Land Management or by a decree of a Court of Law and /or that the corner points mentioned in lines 3, 4 and 5 above were in conformance with the rules of the Michigan Board of Land Surveyors or by a Decree of a Court of Law; established, re-established, monumented, recovered, found as expressed below:

NOTE: Not more than 2 corners, all in the same town and range, may be recorded on this certificate.

A	B	C	D	E	F	G	H	I	J	K	L	M
2	6	5	4	3	2	1						
3												
4	7	8	9	10	11	12						
5												
6	18	17	16	15	14	13						
7												
8	19	20	21	22	23	24						
9												
10	30	29	28	27	26	25						
11												
12	31	32	33	34	35	36						
13												

A. Description of original monument and accessories and/or subsequent restoration:

I-08 Deerfield Township was set by the GLO in 1823.  
The original witnesses are:  
Yellow Oak 16" S 71 1/2° W 4.10 ch (270.6')  
White Oak 18" N 71 1/2° E 1.07 ch (70.6')

NOTE: None of the original witnesses could be found or perpetuated.  
See the back of this sheet for additional historical data.

B. Description of corner evidence found and/or method applied in restoring or reestablishing corner:

I-08 Found 1/2" Iron Rod at the centerline of Argentine Road (asphalt surface running North/South) - old fence line to the West

C. Description of monument for corner and accessories established to perpetuate locating the position of the corner:

I-08 West 1/4 Corner, Section 23, T4N, R5E - Reset 1/2" Iron Rod with 36" x 1 1/4" steel breakaway pipe with Brass Cap marked as "Livingston County Monumentation Corner" in a new Monument Box

- N 22° W Set Nail/Remon Washer NE/S 30" Oak 76.11'
- N 35° W Set Nail/Remon Washer NE/S 30" Oak 48.03'
- N 63° W Set Nail/Remon Washer NE/S 18" Hickory 34.25'
- N 83° E Set Nail/Remon Washer S/S 10" Walnut 48.10'

Signed by [Signature]  
Surveyor's Michigan License No. 33971

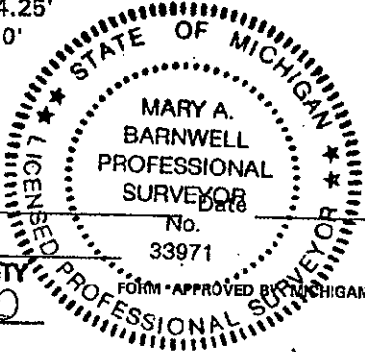

11-4-99

PA. 345 1990, APPROVED BY LIVINGSTON COUNTY  
PEER GROUP ON 18-4-99, CO. REP JED