

FILED

LAND CORNER RECORDATION CERTIFICATE

Filing Requirement of Act 74, Mich. P.A. 1970

AUG 16 1 14 PM '94

For corners in

LIVINGSTON (County)

Located In:

Corner Code =#

- 1. Public Land Survey T 4 R 5 K-10
2. Property Controlling in Section S T R
3. Miscellaneous Property in Sec. S T R

NANCY HAVILAND REGISTER OF DEEDS LIVINGSTON COUNTY, MI 48843

L.S.C.#215m

Register of Deeds Stamp & File Number

- 4. Lot No. Recorded Plat
5. Private Claims

Grid table with columns A-M and rows 2-13. Cell 10,25 contains a black dot.

Edward E. Anderson in a field survey on August 1, April 25, 19 94 do hereby certify that under requirements of P.A. 74, Michigan P.A. of 1970, the corner points mentioned in lines 1 and 2 above were in conformance with regulations and rules therefore as required in the current manual of survey instructions of the United States Department of the Interior, Bureau of Land Management or by a decree of a Court of Law and/or that the corner points mentioned in lines 3, 4 and 5 above were in conformance with the rules of the Michigan Board of Land Surveyors or by a Decree of a Court of Law; established, re-established, monumented, re-monumented, recovered, found as expressed below:

NOTE: Not more than 4 corners, all in the same town and range, may be recorded on this certificate.

A. Description of original monument and accessories and/or subsequent restoration:

GLO NOTES DATED May 1, 1823
GLO WITNESSES W Oak 24" S58°E 28 Lks
W Oak 16" N17°W 56 Lks

SURVEY & REMONUMENTATION

SEP 26 1994

Deputy Surveyor Henry Parker 1823 - 1825

COMMISSION

ADDITIONAL HISTORICAL DATA ON BACK OF SHEET

B. Description of corner evidence found and/or method applied in restoring or reestablishing corner:

Found 1/2" Capped iron (#23518) Fit witnesses by Cornerstone Engineering

P.A. 345 1990, APPROVED BY LIVINGSTON COUNTY PEER GROUP ON June 15, 94 CO. REP Rabbli.

C. Description of monument for corner and accessories established to perpetuate locating the position of the corner:

K-10 W 1/4 COR SECTION 25 T4N-R5E
Set 1 1/4" x 36" Breakaway Iron Pipe with Brass Cap (Livingston County Monument corner) on West edge of Green Road
N35°W 27.82' Spike E/S 4" Oak
N45°E 49.06' 1" x 36" Iron Pipe with Witness Cap
S88°E 35.81' 1/2" Iron
S30°W 38.08' Spike E/S 12" Twin Oak
S75°E 48.58' Spike N/S 6" Elm
EAST 33.00' 1/2" Rerod Cap#23828

APPROVED BY LIVINGSTON COUNTY MONUMENT PEER GROUP JUNE 15, 1994

Signed by [Signature] Date August 2, 1994

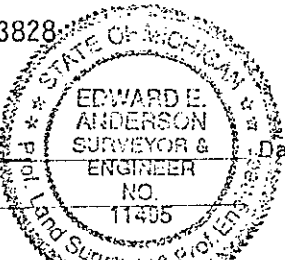

Surveyor's Michigan License No. 11495

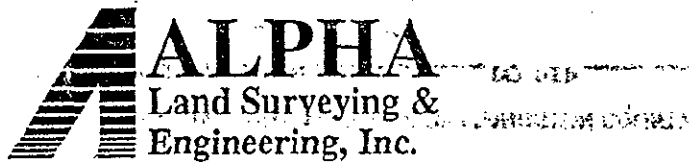

EDWARD E. ANDERSON, P.S., P.E.
RICHARD F. FRANK, P.S.
BRIAN R. SHALTZ, C.S.T.

Members of:
Michigan Society of Professional Surveyors
American Congress on Surveying and Mapping
American Society of Civil Engineers

401 S. Leroy St.
Fenton, Michigan 48430-2164

(313) 629-8974
FAX (313) 629-9069

May 11, 1994

SUMMARY

K-10 WEST 1/4 CORNER SECTION 25, T4N-R5E, DEERFIELD TOWNSHIP,
LIVINGSTON COUNTY, MICHIGAN.

Found 1/2" capped Iron #23518 (Richard Smith) on West edge of gravel.
Checked and measured to witnesses we found. The only witnesses were
by Cornerstone Engineering, Page 11, this dossier.

Distance from S.W. corner to the West 1/4 corner of said Section 25
is 2652.81' on Boss Survey, Page 7 this dossier.

Distance from N.W. corner to the West 1/4 corner of said Section 25
is 2659.54' on Garlock Survey, Page 9, this dossier, and Page 12, this dossier.

Made a clean sweep of immediate area and found no additional corners
or irons.

Found old tree line to East and West, and old fence line to West.

Terrain is open in all directions.

Green Road (gravel) falls to the North and rises to the South. No
roads to East or West.

Came to the conclusion that the 1/2" iron we found is the correct
West 1/4 corner of said Section 25.

Edward E. Anderson
P.S. #11495

NOTE: Returned to field on 6/7/94 and found a 1/2" rerod
35.81' East of the above mentioned capped iron that
I believe is the correct West 1/4 corner of Said Sec. 25.
This rerod does not agree with all the other evidence we
found. I have found no other evidence or information to
support its existence or location., therefore I am not
considering it in coming to my final conclusion as to
the correct location of the West 1/4 Corner of said
Section 25.

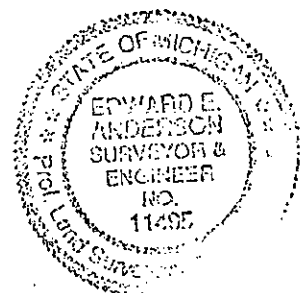

TWRSE 15-10 P