

MAR 17 2000

SECTION

FILED

LAND CORNER RECORDATION CERTIFICATE
Filing Requirement of Act 74, Mich. P.A. 1970

For corners in LIVINGSTON Located in: TYRONE Corner Code # _____
(County)

1. Public Land Survey	T <u>4N</u> R <u>6E</u>	D-9
	T _____ R _____	_____
	T _____ R _____	_____
	T _____ R _____	_____
2. Property Controlling in Section	S _____ T _____ R _____	_____
	S _____ T _____ R _____	_____
3. Miscellaneous Property in Sec.	S _____ T _____ R _____	_____
	S _____ T _____ R _____	_____

4. Lot No. _____, Recorded Plat _____

5. Private Claims _____

9 1999 NOV 22 A 11:10

NANCY HAVILAND
REGISTER OF DEEDS
LIVINGSTON COUNTY, MI.
48843

LSC# 1129m

Register of Deeds Stamp and File Number

I, Bryan L. Boss, in a field survey on 9-28-99, do hereby certify that under requirements of P.A. 74, Michigan P.A. of 1970, the corner points mentioned in lines 1 and 2 above were in conformance with regulations and rules therefor as required in the current manual of survey instructions of the United States Department of the Interior, Bureau of Land Management or by a decree of a Court of Law and/or that the corner points mentioned in lines 3, 4 and 5 above were in conformance with the rules of the Michigan Board of Land Surveyors or by a Decree of a Court of Law; established, re-established, monumented, re-monumented, recovered, found as expressed below.

NOTE: Not more than 4 corners, all in the same town and range, may be recorded on this certificate.

A	B	C	D	E	F	G	H	I	J	K	L	M
2	6	5	4	3	2	1						
3												
4	7	8	9	10	11	12						
5												
6	18	17	16	15	14	13						
7												
8	19	20	21	22	23	24						
9												
10	30	29	28	27	26	25						
11												
12	31	32	33	34	35	36						
13												

A. Description of original monument and accessories and/or subsequent restoration:

SET POST
24" WHITE OAK N17°E 27 LINKS
12" WHITE OAK S71°W 23 LINKS

B. Description of corner evidence found and/or method applied in restoring or reestablishing corner:

FOUND 1/2" IRON ROD WITH YELLOW CAP
4.4' SOUTH OF CENTERLINE OF DEAN ROAD

C. Description of monument for corner and accessories established to perpetuate locating the position of the corner:

SET 1 1/4" X 30" PIPE WITH PLASTIC INSERT
CONNECTED TO A 1 1/4" X 6" PIPE WITH A BRASS
CAP STAMPED "LIVINGSTON COUNTY
REMONUMENTATION CORNER"
N03°E 33.40' FOUND CONCRETE MONUMENT
N49°E 55.52' SET REMON NAIL & TAG SE/S
POWER POLE
S49°E 24.49' SET REMON NAIL & TAG SW/S 12"
CHERRY
S43°W 18.41' SET REMON NAIL & TAG NW/S 20"
OAK

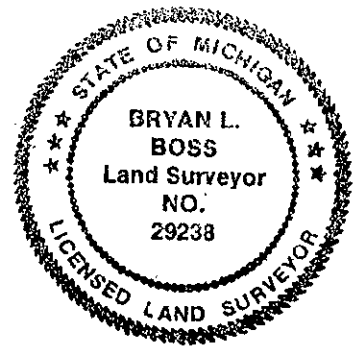

PA. 345 1990, APPROVED BY LIVINGSTON COUNTY
PEER GROUP ON 5-19-99 CO. REP VED

Signed by Bryan L. Boss Date NOV 9, 1999
Surveyor's Michigan License No. 29238