

OCT 26 1995

FILED

9-

COMMISSION

LAND CORNER RECORDATION CERTIFICATE SEP 15 12 02 PM '95
Filing Requirement of Act 74, Mich. P.A. 1970

For corners in Livingston
(County)

Located In: _____ Corner Code # _____

NANCY HAVILAND
REGISTER OF DEEDS
LIVINGSTON COUNTY, MT
48843

- 1. Public Land Survey T 4 R 6 E E-11
T _____ R _____
T _____ R _____
T _____ R _____
- 2. Property Controlling S _____ T _____ R _____
in Section S _____ T _____ R _____
- 3. Miscellaneous S _____ T _____ R _____
Property in Section S _____ T _____ R _____

L.S.C.# 432m

Register of Deeds Stamp & File Number

- 4. Lot No. _____, Recorded Plat _____
- 5. Private Claims _____

	A	B	C	D	E	F	G	H	I	J	K	L	M
2	6		5		4		3		2		1		
3													
4	7		8		9		10		11		12		
5													
6	18		17		16		15		14		13		
7													
8	19		20		21		22		23		24		
9													
10	30		29		28		27		26		25		
11													
12	31		32		33		34		35		36		
13													

I, Edward E. Anderson, in a field survey on July 26, 1995, do hereby certify that under requirements of P.A. 74, Michigan P.A. of 1970, the corner points mentioned in lines 1 and 2 above were in conformance with regulations and rules therefore as required in the current manual of survey instructions of the United States Department of the Interior, Bureau of Land Management or by a decree of a Court of Law and/or that the corner points mentioned in lines 3, 4 and 5 above were in conformance with the rules of the Michigan Board of Professional Surveyors or by a Decree of a Court of Law; established, re-established, monumented, re-monumented, recovered, found as expressed below:

NOTE: Not more than 4 corners, all in the same town and range, may be recorded on this certificate.

A. Description of original monument and accessories and/or subsequent restoration:

GLO NOTES Dated April 5, 1823
GLO WITNESSES W Oak 18" 57 1/2°E 37 Lks
Poplar 12" N39°W 33 Lks

ADDITIONAL HISTORICAL DATA ON BACK

B. Description of corner evidence found and/or method applied in restoring or reestablishing corner:

Found 3/4" iron bar in mon box., Fit witnesses by M.D.OJ. Albright, Wilson, Boss, R. Smith.

C. Description of monument for corner and accessories established to perpetuate locating the position of the corner:

E-11 NE COR SEC 32 T4N-R6E

Set 1 1/4" x 36" Breakaway iron pipe with brass cap (Liv. Co. Mon. Cor.)
in mon box in centerline Fausett Road
N08°E 12.48' N.W. cor. C.B. frame
N52°E 22.62' N.W. cor. of top of Con. Rail
S45°E 22.48' S.W. cor. of top of Con. Rail
S05°E 12.28' S.W. cor. C.B. frame

Signed by [Signature]
Surveyor's Michigan License No. _____

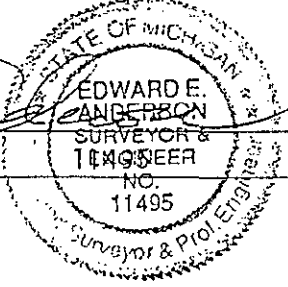

Date August 1, 1995

FORM APPROVED BY MICHIGAN STATE BOARD OF PROFESSIONAL SURVEYORS, JAN. 28, 1971
REVISED MAY 14, 1975
REVISED JAN, 1983

P.A. 345 1980, APPROVED BY LIVINGSTON COUNTY
PEER GROUP ON 6-21-95 CO. REP JED

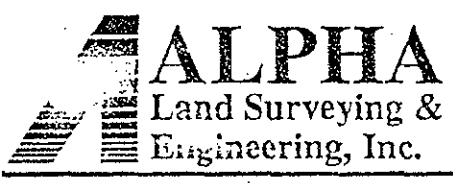

EDWARD E. ANDERSON, P.S., P.E.
RICHARD F. FRANK, P.S.
BRIAN R. SHALTZ, C.S.T.
Members of:
Michigan Society of Professional Surveyors
American Congress on Surveying and Mapping
American Society of Civil Engineers

401 S. Leroy St.
Fenton, Michigan 48430-2164

(313) 629-8974
FAX (313) 629-9069

SUMMARY

June 8, 1995

E-11 NE CORNER SECTION 32, T4N-R6E, TYRONE TOWNSHIP
LIVINGSTON COUNTY, MICHIGAN

Found 3/4" iron bar in monument box in centerline of Fausett Road (blacktop).

Checked and measured to witnesses we found.

Found none of M.D.O.T. and Garlock witnesses, pages 9, 10, 11, and 13 this dossier.

Found 1 of 3 of Wilson and Boss witnesses, and they checked, pages 15, 17, 20, and 23 this dossier.

Found all of Albright and R. Smith witnesses and they checked, pages 18, 19, and 22 this dossier.

Distance from the NE corner to the North 1/4 corner of said Section 32 is 2630.22' on Wilson survey, pages 14 and 23 this dossier; and 2632.54' on Boss survey, page 20 this dossier.

Distance from the N.E. corner to the East 1/4 corner is 2680' measured in the field by E. Anderson 4/27/95, pages 6 and 24 this dossier.

Made a clean sweep of immediate area and found no additional irons or corners.

Paved road running east and west. Road falls east and west.

The NE corner of said Section 32 falls 67'± west of the centerline of the southbound lane of U.S. 23.

Terrain is open in all directions. U.S. 23 R.O.W. fence runs to the north and south.

Good location for G.P.S.

Came to the conclusion that the 3/4" bar in the monument box is the correct N.E. corner of said Section 32.

Edward E. Anderson
P.S. #11495
STATE OF MICHIGAN
EDWARD E. ANDERSON
LAND SURVEYOR &
ENGINEER
NO. 11495