

MAR 17 2000

FILED

SECTION

LAND CORNER RECORDATION CERTIFICATE  
Filing Requirement of Act 74, Mich. P.A. 1970

1999 NOV 22 A 11:10

For corners in  
LIVINGSTON  
(County)

Located in: TYRONE Corner Code #

9

HANCY HAVILAND  
REGISTER OF DEEDS  
LIVINGSTON COUNTY, MI.  
48843

- 1. Public Land Survey T 4N R 6E G-10  
T R  
T R  
T R
- 2. Property Controlling S T R  
In Section S T R
- 3. Miscellaneous S T R  
Property in Sec. S T R
- 4. Lot No. , Recorded Plat
- 5. Private Claims

LSC# 1134m

Register of Deeds Stamp and File Number

I, Bryan L. Boss, in a field survey on SEPT. 20, 1999  
do hereby certify that under requirements of P.A. 74, Michigan P.A. of 1970, the corner points mentioned  
in lines 1 and 2 above were in conformance with regulations and rules therefor as required in the  
current manual of survey instructions of the United States Department of the Interior, Bureau of Land  
Management or by a decree of a Court of Law and/or that the corner points mentioned in lines 3, 4 and 5  
above were in conformance with the rules of the Michigan Board of Land Surveyors or by a Decree of a  
Court of Law; established, re-established, monumented, re-monumented, recovered, found as  
expressed below.

	A	B	C	D	E	F	G	H	I	J	K	L	M
2	6	5	4	3	2	1							
3													
4	7	6	5	4	3	2	1						
5													
6	18	17	16	15	14	13							
7													
8	19	20	21	22	23	24							
9													
10	30	29	28	27	26	25							
11													
12	31	32	33	34	35	36							
13													

NOTE: Not more than 4 corners, all in the same town and range, may be recorded  
on this certificate.

A. Description of original monument and accessories and/or subsequent restoration:

- SET POST
- 10" B. OAK S12 1/2° E 91 LINKS (60.06')
- 8" Y. OAK N2 1/2° W 112 LINKS (73.92')

B. Description of corner evidence found and/or method applied in restoring or reestablishing corner:

FOUND 1/2" IRON ROD AT CENTERLINE OF HARTLAND AND  
GERMANY ROADS

C. Description of monument for corner and accessories established to perpetuate locating the position of the corner:

- SET 1 1/4" X 30" PIPE WITH PLASTIC INSERT
- CONNECTED TO 1 1/4" X 6" PIPE WITH BRASS
- CAP STAMPED "LIVINGSTON COUNTY
- REMONUMENTATION CORNER"
- N39°E 81.78' SET REMON NAIL & TAG SE/E P.
- POLE
- S55°E 49.80' SET REMON NAIL & TAG NE/S 22"
- MAPLE
- S57°W 39.75' SET REMON NAIL & TAG SE/S 28"
- MAPLE
- N45°W 40.27' SET REMON N & T NE/S 28" MAPLE

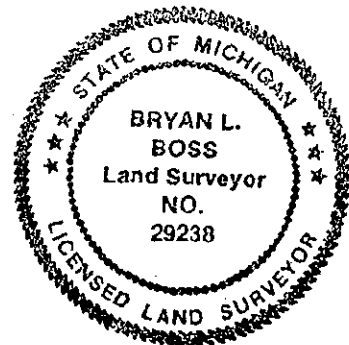

P.A. 345 1990, APPROVED BY LIVINGSTON COUNTY  
PEER GROUP ON 5-19-99 CO. REP JED

Signed by Bryan L. Boss

Date NOV. 9, 1999

Surveyor's Michigan License No. 29238