

MAR 17 2000

SECTION

LAND CORNER RECORDATION CERTIFICATE
Filing Requirement of Act 74, Mich. P.A. 1970

FILED

For corners in

LIVINGSTON

(County)

Located in: TYRONE

Corner Code #

9

1999 NOV 22 A 11: 10

NANCY HAVILAND
REGISTER OF DEEDS
LIVINGSTON COUNTY, MI.
48843

ISC# 1136m

Register of Deeds Stamp and File Number

- 1. Public Land Survey T 4N R 6E I-9
T _____ R _____
T _____ R _____
T _____ R _____
- 2. Property Controlling S _____ T _____ R _____
in Section S _____ T _____ R _____
- 3. Miscellaneous S _____ T _____ R _____
Property in Sec. S _____ T _____ R _____
- 4. Lot No. _____, Recorded Plat _____
- 5. Private Claims _____

I, Bryan L. Boss, in a field survey on SEPT. 28, 1999
do hereby certify that under requirements of P.A. 74, Michigan P.A. of 1970, the corner points mentioned in lines 1 and 2 above were in conformance with regulations and rules therefor as required in the current manual of survey instructions of the United States Department of the Interior, Bureau of Land Management or by a decree of a Court of Law and/or that the corner points mentioned in lines 3,4 and 5 above were in conformance with the rules of the Michigan Board of Land Surveyors or by a Decree of a Court of Law; established, re-established, monumented, re-monumented, recovered, found as expressed below.

NOTE: Not more than 4 corners, all in the same town and range, may be recorded on this certificate.

A. Description of original monument and accessories and/or subsequent restoration:

SET POST
16" W. OAK S 57° W 64 LINKS (42.24')
6" W. OAK N 48° W 58 LINKS (38.28')

B. Description of corner evidence found and/or method applied in restoring or reestablishing corner:

FOUND 1/2" IRON ROD WITH SMASHED YELLOW CAP 1 FOOT WEST
OF THE CENTERLINE OF MABLEY HILL ROAD

C. Description of monument for corner and accessories established to perpetuate locating the position of the corner:

SET 1 1/4" X 30" PIPE WITH PLASTIC INSERT
CONNECTED TO A 1 1/4" X 6" PIPE WITH BRASS
CAP STAMPED "LIVINGSTON COUNTY
REMONUMENTATION CORNER"
N34°E 55.79' SET REMON NAIL & TAG NW/S 32"
ASH
S62°E 43.40' SET REMON NAIL & TAG NE/S 20" OAK
DUE WEST 23.79' SET REMON NAIL & TAG N/S 32"
OAK
N26°W 41.06' SET REMON NAIL & TAG NE/S 20"
OAK

	A	B	C	D	E	F	G	H	I	J	K	L	M
2	5	5	4	3	2	1							
3													
4	7	8	9	10	11	12							
5													
6	18	17	16	15	14	13							
7													
8	19	20	21	22	23	24							
9													
10	30	29	28	27	26	25							
11													
12	31	32	33	34	35	36							
13													

P.A. 345 1990, APPROVED BY LIVINGSTON COUNTY

RECORDED ON 6-16-99, CO. REP JED

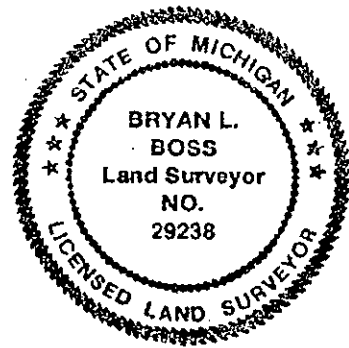

Signed by [Signature] Date NOV. 9, 1999
Surveyor's Michigan License No. 29238