

FEB 24 1998

9-

SECTION

LAND CORNER RECORDATION CERTIFICATE

FILED

Filing Requirement of Act 74, Mich. P.A. 1970

For corners in

LIVINGSTON Located In: TYRONE TWP. Corner Code M-2
(County)

1. Public Land Survey T 4N R 6E M-2
T _____ R _____
T _____ R _____
T _____ R _____

2. Property Controlling S _____ T _____ R _____
in Section S _____ T _____ R _____

3. Miscellaneous S _____ T _____ R _____
Property in Sec. S _____ T _____ R _____

1997 OCT -7 A 10: 56

NANCY HAVILAND
REGISTER OF DEEDS
LIVINGSTON COUNTY, MI.
48843

L.S.C. #709m

Register of Deeds Stamp & File Number

4. Lot No. _____, Recorded Plat _____
5. Private Claims _____

	A	B	C	D	E	F	G	H	I	J	K	L	M
2	6	5	4	3	2	1							
3													
4	7	8	9	10	11	12							
5													
6	18	17	16	15	14	13							
7													
8	19	20	21	22	23	24							
9													
10	30	29	28	27	26	25							
11													
12	31	32	33	34	35	36							
13													

I, BRYAN L. BOSS, in a field survey on MAY 12, 1997, do hereby certify that under requirements of P.A. 74, Michigan P.A. of 1970, the corner points mentioned in lines 1 and 2 above were in conformance with regulations and rules therefore as required in the current manual of survey instructions of the United States Department of the Interior, Bureau of Land Management or by a decree of a Court of Law and/or that the corner points mentioned in lines 3, 4 and 5 above were in conformance with the rules of the Michigan Board of Land Surveyors or by a Decree of a Court of Law; established, re-established, monumented, re-monumented, recovered, found as expressed below:

NOTE: Not more than 4 corners, all in the same town and range, may be recorded on this certificate.

A. Description of original monument and accessories and/or subsequent restoration:

WHITE OAK 36" N 70 E 34 LINKS
WHITE OAK 36" S 83 W 42 LINKS

3. Description of corner evidence found and/or method applied in restoring or reestablishing corner:

FOUND 1/2" INCH IRON AT BASE OF NEW CORNER POST.
FENCE LINES & TREE ROW EAST / WEST AND SOUTH OF CORNER FITS OCCUPATION.

Description of monument for corner and accessories established to perpetuate locating the position of the corner:

SET 1 1/4" X 36" IRON PIPE WITH BRASS CAP STAMPED
"LIVINGSTON CTY. MONUMENTATION CORNER" OVER 1/2" INCH
REROD AT 3-WAY FENCE EAST-WEST & SOUTH.
NORTH 20.24' 1/2 INCH IRON ROD
EAST 6.46' NAIL & TAG NORTH SIDE WOOD FENCE POST
S 36° W 4.93' NAIL & TAG NORTH WEST SIDE 6" HICKORY
WEST 8.48' NAIL & TAG NORTH SIDE 28" HICKORY
SOUTH 191.06 1/2" IRON ROD (WEST 1/4 CORNER SECTION 6, ROSE TWP.)

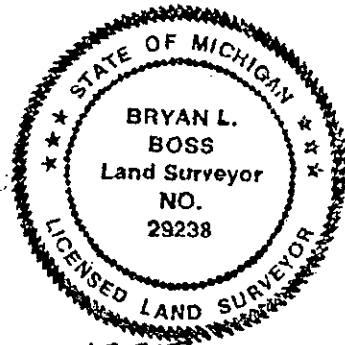

Drawn by Bryan L. Boss Date Sept. 22, 1997
Surveyor's Michigan License No. 29238

FORM APPROVED BY MICHIGAN STATE BOARD OF LAND SURVEYORS, JAN. 28, 1974
REVISED MAY 14, 1975
REVISED JAN., 1993

PA. 345 1990, APPROVED BY LIVINGSTON COUNTY

PEER GROUP ON 5-7-97 CO. REP JED

**SUMMARY
M-2**

East 1/4 Corner, Section 1, Tyrone Township, Livingston County, Michigan.

In 1815, Alex Holmes set posts along this Township Line. The G.L.O. Map records the Southeast Corner of Section 1 to be 188.1 feet North of the Southwest Corner of Section 6, Rose Township, Oakland Township, Oakland County, Michigan. The East 1/4 Corner of Section 1 calculates 94.1 feet. On November 8, 1916, County Surveyor F.A. Slayton records 188 foot jog at the East 1/4 corner with a deeded strip in question of 11 rods Easterly into Rose Township.

On September 7, 1988, Harold R. Phillips set the West 1/4 Corner of Section 6, by single proportionate measurement between the East 1/4 Corner and the Southeast Corner of Section 1. His tie in distance between Corners is recorded as 191.06 feet (See Act 74 on Page 17).

On October 24, 1996, Alpha Land Surveying found East 1/4 Corner, Section 1 and witnesses were set. (Note Rod with Ribbon 20.24 feet North). The same two irons were found by Boss Engineering on March 24, 1997 and logged East 1/4 Corner at corner post of fence occupation East-West and Southerly. Overhanging branches will make a difficult G.P.S. Station.

The 1/2 Iron Rod found appears to be at the same 1916 Slayton location and is at the location of the Harold Phillips 1988 survey.

Area is in hedge row and not open for G.P.S. May-October.

We recommend accepting existing corner as used.

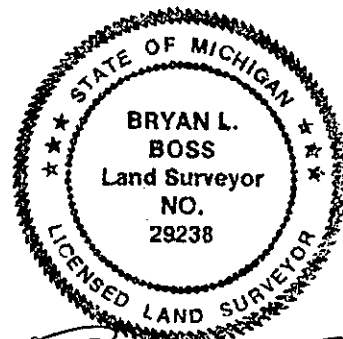

Bryan L. Boss

File: Summt-2