

**SURVEY & REMONUMENTATION**

FEB 24 1998

SECTION

**LAND CORNER RECORDATION CERTIFICATE**  
Filing Requirement of Act 74, Mich. P.A. 1970

FILED 9-

For corners in

LIVINGSTON  
(County)

Located In:

Corner Code ##

TYRONE TWP.

1997 OCT -7 A 10: 56

NANCY HAVILAND  
REGISTER OF DEEDS  
LIVINGSTON COUNTY, MI.  
48843

- |                                    |                         |            |
|------------------------------------|-------------------------|------------|
| 1. Public Land Survey              | T <u>4N</u> R <u>6E</u> | <u>M-7</u> |
|                                    | T _____ R _____         | _____      |
|                                    | T _____ R _____         | _____      |
|                                    | T _____ R _____         | _____      |
| 2. Property Controlling in Section | S _____ T _____ R _____ | _____      |
|                                    | S _____ T _____ R _____ | _____      |
| 3. Miscellaneous Property in Sec.  | S _____ T _____ R _____ | _____      |
|                                    | S _____ T _____ R _____ | _____      |

L.S.C.#714m

Register of Deeds Stamp & File Number

4. Lot No. \_\_\_\_\_, Recorded Plat \_\_\_\_\_
5. Private Claims \_\_\_\_\_

	A	B	C	D	E	F	G	H	I	J	K	L	M
2	6	5	4	3	2	1							
3													
4	7	8	9	10	11	12							
5													
6	18	17	16	15	14	13							
7													
8	19	20	21	22	23	24							
9													
10	30	29	28	27	26	25							
11													
12	31	32	33	34	35	36							
13													

I, BRYAN L. BOSS, in a field survey on SEPTEMBER 19, 19 97, do hereby certify that under requirements of P.A. 74, Michigan P.A. of 1970, the corner points mentioned in lines 1 and 2 above were in conformance with regulations and rules therefore as required in the current manual of survey instructions of the United States Department of the Interior, Bureau of Land Management or by a decree of a Court of Law and/or that the corner points mentioned in lines 3, 4 and 5 above were in conformance with the rules of the Michigan Board of Land Surveyors or by a Decree of a Court of Law; established, re-established, monumented, re-monumented, recovered, found as expressed below:

NOTE: Not more than 4 corners, all in the same town and range, may be recorded on this certificate.

A. Description of original monument and accessories and/or subsequent restoration:

BLACK OAK 6" N 13 E 29 LINKS  
WHITE OAK 16" N 69 W 11 LINKS

B. Description of corner evidence found and/or method applied in restoring or reestablishing corner:

FOUND 3/4" INCH PIPE AT SURFACE OF GRAVEL ROAD. PIPE WAS STRAIGHTENED AND RESET 1/2 FOOT DEEP. AFTER ACCEPTANCE BY PEER GROUP, A 1 1/4" X 30" PIPE WAS SET ONE FOOT BELOW SURFACE WITH A 6" INCH BREAKAWAY AND BRASS CAP STAMPED "LIVINGSTON COUNTY MONUMENTATION CORNER".

C. Description of monument for corner and accessories established to perpetuate locating the position of the corner:

SEE "B" ABOVE.  
N 40 E 34.87' NAIL & TAG NORTHWEST SIDE 16" OAK  
S 85 W 18.70' NAIL & TAG SOUTH SIDE 36" OAK  
N 88 W 32.94' CENTER OF STEEL FENCE CORNER POST  
N 45 W 24.99' NAIL & TAG NORTHEAST SIDE 10" HICKORY  
SOUTH 116.34' IRON PIPE NORTHWEST CORNER, SECTION 19, ROSE TWP. (A-7)

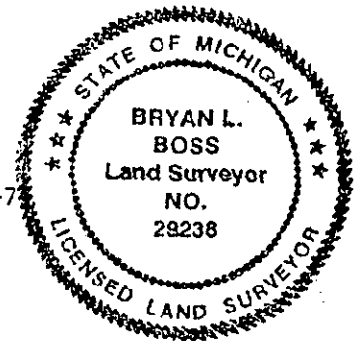

Signed by [Signature] Date Sept. 22, 1997  
Surveyor's Michigan License No. 29238

**SUMMARY  
M-7**

Northeast Corner, Section 24, Tyrone Township, Livingston County, Michigan.

Corner set in 1815 by Alex Holmes. The G.L.O. Map records 115.5 feet at Township jog. The August 5, 1969 survey by Munsell & Garlock records iron pipe found and witnesses logged (no previous surveys or witnesses to establish creation of this iron were found).

On June 19, 1987, Delta Land Surveying found 3/4 inch pipe and recorded 116.43 foot jog to A-7.

**WITNESSES**

On August 1, 1988, Griffels - Webster found iron pipe and two witnesses checked Charles Garlock September 27, 1968 witnesses.

Garlock survey of September 27, 1968 found 3/4" pipe. Richard F. Frank and James H. Miller also found 3/4 inch iron pipes in 1992 and 1993. Witnesses verified and checked by Boss on December 27, 1996, and found 3/4 inch pipe at surface of gravel road. The pipe was straightened and reset 1/2 foot deep.

**DISTANCES**

Distances North and South check with all previous surveys.

The area is open for G.P.S.

We recommend acceptance of 3/4" Pipe as found.

**GARLOCK**

S 80° W 18.4 Feet Center 34" White Oak  
N 45° E 35.1 Feet Center 14" Red Oak  
N 45° W 24.75 Feet 6" Hickory

**BOSS ENGINEERING**

S 85° W 18.70 Feet 36" Oak  
N 40° E 34.83 Feet 16" Oak  
N 45° W 24.99 Feet 10" Hickory

File: Summ-7

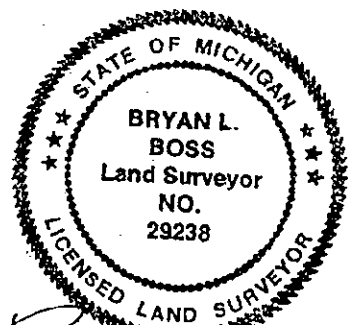

*Bryan L. Boss*